



The Timken Company

4500 Mt Pleasant St. NW

N. Canton, OH 44720

Phone: (234) 262-3000

E-Mail: CustomerCAD@timken.com • **Web site:** www.timken.com

Bearing Unit - Adapter Sleeve UKFL207 - H2307, UKFL 200 Two-Bolt Flanged Mounted Bearings- Adapter Sleeve Locking

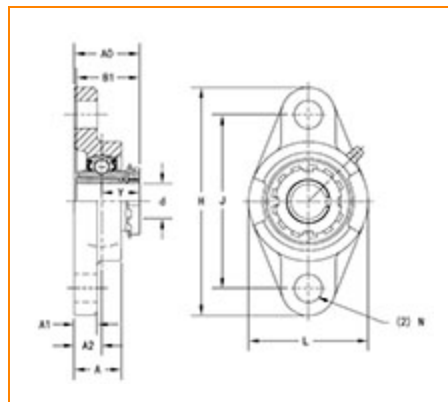

[Specifications](#) | [Dimensions](#) | [Basic Load Ratings](#)

Specifications

Bearing Unit - Adapter Sleeve	UK207 - H2307
Shaft Size d	30 mm
Adapter Sleeve Number¹	H2307
Locking Style	Adapter Sleeve Locking
Housing Construction	Two-Bolt Flange

Dimensions

Total Length H	161 mm 6.339 in
Total Height L	90 mm 3.543 in



Housing Width A	34 mm 1.339 in
Bolt Hole Spacing J	130 mm 5.118 in
Bolt Hole Size N	16 mm 0.63 in
Flange Thickness A1	14 mm 0.551 in
Center of Bearing from Housing End A2	19 mm 0.748 in
Center of Bearing from Bearing End Y	24 mm 0.945 in
Dimension B1	43 mm 1.693 in
Dimension A0	43 mm 1.688 in
Bolt Size	M14

Basic Load Ratings

Static Load Rating	15400 N 3462 lbf
Dynamic Load Rating	25700 N 5778 lbf

¹ Purchase the Adapter Sleeve separately

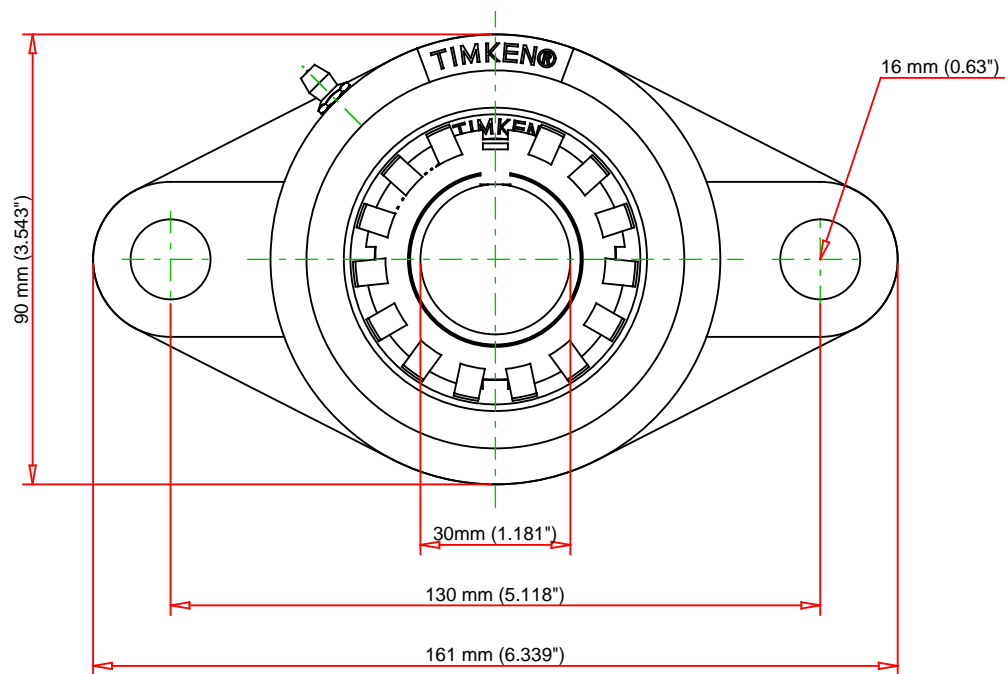
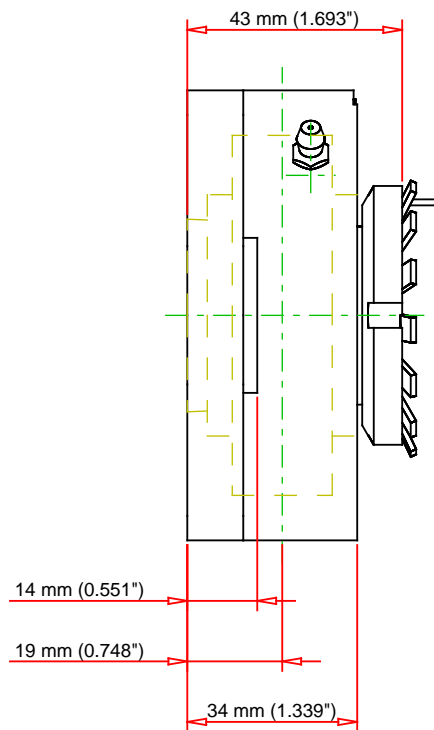

Note: Adapter sold separately

Bearing Number	UK207 - H2307			
Load Ratings - C _r	5778	lbf	25700	N
Load Ratings - C _{0r}	3462	lbf	15400	N
Weight	2.9	lb	1.3	kg

TIMKEN

THE TIMKEN COMPANY
NORTH CANTON, OHIO USA

UKFL207 - H2307
UKFL 200 Two-Bolt Flanged Mounted
Bearings- Adapter Sleeve Locking

Every reasonable effort has been made to ensure the accuracy of the information contained in this writing, but no liability is accepted for errors, omissions or for any other reason.

FOR DISCUSSION ONLY