



**The Timken Company**

4500 Mt Pleasant St. NW

N. Canton, OH 44720

**Phone:** (234) 262-3000

**E-Mail:** [CustomerCAD@timken.com](mailto:CustomerCAD@timken.com) • **Web site:** [www.timken.com](http://www.timken.com)

## Part Number UCF306, UCF 300 Four-Bolt Flanged Mounted Bearings - Set Screw Locking

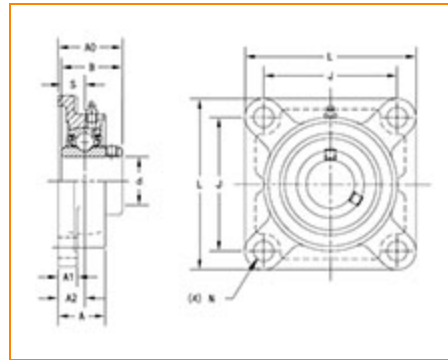

[Specifications](#) | [Dimensions](#) | [Basic Load Ratings](#)

### Specifications

<b>Bearing Number</b>	UC306
<b>Shaft Size d</b>	30 mm
<b>Locking Style</b>	Set Screw Locking
<b>Housing Construction</b>	Four-Bolt Square Flange

### Dimensions

<b>Total Length L</b>	125 mm 4.921 in
<b>Housing Width A</b>	32 mm 1.26 in
<b>Bolt Hole Spacing J</b>	95 mm 3.74 in



<b>Bolt Hole Size N</b>	16 mm 0.63 in
<b>Flange Thickness A1</b>	15 mm 0.591 in
<b>Center of Bearing from Housing End A2</b>	18 mm 0.709 in
<b>Inner Ring Width B</b>	43 mm 1.693 in
<b>Center of Bearing from Bearing End S</b>	17 mm 0.669 in
<b>Dimension A0</b>	44 mm 1.734 in
<b>Bolt Size</b>	M14
<b>Grease Nipple Size</b>	A 1/4-28UNF

## Basic Load Ratings

<b>Static Load Rating</b>	15000 N 3372 lbf
<b>Dynamic Load Rating</b>	26700 N 6002 lbf

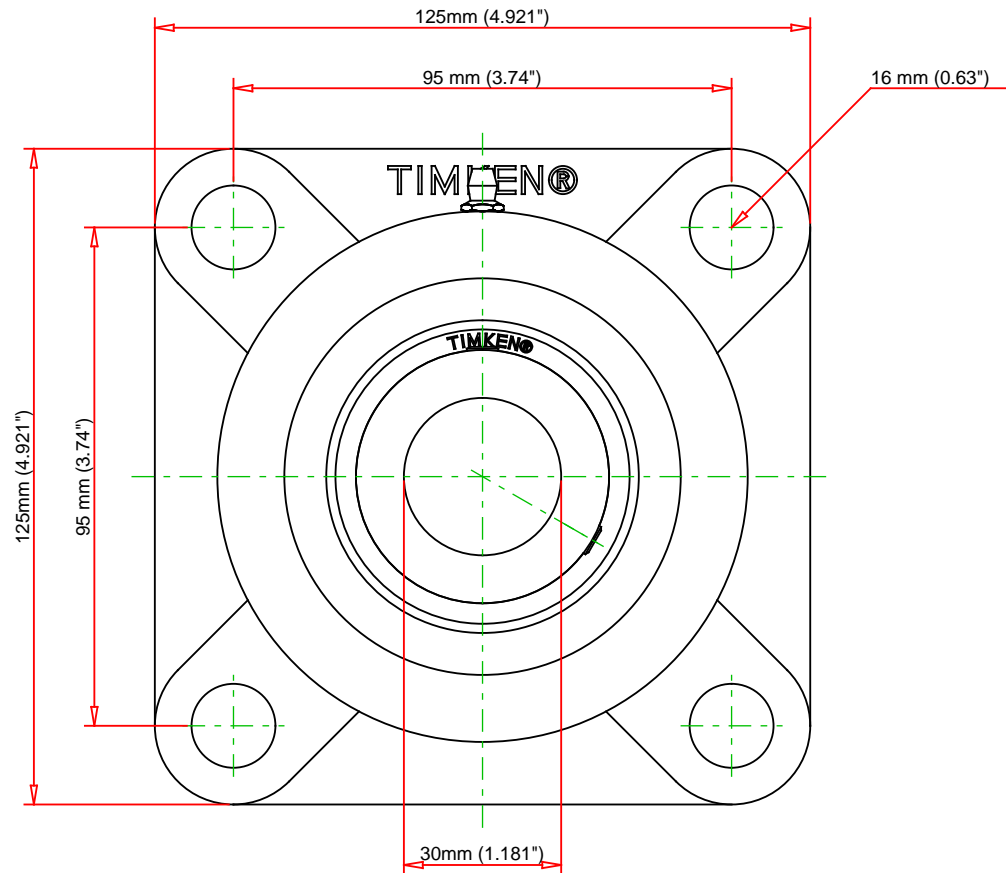
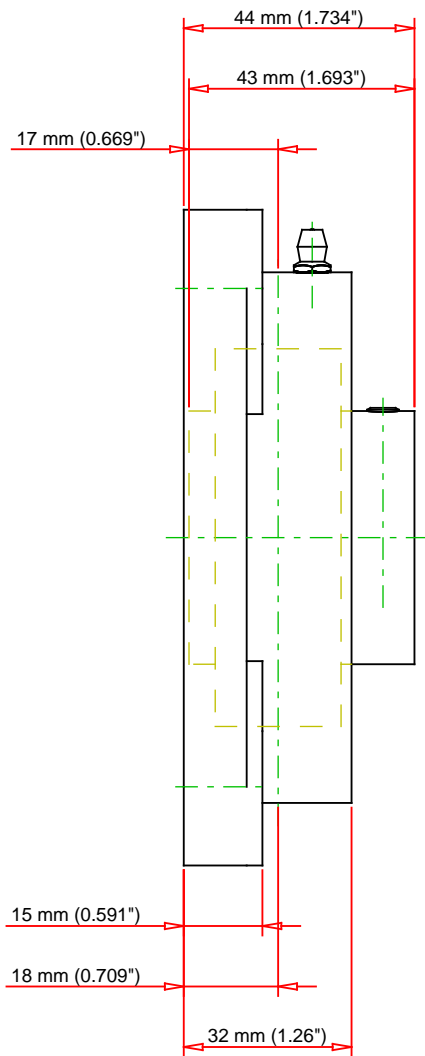

Bearing Number	UC306			
Load Ratings - C <sub>r</sub>	6002	lbf	26700	N
Load Ratings - C <sub>0r</sub>	3372	lbf	15000	N
Weight	4.2	lb	1.9	kg
Bolt Size	M14			

**TIMKEN®**

THE TIMKEN COMPANY  
NORTH CANTON, OHIO USA

**UCF306**  
UCF 300 Four-Bolt Flanged Mounted  
Bearings - Set Screw Locking

Every reasonable effort has been made to ensure the accuracy of the information contained in this writing, but no liability is accepted for errors, omissions or for any other reason.

**FOR DISCUSSION ONLY**