

Manifold Options

■ For body ported Blanking plate assembly

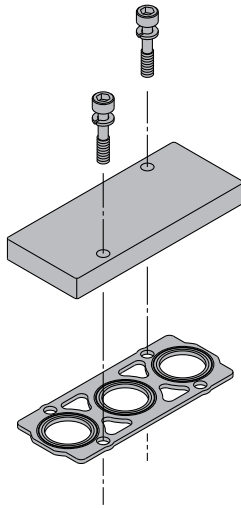

Series	Blanking plate assembly part no.
VF1000	DXT144-13-3A
VF3000	DXT031-38-5A
VF5000	VF5000-70-1A

■ Individual EXH spacer assembly

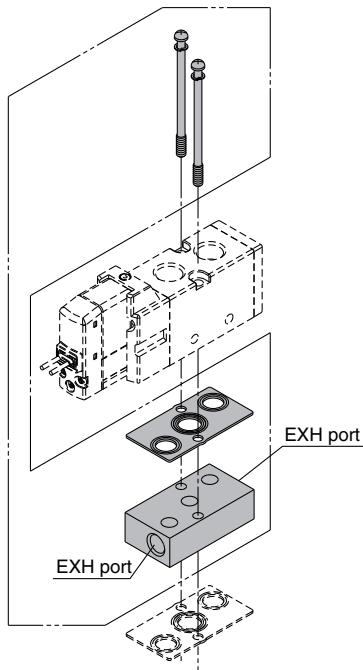

■ Mounting screw, gasket part no.

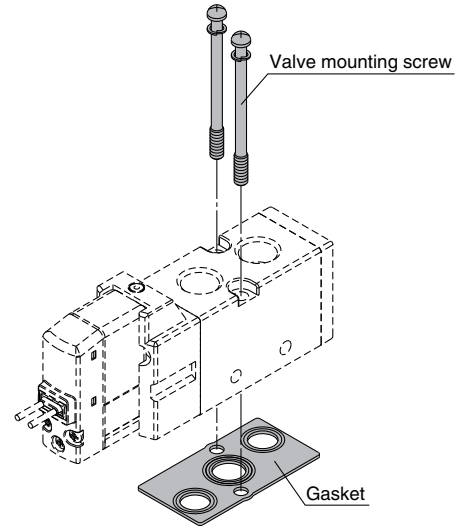

Series	Valve mounting screw (1 pc.)	Gasket
VF1000	Round head combination screw DXT031-44-1	DXT144-12-2
VF3000	(M4 x 39.5, With spring washer)	DXT155-25-7
VF5000	Hexagon socket head cap screw AXT620-32-1 (M4 x 48, With spring washer)	DXT156-9-6

⚠ Caution

Tightening Torque for Mounting Screw

M4: 1.03 lbf·ft (1.4 N·m)

⚠ Warning

When mounting a valve or spacer on the manifold base or sub-plate, etc., the mounting orientation is already decided. If mounted in a wrong direction, the equipment to be connected may result in a malfunction. Refer to the dimensions for mounting.

VF 3 000-75-1 A

• Series

Symbol	Series	Port size
3	VF3000	1/8
5	VF5000	1/4

• Thread type

Nil	Rc
F	G
N	NPT
T	NPTF