



The Timken Company

4500 Mt Pleasant St. NW

N. Canton, OH 44720

Phone: (234) 262-3000

E-Mail: CustomerCAD@timken.com • **Web site:** www.timken.com

Part Number UCF305, UCF 300 Four-Bolt Flanged Mounted Bearings - Set Screw Locking

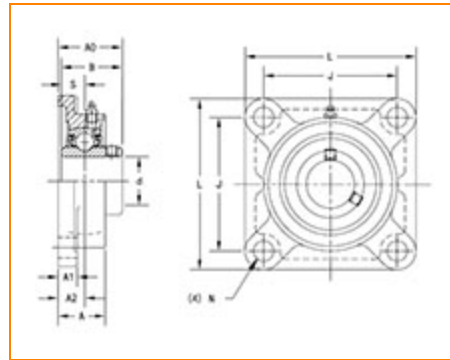

[Specifications](#) | [Dimensions](#) | [Basic Load Ratings](#)

Specifications

Bearing Number	UC305
Shaft Size d	25 mm
Locking Style	Set Screw Locking
Housing Construction	Four-Bolt Square Flange

Dimensions

Total Length L	110 mm 4.331 in
Housing Width A	29 mm 1.142 in
Bolt Hole Spacing J	80 mm 3.15 in



Bolt Hole Size N	16 mm 0.63 in
Flange Thickness A1	13 mm 0.512 in
Center of Bearing from Housing End A2	16 mm 0.63 in
Inner Ring Width B	38 mm 1.496 in
Center of Bearing from Bearing End S	15 mm 0.591 in
Dimension A0	39 mm 1.531 in
Bolt Size	M14
Grease Nipple Size	A 1/4-28UNF

Basic Load Ratings

Static Load Rating	10900 N 2450 lbf
Dynamic Load Rating	21200 N 4766 lbf

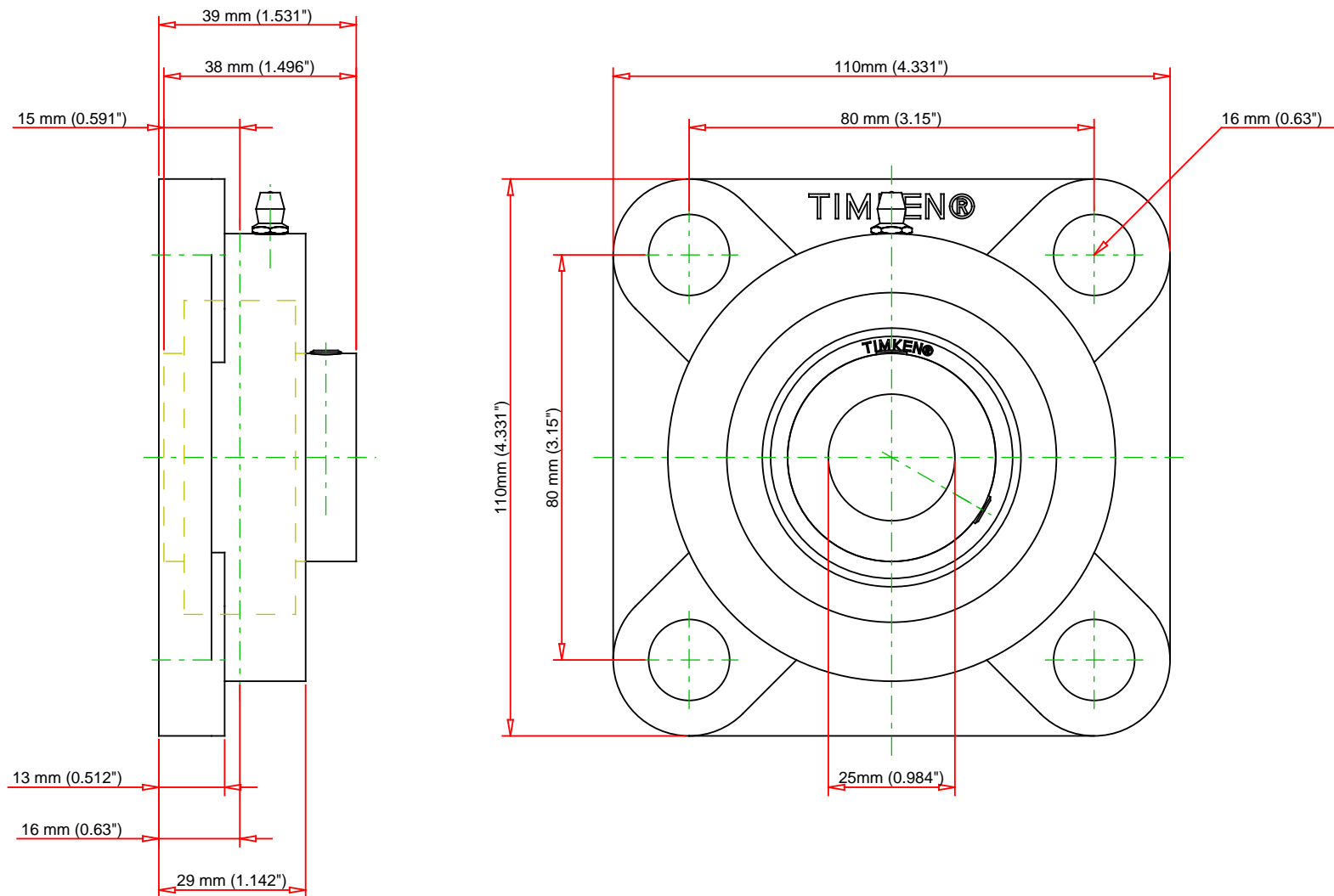

Bearing Number	UC305			
Load Ratings - C _r	4766	lbf	21200	N
Load Ratings - C _{0r}	2450	lbf	10900	N
Weight	2.9	lb	1.3	kg
Bolt Size	M14			

TIMKEN®

THE TIMKEN COMPANY
NORTH CANTON, OHIO USA

UCF305

UCF 300 Four-Bolt Flanged Mounted
Bearings - Set Screw Locking

Every reasonable effort has been made to ensure the accuracy of the information contained in this writing, but no liability is accepted for errors, omissions or for any other reason.

FOR DISCUSSION ONLY