



FAG

SES211-L

Plummer block housing

Schaeffler ID:
0856673900000

Split plummer block housing for various bearing designs. The SNV series will be replaced by the new SES series in 2022.

Technical information

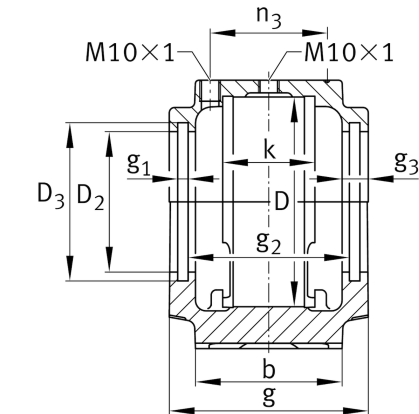
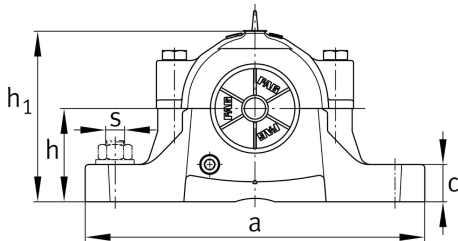
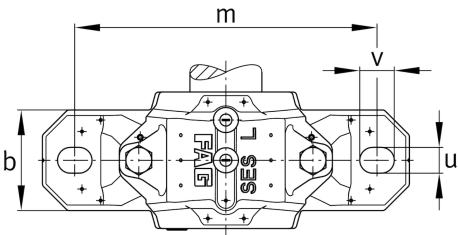

Main Dimensions & Performance Data

D	100 mm	outside diameter bearing
a	255 mm	length base
h ₁	128 mm	height
g	95 mm	width housing body
K	44 mm	Width bearing seat
	4.18 kg	Weight

Dimensions

b	70 mm	width base
c	28 mm	height base
h	70 mm	center height
m	210 mm	distance fixing bore
s	0.625	screw size
s	M16	size of fixing screws
u	18 mm	width slot
v	24 mm	length slot
D ₂	77 mm	diameter sealing
D ₃	85.5 mm	diameter sealing groove
D ₅	83.2 mm	Outside diameter sealing labyrinth
g ₁	5 mm	Width sealing groove
g ₂	77 mm	Distance sealing
g ₃	12 mm	Wall thickness
g ₄	34 mm	Distance oil lubrication
m ₁	174 mm	Distance holes aligned pins m1
n ₃	56 mm	Distance lubrication
n ₄	81 mm	Distance lubrication sealing
u ₁	6 mm	bore diameter u1
u ₂	14 mm	bore diameter u2