



GIKSR8-PS

Rod end

Schaeffler ID:
0588999280000

Corrosion-resistant rod end, with internal thread, right hand thread; maintenance-free, sliding layer: PTFE film; DIN ISO 12240-4; dimension series K, type F; open design

Technical information

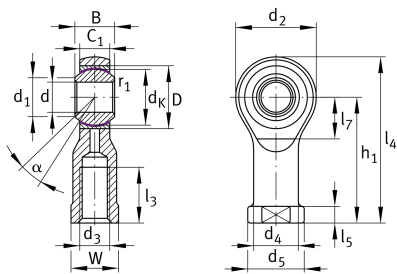

Main Dimensions & Performance Data

d	8 mm	Bore diameter bearing
D	19 mm	Outside diameter bearing
B	12 mm	Width inner ring
C _r	12,900 N	Basic dynamic load rating, radial
C _{0r}	5,700 N	Basic static load rating, radial
	47.59 g	Weight

Dimensions

d _K	15.8 mm	Ball diameter
d ₁	10.4 mm	Outer flange diameter inner ring
d ₂	25 mm	Outer eye diameter
d ₃	M8	Thread size
d ₄	12.5 mm	Shank diameter
h ₁	36 mm	Shank Length Internal thread head
C ₁	9 mm	Width of the rod end
α	13 °	Tilt angle
l ₃	12 mm	Thread length Internal thread
l ₄	48.5 mm	Total length internal thread head
l ₅	5 mm	length rod end shank
l ₇	12 mm	Distance drilling with/shaft start
d ₅	16 mm	Shank diameter, large
W	14 mm	Width Across Flat
G _r	0,005 - 0,040 mm	Radial Clearance
d _{OT}	0.015 mm	Bore diameter bearing, upper tolerance
d _T	H7 mm	Bore diameter bearing, tolerance
B _{OT}	0.012 mm	Width inner ring, upper tolerance

Mounting dimensions

r _{1smin}	0.3 mm	Edge Spacing
--------------------	--------	--------------

Temperature range

T _{min}	-10 °C	Operating temperature min.
T _{max}	80 °C	Operating temperature max.