



**The Timken Company**

4500 Mt Pleasant St. NW

N. Canton, OH 44720

**Phone:** (234) 262-3000

**E-Mail:** [CustomerCAD@timken.com](mailto:CustomerCAD@timken.com) • **Web site:** [www.timken.com](http://www.timken.com)

## Bearing Unit - Adapter Sleeve UKFL205 - H2305, UKFL 200 Two-Bolt Flanged Mounted Bearings- Adapter Sleeve Locking

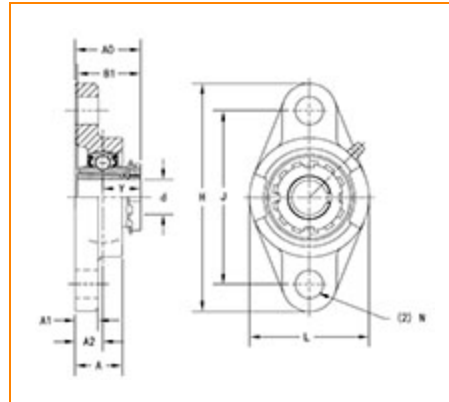

[Specifications](#) | [Dimensions](#) | [Basic Load Ratings](#)

### Specifications

<b>Bearing Unit - Adapter Sleeve</b>	UK205 - H2305
<b>Shaft Size d</b>	20 mm
<b>Adapter Sleeve Number<sup>1</sup></b>	H2305
<b>Locking Style</b>	Adapter Sleeve Locking
<b>Housing Construction</b>	Two-Bolt Flange

### Dimensions

<b>Total Length H</b>	130 mm 5.118 in
<b>Total Height L</b>	68 mm 2.677 in



<b>Housing Width A</b>	27 mm 1.063 in
<b>Bolt Hole Spacing J</b>	99 mm 3.898 in
<b>Bolt Hole Size N</b>	16 mm 0.63 in
<b>Flange Thickness A1</b>	13 mm 0.512 in
<b>Center of Bearing from Housing End A2</b>	16 mm 0.63 in
<b>Center of Bearing from Bearing End Y</b>	20 mm 0.787 in
<b>Dimension B1</b>	35 mm 1.3780 in
<b>Dimension A0</b>	36 mm 1.406 in
<b>Bolt Size</b>	M14

## Basic Load Ratings

<b>Static Load Rating</b>	7900 N 1765 lbf
<b>Dynamic Load Rating</b>	14000 N 3147 lbf

<sup>1</sup> Purchase the Adapter Sleeve separately

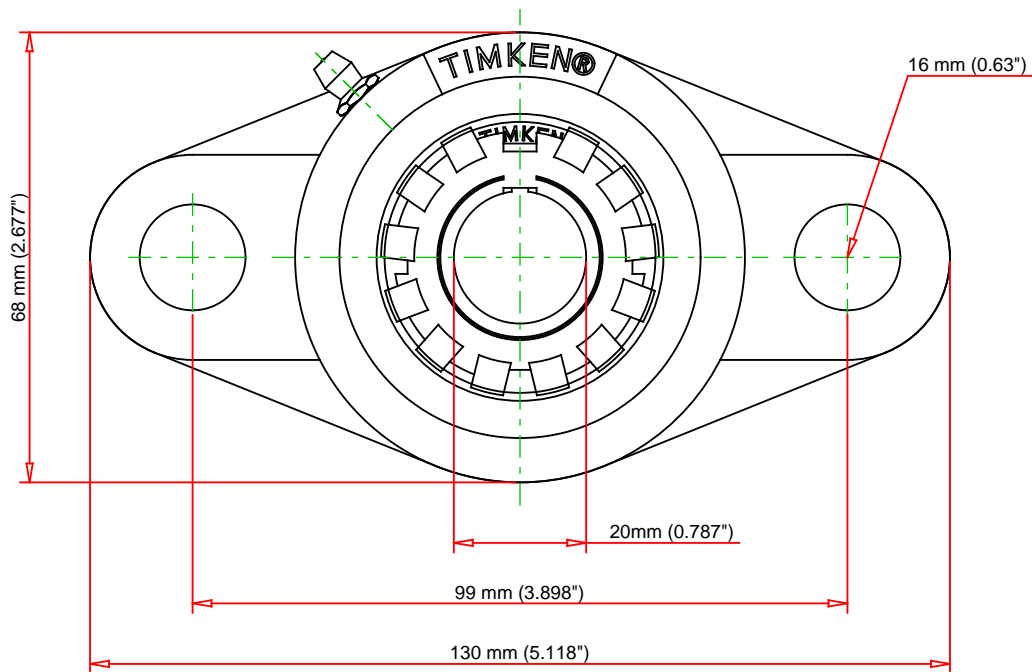
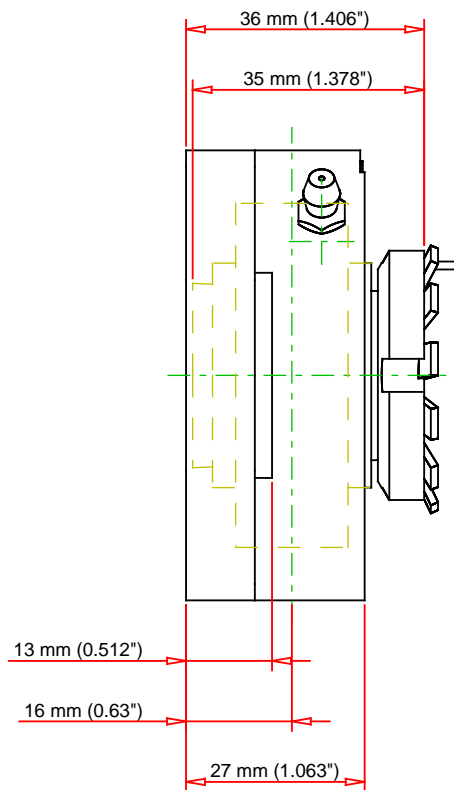

Note: Adapter sold separately

Bearing Number	UK205 - H2305			
Load Ratings - C <sub>r</sub>	3147	lbf	14000	N
Load Ratings - C <sub>0r</sub>	1765	lbf	7900	N
Weight	1.5	lb	0.7	kg

TIMKEN®

THE TIMKEN COMPANY  
NORTH CANTON, OHIO USA

UKFL205 - H2305  
UKFL 200 Two-Bolt Flanged Mounted  
Bearings- Adapter Sleeve Locking

Every reasonable effort has been made to ensure the accuracy of the information contained in this writing, but no liability is accepted for errors, omissions or for any other reason.

FOR DISCUSSION ONLY