

Series RS2H

Construction

Double acting (DL, DM)

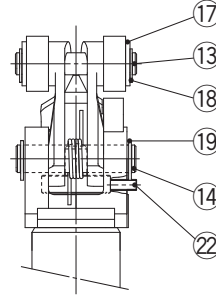
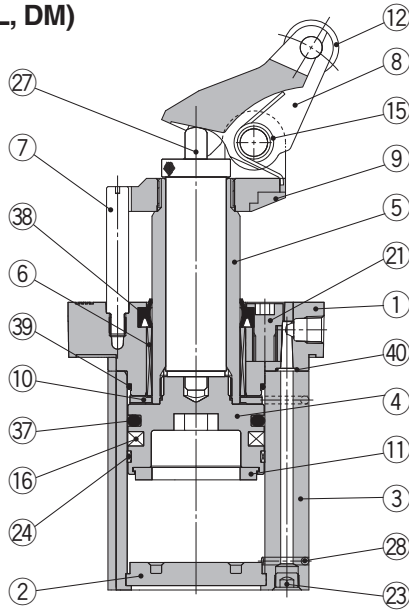

Double acting spring type
(BL, BM)

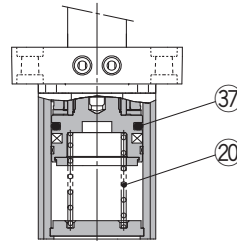

Single acting
(TL, TM)

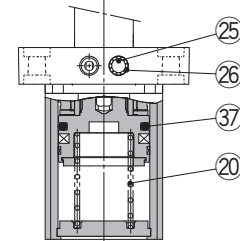

Options (With lock mechanism and cancel cap)

With lock mechanism (-D)

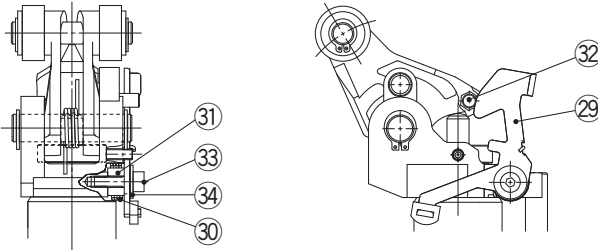

When cancel cap is used (-C)

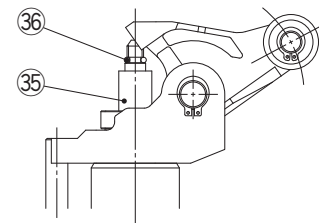

Component Parts (Single acting)

No.	Description	Material	Note
1	Rod cover	Aluminum alloy	Metallic painted
2	Bottom plate	Aluminum alloy	Hard anodized
3	Cylinder tube	Aluminum alloy	Hard anodized
4	Piston	Aluminum alloy	Chromated
5	Piston rod	Carbon steel	Hard chrome plated
6	Bushing	Resin/Copper alloy (Multiple layers)	
7	Guide rod	Carbon Steel	Hard chrome plated
8	Lever	Cast iron	Zinc chromated
9	Lever holder	Cast iron	Zinc chromated
10	Bumper A	Urethane	
11	Bumper B	Urethane	
12	Roller	Resin	-□□L
		Carbon steel	-□□M
13	Roller pin	Carbon steel	
14	Lever pin	Carbon steel	
15	Lever spring	Steel wire	
16	Magnet	—	
17	Flat washer	Steel wire	Zinc chromated
18	Type C retaining ring for shaft	Carbon tool steel	
19	Type C retaining ring for shaft	Carbon tool steel	
20	Return spring	Steel wire	-T□/B□
21	Hexagon socket head cap screw	Chrome molybdenum steel	Zinc chromated
22	Hexagon socket head set screw	Chrome molybdenum steel	Zinc chromated
23	Hexagon socket head plug	Carbon steel	Zinc chromated
24	Wear ring	Resin	
25	Element	Bronze	-□TL/-□TM
26	Retaining ring	Carbon tool steel	-□TL/-□TM
27	Shock absorber	—	
28	Steel ball	Carbon steel	
29	Bracket assembly	Carbon steel	Used for -D (Lock type)

Component Parts (Single acting)

No.	Description	Material	Note
30	Bracket spring	Steel wire	Used for -D (Lock type)
31	Bracket spacer	Carbon steel	Used for -D (Lock type)
32	Lock pin	Carbon steel	Used for -D (Lock type)
33	Hexagon socket head cap screw	Chrome molybdenum steel	Used for -D (Lock type)
34	Flat washer	Carbon steel	Used for -D (Lock type)
35	Cancel cap	Aluminum alloy	Used for -C (Cancel cap type)
36	O-ring	NBR	Used for -C (Cancel cap type)
37	Piston seal	NBR	
38	Rod seal	NBR	
39	Tube gasket	NBR	
40	O-ring	NBR	

Replacement Parts/Seal Kit

Bore size (mm)	Kit no.			Contents
	Double acting	Double acting spring type	Single acting	
50	RS2H50D-PS	RS2H50T-PS		Set of nos. above 37 to 40 (excluding 38)
63	RS2H63D-PS	RS2H63T-PS		
80	RS2H80D-PS	RS2H80T-PS		

*Seal kit includes 37 to 40 (excluding 38).

Order the seal kit based on each bore size.

*Since the seal kit does not include a grease pack, order it separately.

Grease pack part no.: GR-S-010 (10 g)

Replacement Parts/Shock Absorber

Bore size (mm)	Order no.
50	RS2H-R50
63	RS2H-R63
80	RS2H-R80