

## FM EO2-Functional nut

for stainless steel tubes

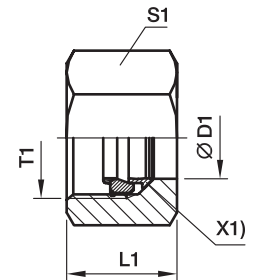

X1) Retaining ring

Series	D1 	T1	L1	S1	Order code								Weight g/1 piece	
					FM...71 Stainless Steel		FM...NBR71 Stainless Steel		FM...SSA Steel + Sealing Retaining ring: Stainless Steel		FM...VITSSA Steel + Sealing Retaining ring: Stainless Steel			
					Sealing FKM	PN (bar)	Sealing NBR	PN (bar)	Sealing NBR	PN (bar)	Sealing FKM	PN (bar)		
LL	04	M 08×1.0	11.0	10	—	—	—	—	<b>FM04LLSSA</b>	100	—	—	5	
	06	M 10×1.0	11.5	12	—	—	—	—	<b>FM06LLSSA</b>	100	—	—	6	
L	06	M 12×1.5	14.5	14	<b>FM06L71</b>	315	<b>FM06LNBR71</b>	315	<b>FM06LSSA</b>	315	<b>FM06LVITSSA</b>	315	12	
	08	M 14×1.5	14.5	17	<b>FM08L71</b>	315	<b>FM08LNBR71</b>	315	<b>FM08LSSA</b>	315	<b>FM08LVITSSA</b>	315	17	
	10	M 16×1.5	15.5	19	<b>FM10L71</b>	315	<b>FM10LNBR71</b>	315	<b>FM10LSSA</b>	315	<b>FM10LVITSSA</b>	315	22	
	12	M 18×1.5	15.5	22	<b>FM12L71</b>	315	<b>FM12LNBR71</b>	315	<b>FM12LSSA</b>	315	<b>FM12LVITSSA</b>	315	30	
	15	M 22×1.5	17.0	27	<b>FM15L71</b>	315	<b>FM15LNBR71</b>	315	<b>FM15LSSA</b>	315	<b>FM15LVITSSA</b>	315	48	
	18	M 26×1.5	18.0	32	<b>FM18L71</b>	315	<b>FM18LNBR71</b>	315	<b>FM18LSSA</b>	315	<b>FM18LVITSSA</b>	315	70	
	22	M 30×2.0	20.0	36	<b>FM22L71</b>	160	<b>FM22LNBR71</b>	160	<b>FM22LSSA</b>	160	<b>FM22LVITSSA</b>	160	94	
	28	M 36×2.0	21.0	41	<b>FM28L71</b>	160	<b>FM28LNBR71</b>	160	<b>FM28LSSA</b>	160	<b>FM28LVITSSA</b>	160	106	
	35	M 45×2.0	24.0	50	<b>FM35L71</b>	160	<b>FM35LNBR71</b>	160	<b>FM35LSSA</b>	160	<b>FM35LVITSSA</b>	160	160	
	42	M 52×2.0	24.0	60	<b>FM42L71</b>	160	<b>FM42LNBR71</b>	160	<b>FM42LSSA</b>	160	<b>FM42LVITSSA</b>	160	244	
	S	06	M 14×1.5	16.5	17	<b>FM06S71</b>	630	<b>FM06SNBR71</b>	630	<b>FM06SSSA</b>	630	<b>FM06SVITSSA</b>	630	20
		08	M 16×1.5	16.5	19	<b>FM08S71</b>	630	<b>FM08SNBR71</b>	630	<b>FM08SSSA</b>	630	<b>FM08SVITSSA</b>	630	23
10		M 18×1.5	17.5	22	<b>FM10S71</b>	630	<b>FM10SNBR71</b>	630	<b>FM10SSSA</b>	630	<b>FM10SVITSSA</b>	630	37	
12		M 20×1.5	17.5	24	<b>FM12S71</b>	630	<b>FM12SNBR71</b>	630	<b>FM12SSSA</b>	630	<b>FM12SVITSSA</b>	630	39	
16		M 24×1.5	20.5	30	<b>FM16S71</b>	400	<b>FM16SNBR71</b>	400	<b>FM16SSSA</b>	400	<b>FM16SVITSSA</b>	400	72	
20		M 30×2.0	24.0	36	<b>FM20S71</b>	400	<b>FM20SNBR71</b>	400	<b>FM20SSSA</b>	400	<b>FM20SVITSSA</b>	400	121	
25		M 36×2.0	27.0	46	<b>FM25S71</b>	400	<b>FM25SNBR71</b>	400	<b>FM25SSSA</b>	400	<b>FM25SVITSSA</b>	400	221	
30		M 42×2.0	29.0	50	<b>FM30S71</b>	400	<b>FM30SNBR71</b>	400	<b>FM30SSSA</b>	400	<b>FM30SVITSSA</b>	400	248	
38		M 52×2.0	32.5	60	<b>FM38S71</b>	315	<b>FM38SNBR71</b>	315	<b>FM38SSSA</b>	315	<b>FM38SVITSSA</b>	315	367	

$$\frac{\text{PN (bar)}}{10} = \text{PN (MPa)}$$