



The Timken Company

4500 Mt Pleasant St. NW

N. Canton, OH 44720

Phone: (234) 262-3000

E-Mail: CustomerCAD@timken.com • **Web site:** www.timken.com

Bearing Unit - Adapter Sleeve UKFC218 - H2318, UKFC 200 Piloted Round Flanged Mounted Bearings - Adapter Sleeve Locking

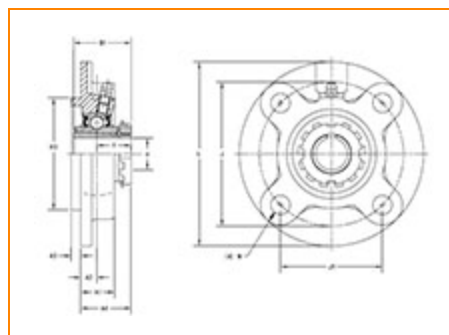

[Specifications](#) | [Dimensions](#) | [Basic Load Ratings](#)

Specifications

Bearing Unit - Adapter Sleeve	UK218 - H2318
Shaft Size d	80 mm
Adapter Sleeve Number¹	H2318
Locking Style	Adapter Sleeve Locking
Housing Construction	Round Flange

Dimensions

Total Height L	265 mm 10.433 in
-----------------------	---------------------



Pilot Outside Diameter H3 190 mm

Bolt Circle Diameter J 220 mm
8.661 in

Bolt Hole Spacing J1 155.5 mm
6.122 in

Bolt Hole Size N 23 mm
0.906 in

Flange Width A1 50 mm
1.969 in

Center of Bearing from Housing End A2 22 mm
0.866 in

Pilot Width A3 18 mm

Center of Bearing from Bearing End Y 49.5 mm
1.949 in

Dimension A4 71.5 mm
2.813 in

Dimension B1 86 mm
3.386 in

Basic Load Ratings

Static Load Rating 71500 N
16074 lbf

Dynamic Load Rating 96100 N
21604 lbf

¹ Purchase the Adapter Sleeve separately

