

KWVE30-B-SN-V1-G3

Recirculating ball bearing carriage

Schaeffler ID:
0199810070240

Carriages KWVE...-B-SN, narrow, low carriage, four-row

Technical information

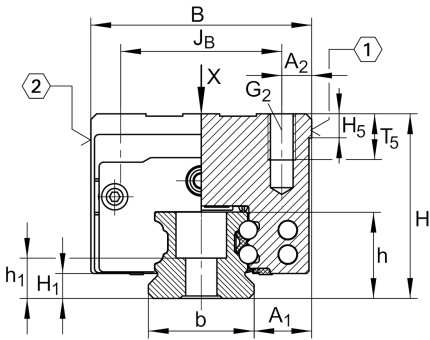

Main Dimensions & Performance Data

H	38 mm	height system
B	60 mm	width carriage
L	99 mm	overall length carriage
C	27,500 N	dynamic load rating
C ₀	55,000 N	dynamic load rating
M _{0x}	970 Nm	static moment rating about X axis
M _{0y}	700 Nm	static moment rating about Y axis
M _{0z}	700 Nm	static moment rating about Z axis
	0.85 kg	Weight

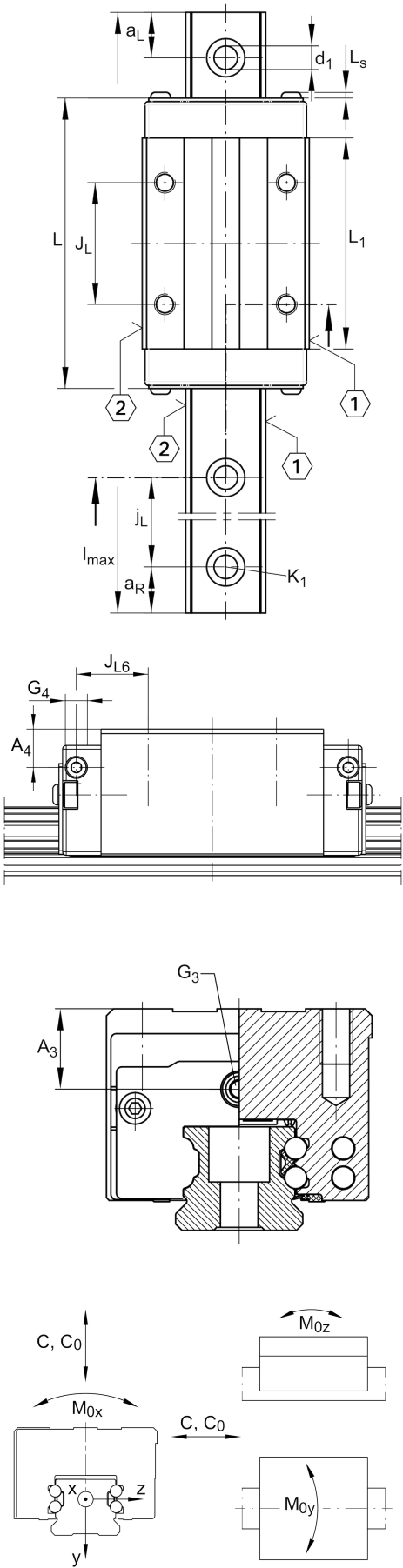

Mounting dimensions

A_1	16 mm	
J_B	40 mm	
b	28 mm	width rail
A_2	10 mm	
L_1	72 mm	
L_s	1.65 mm	
J_L	40 mm	
H_1	5.9 mm	
H_5	6.25 mm	
T_5	11 mm	
G_2	M8	fixing screws below (DIN ISO 4762-12.9)
$G_2 M_A$	41 Nm	maximum tightening torque
A_3	7.5 mm	position lubrication connector
G_3	M6	lubrication connector
$t G_3$	7 mm	maximum permissible screw depth for lubrication connectors
A_4	4.95 mm	position lubrication connector
G_4	M5 mm	lubrication connector
$t G_4$	7 mm	maximum permissible screw depth for lubrication connectors
J_{L6}	21.5 mm	position lubrication connector

