

Hexagon Socket Head Male Connector: KQ2S



Applicable tubing O.D. (mm)	Connection thread Uni One-touch fittings	Model	H (width across flats)	(Note)	L	A*	M	Effective area (mm²)		Mass (g)
				øD1				Nylon	Urethane	
4	1/8	KQ2S04-U01	3	10	23.5	18.5	16	4.1	3.6	7
6	1/8	KQ2S06-U01	4	11.8	24	19	17	10.0	9.9	9
	1/4	KQ2S06-U02		13.5		18		10.7	10.0	12
8	1/8	KQ2S08-U01	5	14	27.5	22.5	18.5	17.2	16.2	12
	1/4	KQ2S08-U02	6		28	22		23.3		14
	3/8	KQ2S08-U03		17	27.5	21.5				24
10	1/8	KQ2S10-U01	5	17	30	25	21	17.2	10.0	18
	1/4	KQ2S10-U02	8		29	23		39.0	26.6	17
	3/8	KQ2S10-U03		28.5	22.5	19				
	1/2	KQ2S10-U04		21	29	21				
12	1/4	KQ2S12-U02	8	19	30.5	25	22	46.0	44.5	20
	3/8	KQ2S12-U03	9	31		60.0		22		
	1/2	KQ2S12-U04		21	28.5			20.5		30

* Reference dimensions after Uni thread installation.

Note) ϕD : Max. diameter

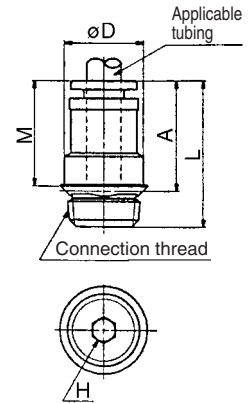

45° Male Elbow: KQ2K



Applicable tubing O.D. (mm)	Connection thread Uni One-touch fittings	Model	H (width across flats)	(Note)	øD1	øD2	L1	L2	A*	M	Effective area (mm²)		Mass (g)
											Nylon	Urethane	
4	1/8	KQ2K04-U01	10	10.4	10	17	18.5	30	16	3.4	3.4	6	
	1/4	KQ2K04-U02	14				20.5	30.5				13	
6	1/8	KQ2K06-U01	10	12.8	10	18	18.5	31	17	8.7	8.7	7	
	1/4	KQ2K06-U02	14				20.5	32				13	
	3/8	KQ2K06-U03	17				21.5	32				23	
8	1/8	KQ2K08-U01	12	15.2	12	20.5	20	35	18.5	19.7	13.6	11	
	1/4	KQ2K08-U02	14				22	36				15	
	3/8	KQ2K08-U03	17				23	36				24	
10	1/8	KQ2K10-U01	17	18.5	17	24	22	38	21	21.6	14.9	24	
	1/4	KQ2K10-U02					23.5	40.5				21	
	3/8	KQ2K10-U03					24	41		30.9	23.2	25	
	1/2	KQ2K10-U04					22	27				42	45
12	1/4	KQ2K12-U02	17	20.9	17	25	24	42	22	44.5	35.1	23	
	3/8	KQ2K12-U03					24.5	42.5				27	
	1/2	KQ2K12-U04					22	27.5				43.5	46

* Reference dimensions after Uni thread installation.

Note) $\phi D1$: Max. diameter

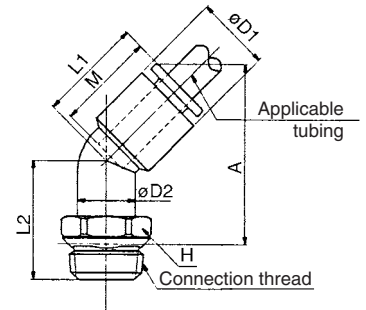

Universal Male Elbow: KQ2V



Applicable tubing O.D. (mm)	Connection thread Uni One-touch fittings	Model	H (width across flats)	(Note)	øD1	øD2	L1	L2	L3	A*	M	Effective area (mm²)		Mass (g)
												Nylon	Urethane	
4	1/8	KQ2V04-U01	8	10.4	13.4	22	13.5	25.5	20.5	16		2.9	2.9	12
6	1/8	KQ2V06-U01	8	12.8	13.4	24	13.5	25.5	20.5	17		7.5	7.5	13
	1/4	KQ2V06-U02	10		15.4	23.5	15.5	28	22				21	
8	1/8	KQ2V08-U01	12	15.2	17.6	28.5	14.5	27.5	22.5	18.5		11.2	24	22
	1/4	KQ2V08-U02					16.5	29.5	23.5			30	25	
	3/8	KQ2V08-U03	14		20.6	27.5	18.5	34	28			14.3	47	36
10	1/4	KQ2V10-U02	14	18.5	20.6	31	18.5	34	28	21	27	20.3	35	
	3/8	KQ2V10-U03											38	
12	3/8	KQ2V12-U03	17	20.9	25.2	34	20	36.5	30.5	22	39	30.8	52	
	1/2	KQ2V12-U04											22.5	39.5

* Reference dimensions after Uni thread installation.

Note) $\phi D1$: Max. diameter

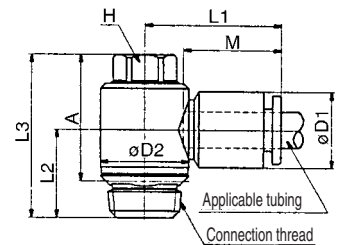

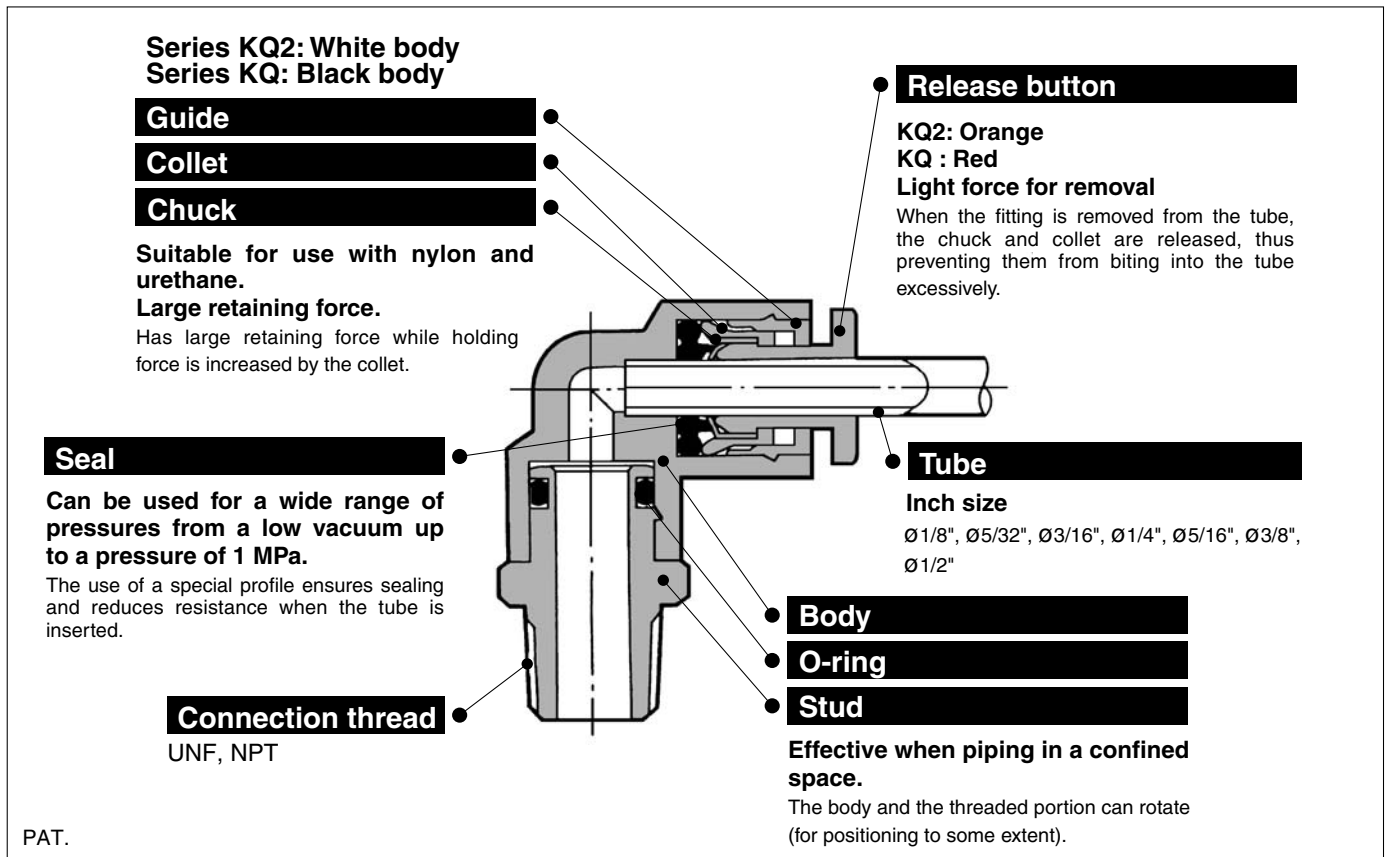

K ☐

M ☐

H ☐

KK ☐

D ☐

MS ☐

LQ ☐

MQR ☐

T ☐



Product's Color

Series	Body	Release button
Series KQ2	White	Orange
Series KQ	Black	Red

Applicable Tubing

Tubing material	FEP, PFA, Nylon, Soft nylon ⁽¹⁾ , Polyurethane
Tubing O.D.	$\varnothing 1/8"$, $\varnothing 5/32"$, $\varnothing 3/16"$, $\varnothing 1/4"$, $\varnothing 5/16"$, $\varnothing 3/8"$, $\varnothing 1/2"$

Note 1) Soft nylon tubing is not compatible with water.

Specifications

Fluid		Air/Water ⁽²⁾
Operating pressure range ⁽³⁾		-100 kPa to 1 MPa
Proof pressure		3 MPa
Ambient and fluid temperature		-5 to 60°C, Water: 0 to 40°C (No freezing)
Thread	Mounting section	ANSI/ASME B1.20.1 (NPT thread) JIS B0208 (UNF thread)
	Nut section	JIS B0208 (UNF thread)
Seal on the threads		With sealant or none



Note 2) The surge pressure must be under the maximum operating pressure.

Note 3) Do not use the fittings with a leak tester or for vacuum retention because they are not guaranteed for zero leakage.



Made to Order

Refer to page 75 for details.

Principal Parts Material

Body	C3604, PBT, PP
Stud	C3604 (Thread portion)
Chuck	Stainless steel 304
Guide	Stainless steel 304, C3604, PBT
Collet	POM
Release button	POM
Seal, O-ring	NBR
Gasket	Stainless steel 304, NBR