



The Timken Company

4500 Mt Pleasant St. NW

N. Canton, OH 44720

Phone: (234) 262-3000

E-Mail: CustomerCAD@timken.com • **Web site:** www.timken.com

Bearing Unit - Adapter Sleeve UKFC217 - H2317, UKFC 200 Piloted Round Flanged Mounted Bearings - Adapter Sleeve Locking

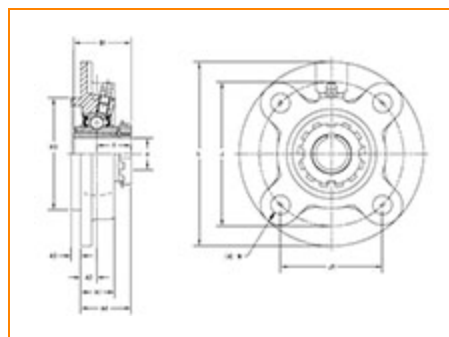

[Specifications](#) | [Dimensions](#) | [Basic Load Ratings](#)

Specifications

Bearing Unit - Adapter Sleeve	UK217 - H2317
Shaft Size d	75 mm
Adapter Sleeve Number¹	H2317
Locking Style	Adapter Sleeve Locking
Housing Construction	Round Flange

Dimensions

Total Height L	250 mm 9.843 in
-----------------------	--------------------



Pilot Outside Diameter H3	180 mm
Bolt Circle Diameter J	208 mm 8.189 in
Bolt Hole Spacing J1	147.1 mm 5.791 in
Bolt Hole Size N	23 mm 0.906 in
Flange Width A1	45 mm 1.772 in
Center of Bearing from Housing End A2	18 mm 0.709 in
Pilot Width A3	18 mm
Center of Bearing from Bearing End Y	46.5 mm 1.831 in
Dimension A4	64.5 mm 2.531 in
Dimension B1	82 mm 3.228 in

Basic Load Ratings

Static Load Rating	61900 N 13916 lbf
Dynamic Load Rating	84000 N 18884 lbf

¹ Purchase the Adapter Sleeve separately

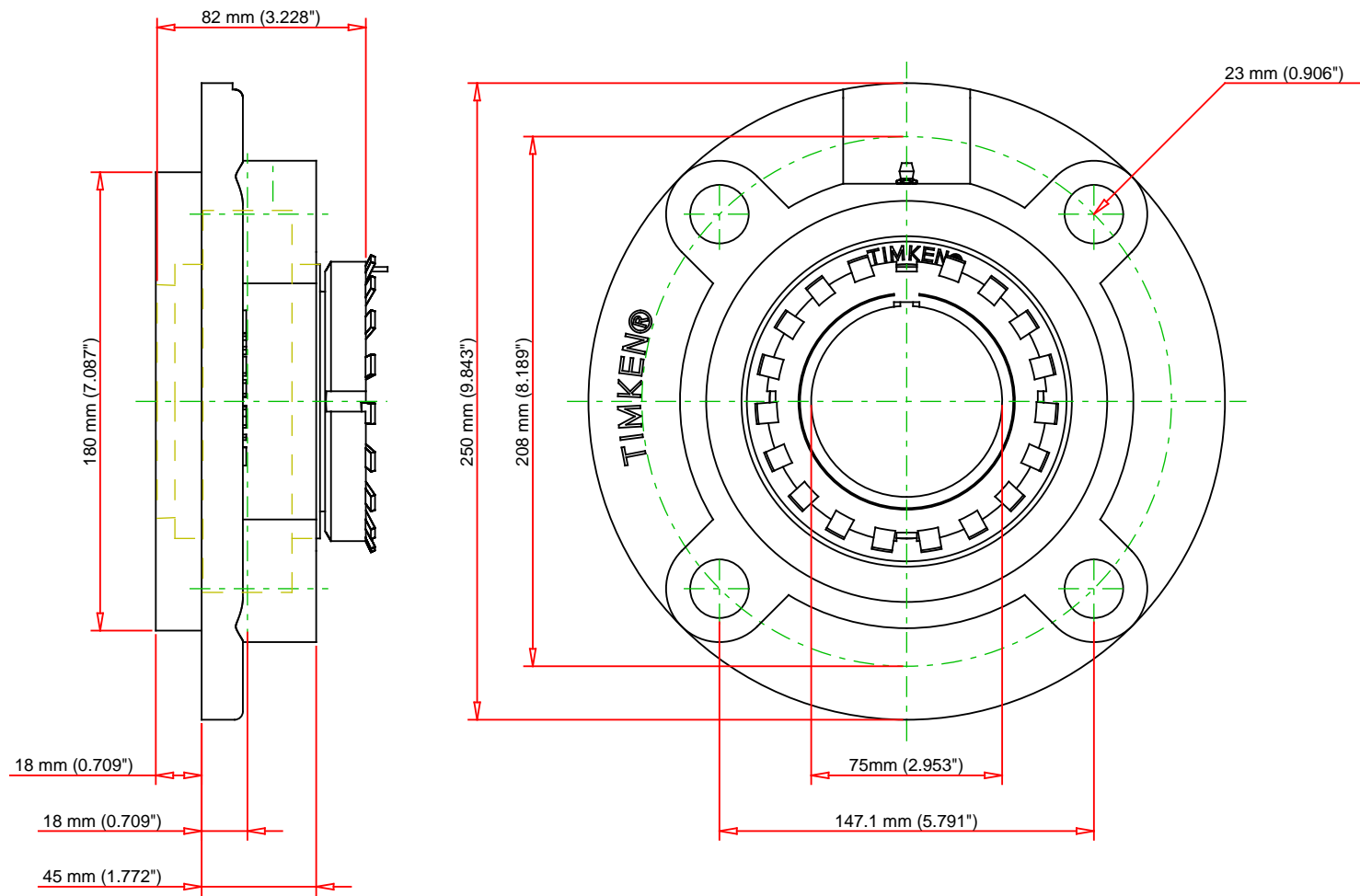

Note: Adapter sold separately

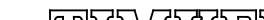
Bearing Number	UK217 - H2317				
Load Ratings - C _r	18884	lbf	84000	N	
Load Ratings - C _{0r}	13916	lbf	61900	N	
Weight	22.9	lb	10.4	kg	THE TIMKEN COMPANY NORTH CANTON, OHIO USA

UKFC217 - H2317	
UKFC 200 Piloted Round Flanged Mounted Bearings - Adapter Sleeve Locking	

Every reasonable effort has been made to ensure the accuracy of the information contained in this writing, but no liability is accepted for errors, omissions or for any other reason.

FOR DISCUSSION ONLY