



The Timken Company

4500 Mt Pleasant St. NW

N. Canton, OH 44720

Phone: (234) 262-3000

E-Mail: CustomerCAD@timken.com • **Web site:** www.timken.com

Bearing Unit - Adapter Sleeve UKFC216 - H2316, UKFC 200 Piloted Round Flanged Mounted Bearings - Adapter Sleeve Locking

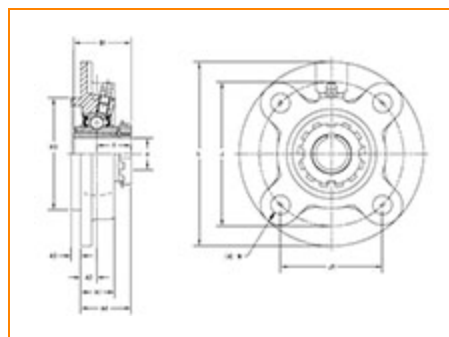

[Specifications](#) | [Dimensions](#) | [Basic Load Ratings](#)

Specifications

Bearing Unit - Adapter Sleeve	UK216 - H2316
Shaft Size d	70 mm
Adapter Sleeve Number¹	H2316
Locking Style	Adapter Sleeve Locking
Housing Construction	Round Flange

Dimensions

Total Height L	240 mm 9.449 in
-----------------------	--------------------



Pilot Outside Diameter H3 170 mm

Bolt Circle Diameter J 200 mm
7.874 in

Bolt Hole Spacing J1 141.4 mm
5.567 in

Bolt Hole Size N 23 mm
0.906 in

Flange Width A1 42 mm
1.654 in

Center of Bearing from Housing End A2 18 mm
0.709 in

Pilot Width A3 16 mm

Center of Bearing from Bearing End Y 44.5 mm
1.752 in

Dimension A4 62.5 mm
2.469 in

Dimension B1 78 mm
3.071 in

Basic Load Ratings

Static Load Rating 53000 N
11915 lbf

Dynamic Load Rating 72700 N
16344 lbf

¹ Purchase the Adapter Sleeve separately

