



**The Timken Company**

4500 Mt Pleasant St. NW

N. Canton, OH 44720

**Phone:** (234) 262-3000

**E-Mail:** [CustomerCAD@timken.com](mailto:CustomerCAD@timken.com) • **Web site:** [www.timken.com](http://www.timken.com)

## Bearing Unit - Adapter Sleeve UKFC215 - H2315, UKFC 200 Piloted Round Flanged Mounted Bearings - Adapter Sleeve Locking

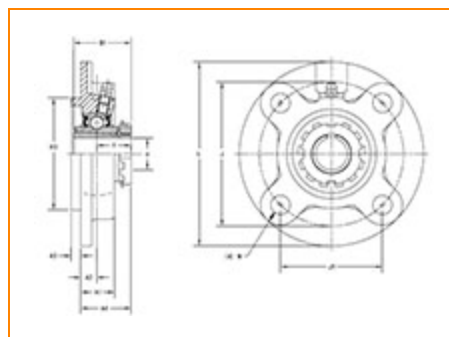

[Specifications](#) | [Dimensions](#) | [Basic Load Ratings](#)

### Specifications

<b>Bearing Unit - Adapter Sleeve</b>	UK215 - H2315
<b>Shaft Size d</b>	65 mm
<b>Adapter Sleeve Number<sup>1</sup></b>	H2315
<b>Locking Style</b>	Adapter Sleeve Locking
<b>Housing Construction</b>	Round Flange

### Dimensions

<b>Total Height L</b>	220 mm 8.661 in
-----------------------	--------------------



**Pilot Outside Diameter H3** 160 mm

**Bolt Circle Diameter J** 184 mm  
7.244 in

**Bolt Hole Spacing J1** 130.1 mm  
5.122 in

**Bolt Hole Size N** 19 mm  
0.748 in

**Flange Width A1** 40 mm  
1.575 in

**Center of Bearing from Housing End A2** 18 mm  
0.709 in

**Pilot Width A3** 16 mm

**Center of Bearing from Bearing End Y** 40.5 mm  
1.594 in

**Dimension A4** 58.5 mm  
2.313 in

**Dimension B1** 73 mm  
2.874 in

## Basic Load Ratings

**Static Load Rating** 48300 N  
10858 lbf

**Dynamic Load Rating** 67400 N  
15152 lbf

<sup>1</sup> Purchase the Adapter Sleeve separately

