



The Timken Company

4500 Mt Pleasant St. NW

N. Canton, OH 44720

Phone: (234) 262-3000

E-Mail: CustomerCAD@timken.com • **Web site:** www.timken.com

Bearing Unit - Adapter Sleeve UKT212 - HS2312, UKT 200 Take-Up Mounted Bearings - Adapter Sleeve Locking

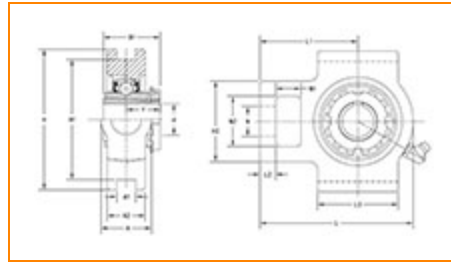

[Specifications](#) | [Dimensions](#) | [Basic Load Ratings](#)

Specifications

| | |
|--|------------------------|
| Bearing Unit - Adapter Sleeve | UK212 - HS2312 |
| Shaft Size d | 2.1250 in |
| Adapter Sleeve Number¹ | HS2312 |
| Locking Style | Adapter Sleeve Locking |
| Housing Construction | Take-Up |

Dimensions

| | |
|--|-------------------|
| Housing Width A | 64 mm 2.52 in |
|  Not Width A1 | 22 mm 0.866 in |

| | |
|-------------------------------------|---------------------|
| Socket Width A2 | 42 mm 1.654 in |
| Total Height H | 146 mm 5.748 in |
| Pitch Height H1 | 130 mm |
| Height H2 | 102 mm |
| Total Length L | 194 mm 7.638 in |
| Shaft Length L1 | 119 mm 4.685 in |
| Dimension L2 | 19 mm |
| Slot Length L3 | 102 mm 4.016 in |
| Adjustment Screw Bore N | 35 mm 1.378 in |
| Opening Width N1 | 25 mm 0.984 in |
| Opening Height N2 | 64 mm 2.52 in |
| Center of Bearing from End Y | 36.5 mm 1.437 in |
| Dimension B1 | 62 mm 2.441 in |
| Grease Nipple Size | B-R1/8 |

Basic Load Ratings

| | |
|---------------------------|---------------------|
| Static Load Rating | 36200 N 8138 lbf |
|---------------------------|---------------------|

Dynamic Load Rating

52400 N
11780 lbf

¹ Purchase the Adapter Sleeve separately

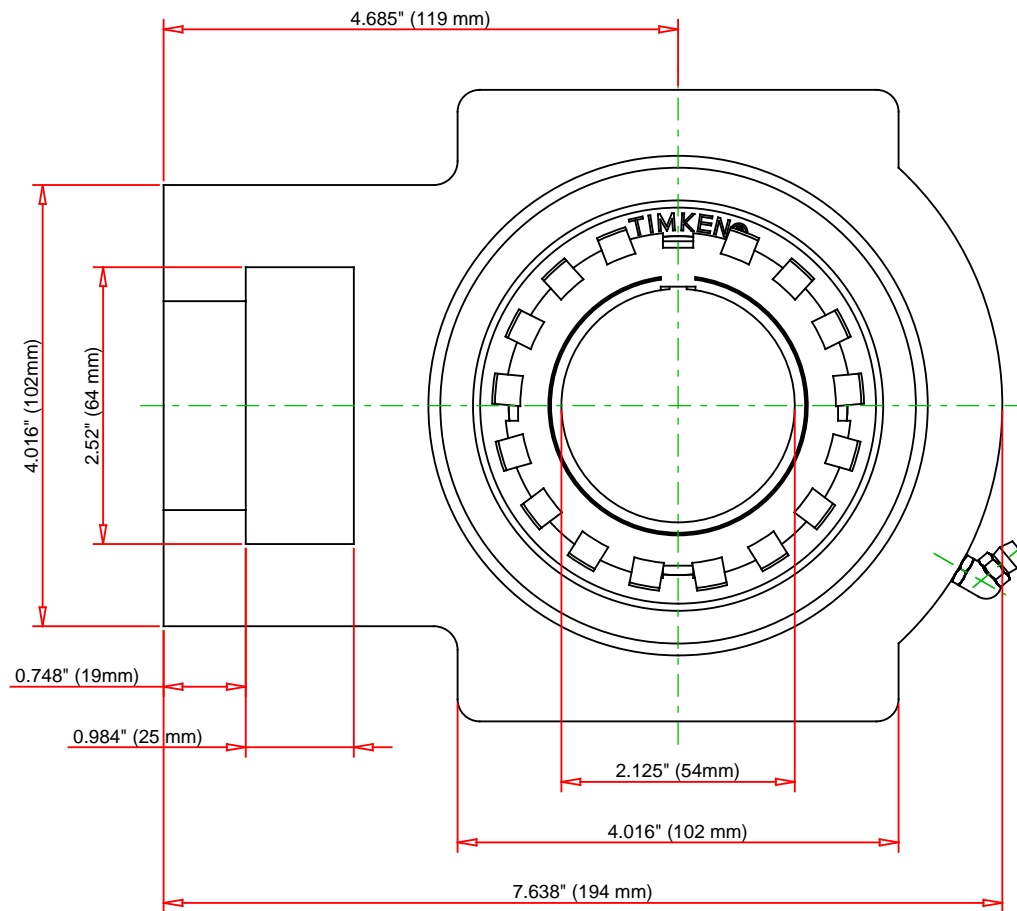
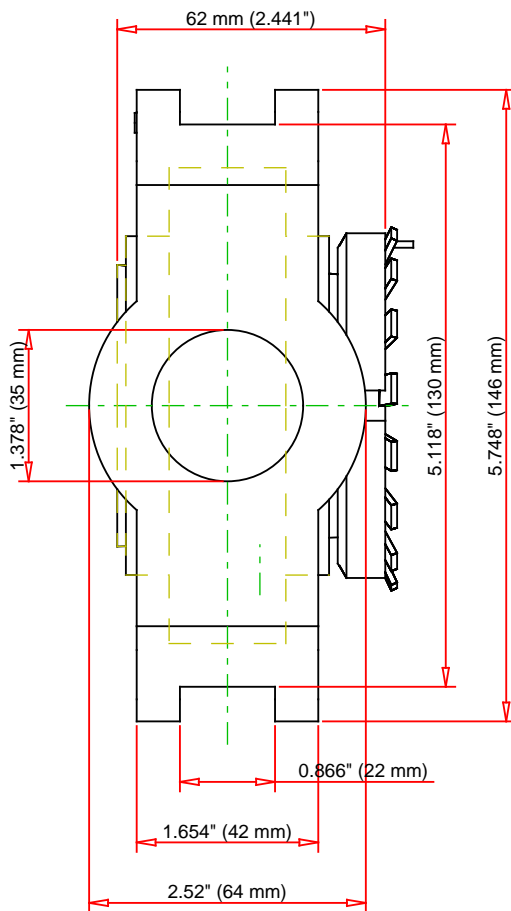

Note: Adapter sold separately

| | | | | |
|--------------------------------|----------------|-----|-------|----|
| Bearing Number | UK212 - HS2312 | | | |
| Load Ratings - C _r | 11780 | lbf | 52400 | N |
| Load Ratings - C _{0r} | 8138 | lbf | 36200 | N |
| Weight | 10.6 | lb | 4.8 | kg |
| | | | | |

TIMKEN

THE TIMKEN COMPANY
NORTH CANTON, OHIO USA

UKT212 - HS2312
UKT 200 Take-Up Mounted Bearings -
Adapter Sleeve Locking

Every reasonable effort has been made to ensure the accuracy of the information contained in this writing, but no liability is accepted for errors, omissions or for any other reason.

FOR DISCUSSION ONLY