

## Straight Union: KQ2H

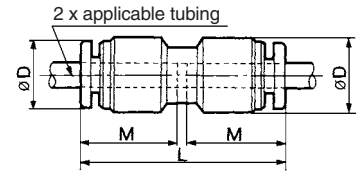

Applicable tubing O.D. (mm)	Model	øD <sup>(1)</sup>	L	M	Effective area <sup>(2)</sup> (mm <sup>2</sup> )		Mass (g)
					Nylon	Urethane	
3.2	KQ2H23-00	9.6	31.5	15.5	3.4	2.9	3
4	KQ2H04-00	10.4	32.5	16	5.6	4	3
6	KQ2H06-00	12.8	34.5	17	13.1	10.4	4
8	KQ2H08-00	15.2	38.5	18.5	26.1	18.0	6
10	KQ2H10-00	18.5	42.5	21	41.5	29.5	11
12	KQ2H12-00	20.9	44.5	22	58.3	46.1	14
16	KQ2H16-00	26.5	51	25	113	(96)	24



Note 1) øD: Max. diameter  
Note 2) ( ): Values for soft nylon.

## Different Diameter Straight: KQ2H



Applicable tubing O.D. (mm)		Model	Note) øD	L	M1	M2	Effective area <sup>(2)</sup> (mm <sup>2</sup> )		Mass (g)
(a)	(b)						Nylon	Urethane	
3.2	4	KQ2H23-04	10.4	32.5	15.5	16	3.4	2.9	3
4	6	KQ2H04-06	12.8	34.5	16	17	5.6	5.6	5
6	8	KQ2H06-08	15.2	38.5	17	18.5	13.1	10.4	6
8	10	KQ2H08-10	18.5	42	18.5	21	26.1	18.0	11
10	12	KQ2H10-12	20.9	44.5	21	22	41.5	29.5	14
12	16	KQ2H12-16	26.5	56.5	22	25	58.3	46.1	47

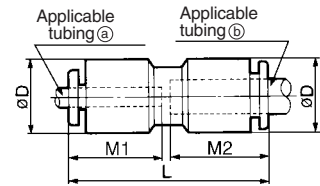

Note) øD: Max. diameter

## Male Elbow: KQ2L

<M5>



<M6>



<R>



Applicable tubing O.D. (mm)	Connection thread R M	Model	H (width across flats)	øD <sup>(1)</sup>	øD2	L1	L2	A*	M	Effective area <sup>(2)</sup> (mm <sup>2</sup> )		Mass (g)
										Nylon	Urethane	
3.2	M5 x 0.8	KQ2L23-M5	7	8.5	—	15.3	13.2	14.3	12.7	2.6	2.2	2.5
	1/8	KQ2L23-01S	10	9.6	10	17.5	20.6	22.5	15.5	3	2.5	8
	1/4	KQ2L23-02S	14	—	—	—	25	24.5	—	—	—	18
4	M6 x 1.0	KQ2L04-M5	7	9.3	—	15.6	13.7	15.3	12.7	3.5	3.5	2.7
	1/8	KQ2L04-M6	8	—	—	—	14.7	16	4.2	4.2	—	3.6
	1/4	KQ2L04-02S	14	10.4	10	18	21.1	23	16	4.2	4.2	10
6	1/8	KQ2L04-01S	10	10.4	10	18	25.5	25	16	4.2	4.2	19
	M5 x 0.8	KQ2L06-M5	7	11.6	—	16.1	14.7	17.4	13.5	3.5	3.5	3.2
	M6 x 1.0	KQ2L06-M6	8	—	—	—	15.7	17.4	13.5	3.5	3.5	4.1
	1/8	KQ2L06-01S	10	12.8	10	20	22.1	25.5	17	11.4	9.0	12
	1/4	KQ2L06-02S	14	12.8	10	20	26.5	27.5	17	11.4	9.0	22
8	3/8	KQ2L06-03S	17	—	—	—	27.9	29	—	—	—	33
	1/8	KQ2L08-01S	12	15.2	12	23	23.6	28	18.5	21.6	14.9	13
	1/4	KQ2L08-02S	14	15.2	12	23	28	30	18.5	21.6	14.9	21
10	3/8	KQ2L08-03S	17	—	—	—	29.4	31.5	—	—	—	35
	1/8	KQ2L10-01S	17	18.5	17	26.5	26.1	32	21	21.6	14.9	25
	1/4	KQ2L10-02S	17	—	—	—	29.5	33	—	—	—	26
	3/8	KQ2L10-03S	22	—	—	—	30.9	34.5	—	—	—	36
12	1/2	KQ2L10-04S	22	—	—	—	35.1	37	—	—	—	63
	1/4	KQ2L12-02S	17	20.9	17	28.5	30.5	35.5	22	50.2	39.7	28
	3/8	KQ2L12-03S	17	—	—	—	31.9	37	—	—	—	38
	1/2	KQ2L12-04S	22	—	—	—	36.1	39.5	—	—	—	65
16	3/8	KQ2L16-03S	22	26.5	20.9	34	36.9	44.5	25	71	(71)	101
	1/2	KQ2L16-04S	22	—	—	—	40.1	46	—	100	(84)	105

\* Reference dimensions after R thread installation.

Note 1) øD1: Max. diameter  
Note 2) ( ): Values for soft nylon.



<M5, M6>

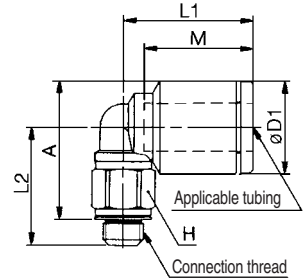

<R>

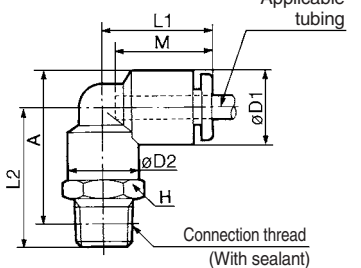

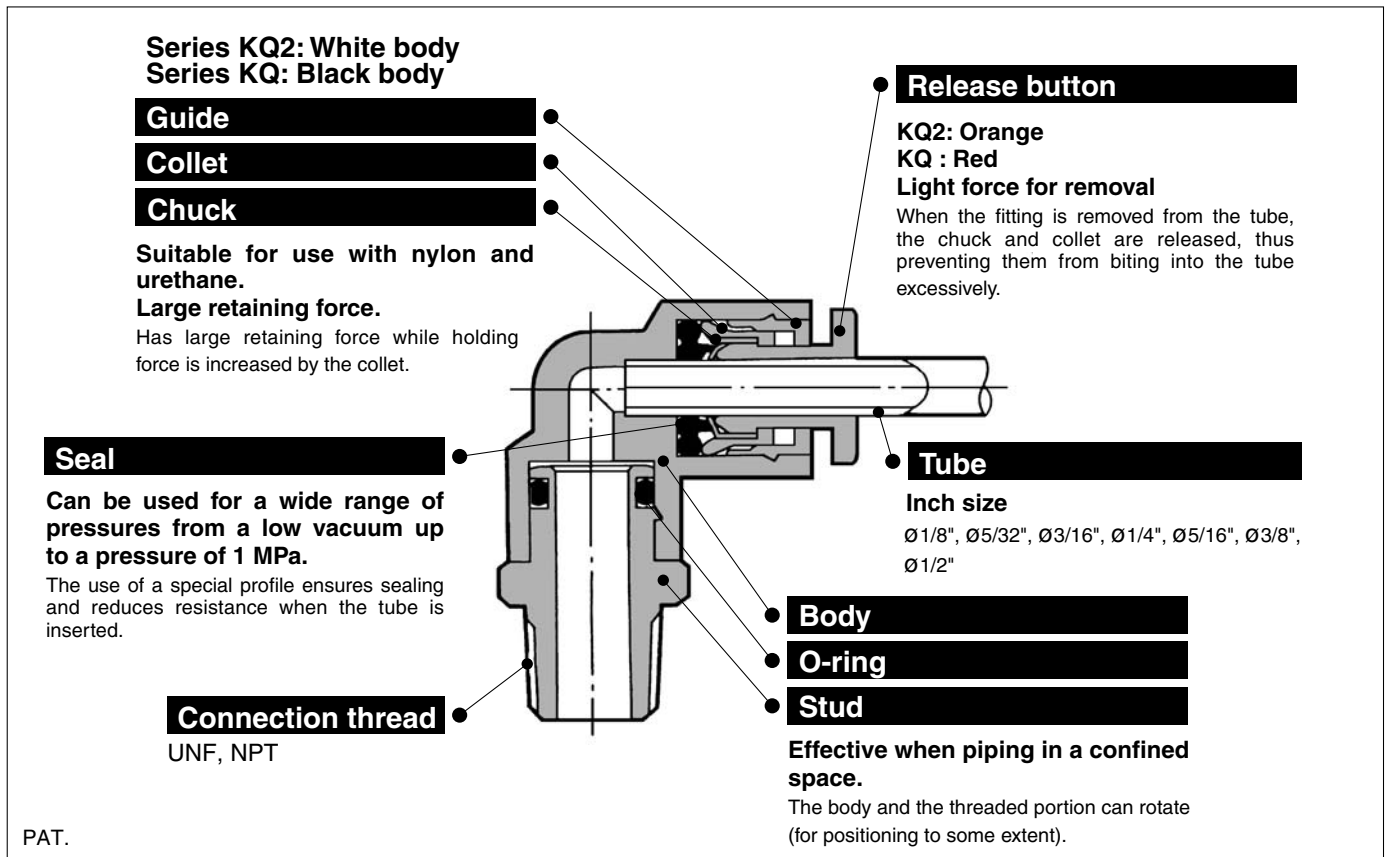

K ☐  
 M ☐  
 H ☐  
 KK ☐  
 D ☐  
 MS ☐  
 LQ ☐  
 MQR ☐  
 T ☐



## Product's Color

Series	Body	Release button
Series KQ2	White	Orange
Series KQ	Black	Red

## Applicable Tubing

Tubing material	FEP, PFA, Nylon, Soft nylon <sup>(1)</sup> , Polyurethane
Tubing O.D.	$\varnothing 1/8"$ , $\varnothing 5/32"$ , $\varnothing 3/16"$ , $\varnothing 1/4"$ , $\varnothing 5/16"$ , $\varnothing 3/8"$ , $\varnothing 1/2"$

Note 1) Soft nylon tubing is not compatible with water.

## Specifications

<b>Fluid</b>		Air/Water <sup>(2)</sup>
<b>Operating pressure range <sup>(3)</sup></b>		-100 kPa to 1 MPa
<b>Proof pressure</b>		3 MPa
<b>Ambient and fluid temperature</b>		-5 to 60°C, Water: 0 to 40°C (No freezing)
<b>Thread</b>	<b>Mounting section</b>	ANSI/ASME B1.20.1 (NPT thread) JIS B0208 (UNF thread)
	<b>Nut section</b>	JIS B0208 (UNF thread)
<b>Seal on the threads</b>		With sealant or none



Note 2) The surge pressure must be under the maximum operating pressure.

Note 3) Do not use the fittings with a leak tester or for vacuum retention because they are not guaranteed for zero leakage.



## Made to Order

Refer to page 75 for details.

## Principal Parts Material

Body	C3604, PBT, PP
Stud	C3604 (Thread portion)
Chuck	Stainless steel 304
Guide	Stainless steel 304, C3604, PBT
Collet	POM
Release button	POM
Seal, O-ring	NBR
Gasket	Stainless steel 304, NBR