



**The Timken Company**

4500 Mt Pleasant St. NW

N. Canton, OH 44720

**Phone:** (234) 262-3000

**E-Mail:** [CustomerCAD@timken.com](mailto:CustomerCAD@timken.com) • **Web site:** [www.timken.com](http://www.timken.com)

## Bearing Unit - Adapter Sleeve UKFC213 - H2313, UKFC 200 Piloted Round Flanged Mounted Bearings - Adapter Sleeve Locking

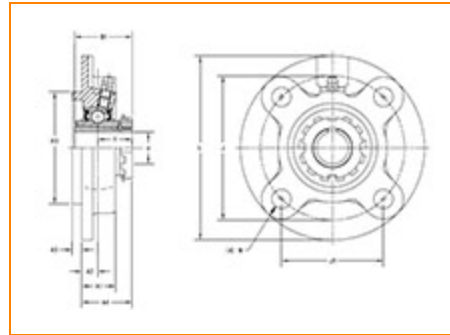

[Specifications](#) | [Dimensions](#) | [Basic Load Ratings](#)

### Specifications

<b>Bearing Unit - Adapter Sleeve</b>	UK213 - H2313
<b>Shaft Size d</b>	60 mm
<b>Adapter Sleeve Number<sup>1</sup></b>	H2313
<b>Locking Style</b>	Adapter Sleeve Locking
<b>Housing Construction</b>	Round Flange

### Dimensions

<b>Total Height L</b>	205 mm 8.071 in
-----------------------	--------------------



**Pilot Outside Diameter H3** 145 mm

**Bolt Circle Diameter J** 170 mm  
6.693 in

**Bolt Hole Spacing J1** 120.2 mm  
4.732 in

**Bolt Hole Size N** 19 mm  
0.748 in

**Flange Width A1** 36 mm  
1.417 in

**Center of Bearing from Housing End A2** 16 mm  
0.63 in

**Pilot Width A3** 14 mm

**Center of Bearing from Bearing End Y** 37.5 mm  
1.476 in

**Dimension A4** 53.5 mm  
2.094 in

**Dimension B1** 65 mm  
2.559 in

## Basic Load Ratings

**Static Load Rating** 40100 N  
9015 lbf

**Dynamic Load Rating** 57200 N  
12859 lbf

<sup>1</sup> Purchase the Adapter Sleeve separately

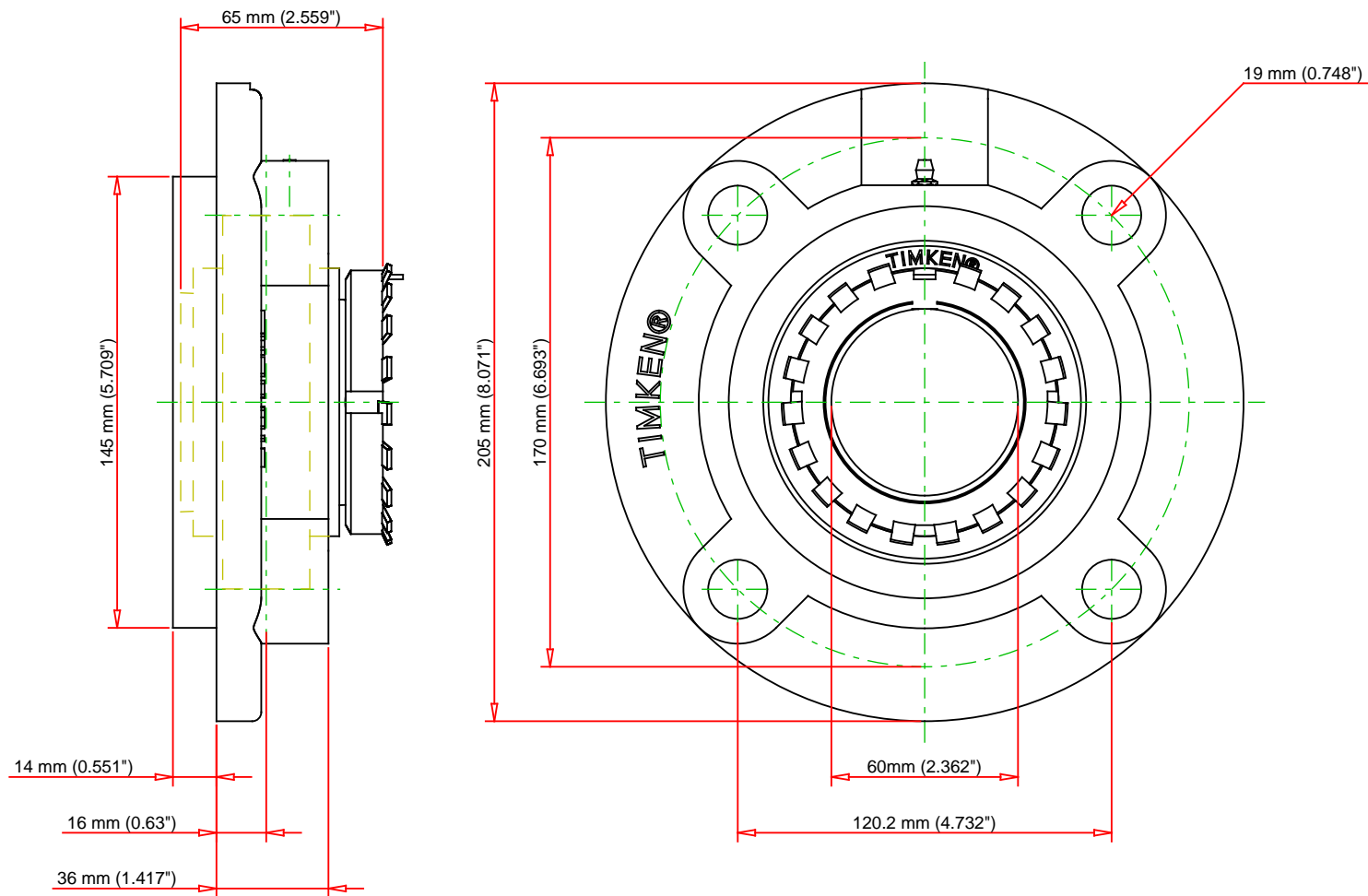

Note: Adapter sold separately

	Bearing Number	UK213 - H2313					<b>UKFC213 - H2313</b> UKFC 200 Piloted Round Flanged Mounted Bearings - Adapter Sleeve Locking
	Load Ratings - C <sub>r</sub>	12859	lbf	57200	N		
	Load Ratings - C <sub>0r</sub>	9015	lbf	40100	N		
	Weight	12.1	lb	5.5	kg		
						THE TIMKEN COMPANY NORTH CANTON, OHIO USA	
Every reasonable effort has been made to ensure the accuracy of the information contained in this writing, but no liability is accepted for errors, omissions or for any other reason.							<b>FOR DISCUSSION ONLY</b>