



LOCKNUT-HOOK-KM24-27 [↗](#)

Locknut hook wrench

for locknuts KM



Technical information

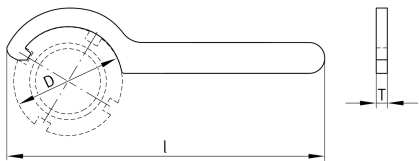

Dimensions

D _{min}	155 mm	
D _{max}	165 mm	
l	385 mm	
T	10 mm	
≈m	0.965 kg	Weight

Additional information

1 pc. hook wrench	Scope of delivery
—	Part of LOCKNUT-HOOK-KM0-16-SET
KM24, KM25, KM26, KM27	suitable for locknuts