

Pressure Sensor For General Pneumatic Applications Series *PSE 510*

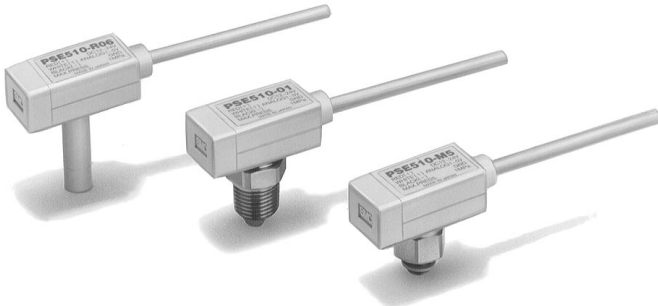

How to Order

PSE51 — 															
Operating pressure	Porting														
<table border="1"> <tr><td>0</td><td>High pressure (0 to 1 MPa)</td></tr> <tr><td>1</td><td>Vacuum (−101 to 0 kPa)</td></tr> <tr><td>2</td><td>Low pressure (0 to 100 kPa)</td></tr> </table>	0	High pressure (0 to 1 MPa)	1	Vacuum (−101 to 0 kPa)	2	Low pressure (0 to 100 kPa)	<table border="1"> <tr><td>R06</td><td>ø6 reducer</td></tr> <tr><td>M5</td><td>M5 X 0.8</td></tr> <tr><td>01</td><td>R(PT) 1/8, M5 X 0.8</td></tr> <tr><td>T01</td><td>NPTF 1/8, M5 X 0.8</td></tr> </table>	R06	ø6 reducer	M5	M5 X 0.8	01	R(PT) 1/8, M5 X 0.8	T01	NPTF 1/8, M5 X 0.8
0	High pressure (0 to 1 MPa)														
1	Vacuum (−101 to 0 kPa)														
2	Low pressure (0 to 100 kPa)														
R06	ø6 reducer														
M5	M5 X 0.8														
01	R(PT) 1/8, M5 X 0.8														
T01	NPTF 1/8, M5 X 0.8														

Sensor Specifications/General Pneumatic Applications

Model		PSE510-□	PSE511-□	PSE512-□
Operating pressure range		0 to 1 MPa	−101 to 0kPa	0 to 100kPa
Max. pressure		1MPa	200kPa	
Fluid		Air, Non corrosive gases		
Output specification		Analog (1 to 5V, Load impedance: 10kΩ or more)		
Supply voltage		12 to 24V DC (Ripple ± 10% or less)		
Current consumption		10mA or less		
Operating temperature range		0 to 50°C (No condensation)		
Temperature characteristics (25°C standard)	25 ± 10°C	± 1%F.S. or less		
	0 to 50°C	± 1.5% F.S. or less		
Repeatability		± 0.3% F.S. or less		
Voltage resistance		Between external terminal and housing 1000V AC, 50/60Hz for 1 min.		
Insulation resistance		Between external terminal and housing 2MΩ (500V DC by megameter)		
Vibration resistance		10 to 500Hz Pulse width: 1.5mm or acceleration 98 m/s ² (at the smaller vibration) to X, Y, Z direction (2 hours)		
Shock resistance		980 m/s ² to X, Y, Z direction (3 times for each direction)		
Protective construction		IP40		

Note) When pressure sensor PSE510 series is connected to controller PSE100 series, display range is as series PSE100.

Process Connection

Model		R06	M5	01	T01
Material	Housing	Resin housing: PBT	Resin housing: PBT Fitting: Stainless steel (SUS303)	Resin housing: PBT Fitting: C3604BD (Electroless nickel plated)	Resin housing: PBT Fitting: C3604BD (Electroless nickel plated)
	Pressure sensor area	Pressure sensor: Silicon, O ring: NBR			
Lead wire		Oil proof vinyl insulation ø2.55, 0.15mm ² X 3 wire (Brown, Blue, Black) 3000mm			
Port size		ø6 reducer	M5 X 0.8	R(PT) 1/8, M5 X 0.8	NPTF1/8, M5 X 0.8
Weight (Excluding lead wire)		Approx. 7g	Approx. 10g	Approx. 12g	

Internal Circuit

Lead wire colors inside () are those prior to conformity with IEC standards.

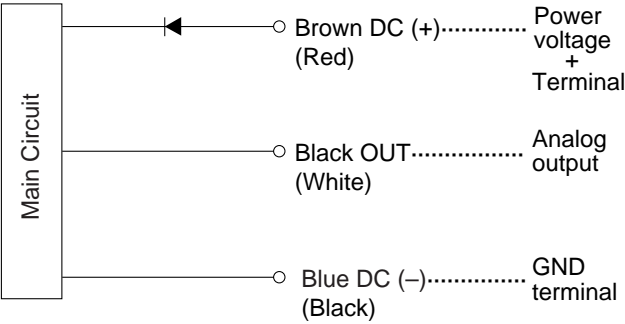

Caution

Be sure to read before handling. Refer to p.0-26 and 0-27 for Safety Instructions and common precautions on the products mentioned in this catalog, and refer to p.3.0-7 to 3.0-9 for precautions on every series.

Dimensions

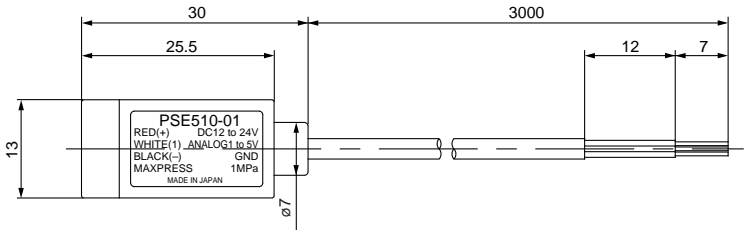

01, T01

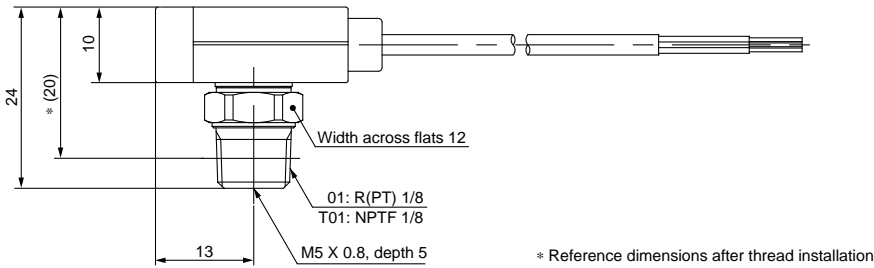

M5

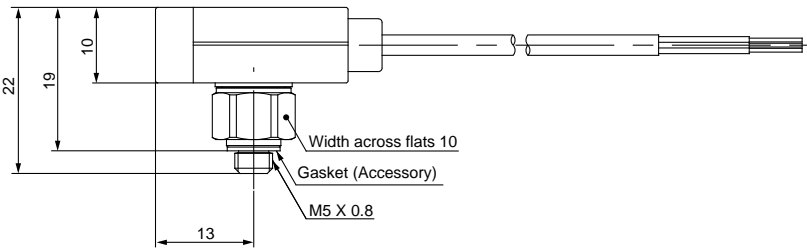

R06

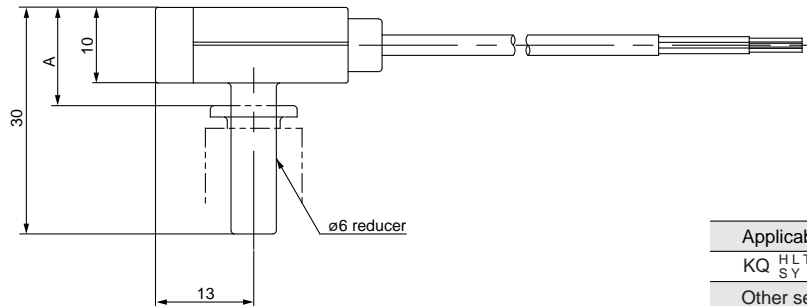

Applicable fitting	A
KQ ^{HLT} _{SY} 06-M5	16
Other series KQ, KS	13
KJ Series	14.5
KJ (-X20) Series	16

PSE

ZSE4
ISE4

ZSE5
ISE5

ZSE6
ISE6

ZSE3
ISE3

GS

PS

ISA

ZSE1
ISE1

ZSE2
ISE2

ZSP

IS□

ZSM

PF□

IF□