

**The Timken Company**

4500 Mt Pleasant St. NW

N. Canton, OH 44720

**Phone:** (234) 262-3000

**E-Mail:** [CustomerCAD@timken.com](mailto:CustomerCAD@timken.com) • **Web site:** [www.timken.com](http://www.timken.com)

## Part Number QVVSN14V060S, Double V-Lock Two-Bolt Pillow Block

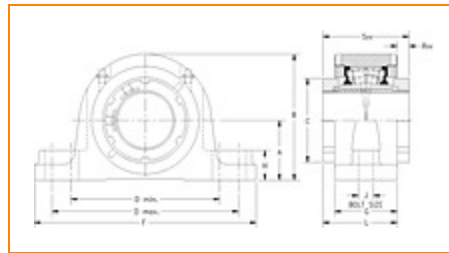

[Specifications](#) | [Dimensions](#) | [Radial and Thrust Factors](#) | [Engineering Seal Speed](#) | [Engineering Bearing Attributes](#) | [Engineering Internal Radial Clearance](#)

### Specifications

<b>Engineering Group</b>	Mounted Bearing
<b>Bearing Number</b>	22214
<b>Shaft Size</b>	60.000 mm
<b>Shaft Size Type</b>	Metric
<b>Full Timken Part Number</b>	QVVSN14V060SB QVVSN14V060SC QVVSN14V060SEB QVVSN14V060SEC QVVSN14V060SEM QVVSN14V060SEN QVVSN14V060SEO QVVSN14V060SET QVVSN14V060SM QVVSN14V060SMNP



QVVSN14V060SN  
QVVSN14V060SO  
QVVSN14V060ST

**Locking Style** Double V-Lock

**Housing Construction** Two-Bolt Pillow Block

**UPC Code**

0883450177573  
0883450177764  
0883450177771  
0883450178051  
0883450178242  
0883450178259  
0883450205160  
0883450205542  
0883450217583  
0883450217965  
0883450230001  
0883450230384  
0883450456500

## Dimensions

**Dimension A**

3.15 in  
80 mm

**Dimension B**

6.18 in  
157 mm

**Dimension C**

3.7 in  
94 mm

**Dimension D Min**

7.72 in  
196 mm

**Dimension D Max**

9.25 in  
235 mm

**Dimension F**

10.83 in  
275 mm

**Dimension G**

2.91 in  
74 mm

<b>Dimension H</b>	1.38 in 35 mm
<b>Dimension J (Bolt Size)</b>	0.625 in 16 mm
<b>Dimension L</b>	3.5 in 89 mm
<b>Dimension RVV</b>	0.59 in 15 mm
<b>Dimension SVV</b>	4.09 in 104 mm

## Radial and Thrust Factors

<b>C0 - Static Load</b>	52000 lbf 231000 N
<b>C - Dynamic Load (Basic)</b>	47800 lbf 213000 N
<b>e - Geometry Factor</b>	0.24
<b>Y1 - Geometry Factor</b>	2.90
<b>Y2 - Geometry Factor</b>	4.32

## Engineering Seal Speed

<b>Oil Lubrication - M/N Seal</b>	1700 rpm
<b>Oil Lubrication - T Seal</b>	3050 rpm
<b>Oil Lubrication - B/C/O Seal</b>	1400 rpm
<b>Grease Lubrication - M/N Seal</b>	1700 rpm
<b>Grease Lubrication - T Seal</b>	2600 rpm
<b>Grease Lubrication - B/C/O Seal</b>	1400 rpm

## Engineering Bearing Attributes

## Float

0.083 in  
2.108 mm

## Shaft Tolerance

0.0015 in  
0.038 mm

## Engineering Internal Radial Clearance

Eng Internal Radial Clearance -  
Min

0.0030

Eng Internal Radial Clearance -  
Max

0.0037

## Pre Install Clearance Min

0.0030 in  
0.075 mm

## Pre Install Clearance Max

0.0037 in  
0.094 mm

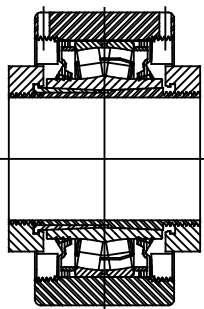
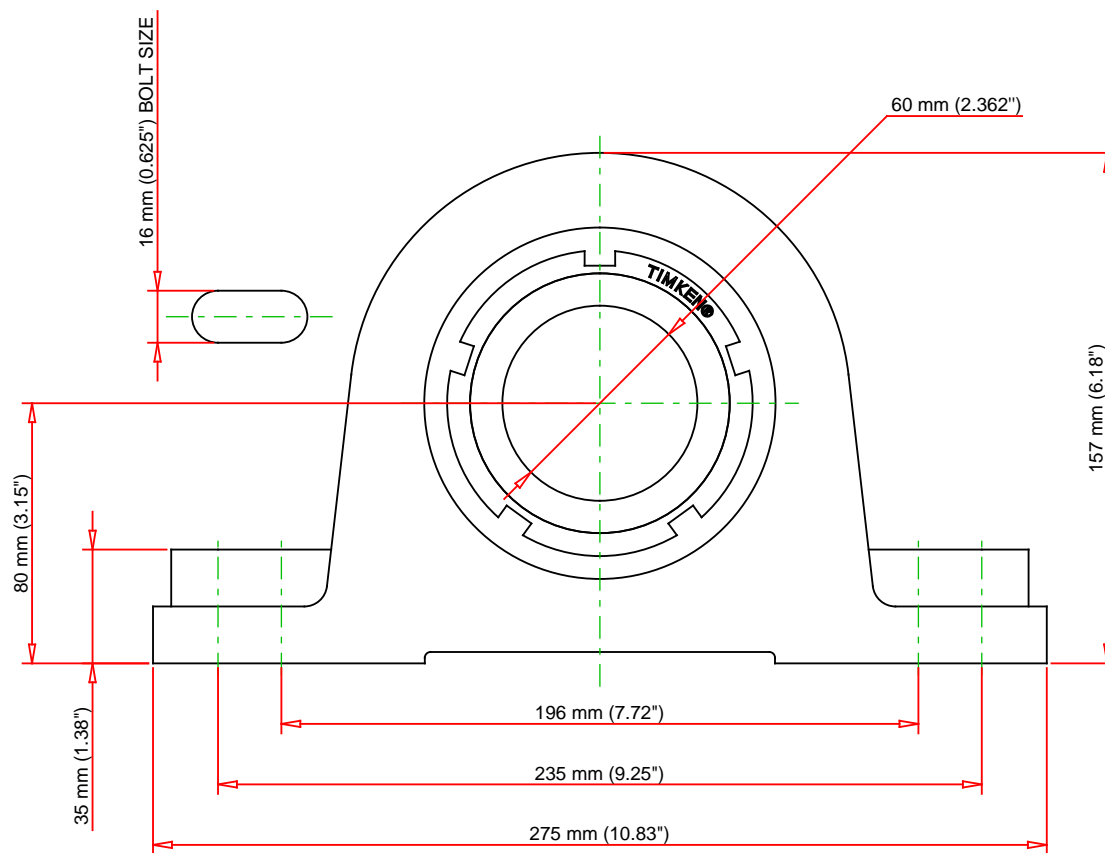
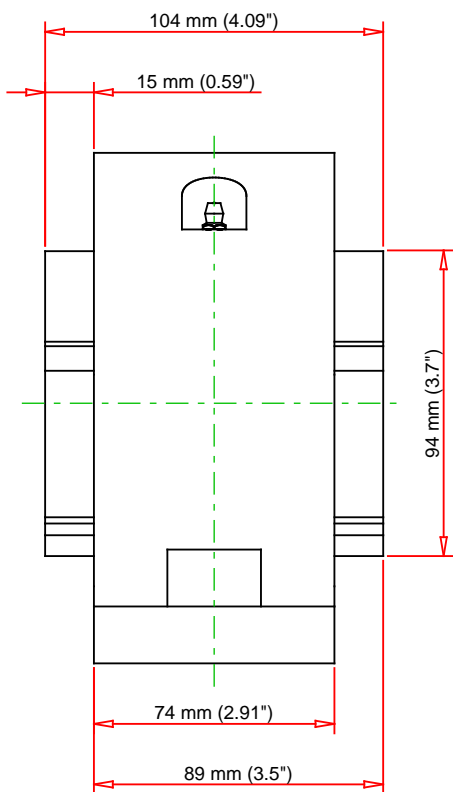

Note: Section View not to Scale

C - Dynamic Load	47800	lbf	213000	N
C0 - Static Load	52000	lbf	231000	N
Weight	37	lb	16.8	kg
Max. Speed T-Seals & Grease	2600	rpm		
Rad. Clearance - Max.	0.0037			

**TIMKEN**

THE TIMKEN COMPANY  
NORTH CANTON, OHIO USA

**QVVSN14V060S**  
Double V-Lock Two-Bolt Pillow Block

Every reasonable effort has been made to ensure the accuracy of the information contained in this writing, but no liability is accepted for errors, omissions or for any other reason.

**FOR DISCUSSION ONLY**