



GLCTE30-TV-FA125.5

Flanged housing unit

Schaeffler ID:
0574653980000

Flanged housing unit GLCTE...-TV

Technical information

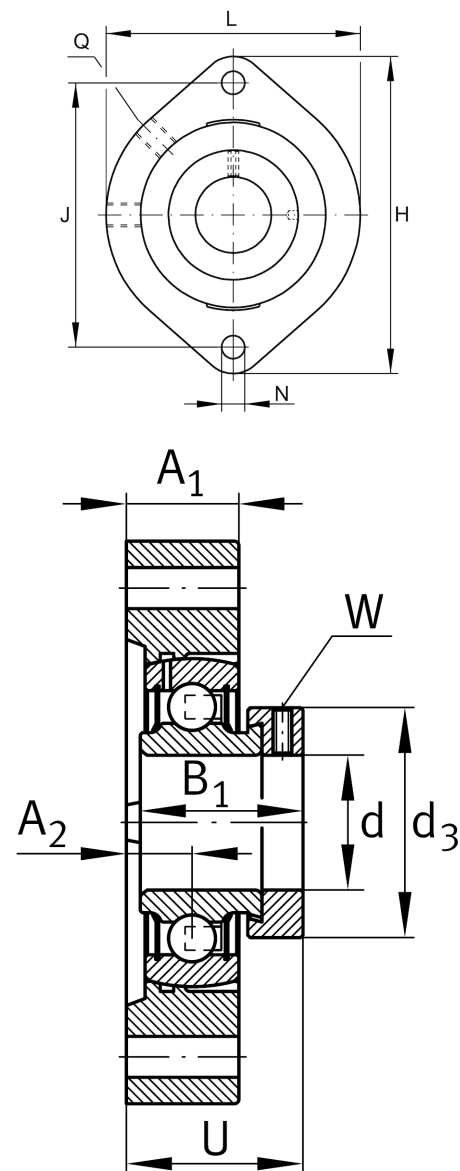

Main Dimensions & Performance Data

d	30 mm	Bore diameter
L	84 mm	Flange width
H	112.5 mm	Height flange
U	38.3 mm	Total height unit
C _r	17,100 N	Basic dynamic load rating, radial
C _{0r}	9,200 N	Basic static load rating, radial
	0.47 kg	Weight

Mounting dimensions

J	90.5 mm	Distance fixing bore
N	11.5 mm	Fixing bore
n	2	Number of screwing holes

Dimensions

A ₁	20.5 mm	Thickness of flange
A ₂	11.5 mm	Distance raceway
B ₁	35.8 mm	Locking collar total width
Q	1/4-28 UNF	Connection thread lubrication
d ₃	44 mm	Outside diameter eccentric locking collar

Additional information

GRAE30-NPP-B-	Bearing designation
FA107/125.5	
KASK06-S-G	Protecting cap