



The Timken Company

4500 Mt Pleasant St. NW

N. Canton, OH 44720

Phone: (234) 262-3000

E-Mail: CustomerCAD@timken.com • **Web site:** www.timken.com

Bearing Unit - Adapter Sleeve UKFC211 - H2311, UKFC 200 Piloted Round Flanged Mounted Bearings - Adapter Sleeve Locking

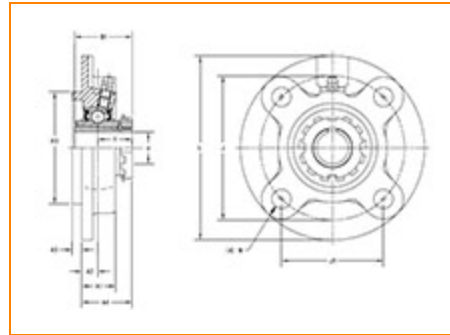

[Specifications](#) | [Dimensions](#) | [Basic Load Ratings](#)

Specifications

Bearing Unit - Adapter Sleeve	UK211 - H2311
Shaft Size d	50 mm
Adapter Sleeve Number¹	H2311
Locking Style	Adapter Sleeve Locking
Housing Construction	Round Flange

Dimensions

Total Height L	185.000 mm 7.283 in
-----------------------	------------------------



Pilot Outside Diameter H3 125 mm

Bolt Circle Diameter J 150 mm
5.906 in

Bolt Hole Spacing J1 106.1 mm
4.177 in

Bolt Hole Size N 19 mm
0.748 in

Flange Width A1 31 mm
1.22 in

Center of Bearing from Housing End A2 13 mm
0.512 in

Pilot Width A3 12 mm

Center of Bearing from Bearing End Y 32 mm
1.260 in

Dimension A4 45.5 mm
1.781 in

Dimension B1 59 mm
2.323 in

Basic Load Ratings

Static Load Rating 29400 N
6609 lbf

Dynamic Load Rating 43400 N
9757 lbf

¹ Purchase the Adapter Sleeve separately

