

The Timken Company

4500 Mt Pleasant St. NW

N. Canton, OH 44720

Phone: (234) 262-3000

E-Mail: CustomerCAD@timken.com • **Web site:** www.timken.com

Part Number QVVSN12V055S, Double V-Lock Two-Bolt Pillow Block

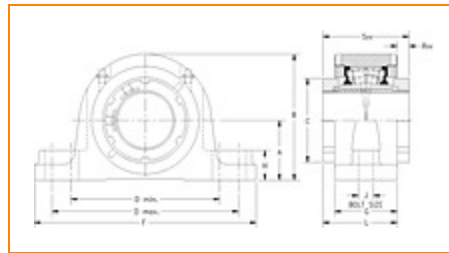

[Specifications](#) | [Dimensions](#) | [Radial and Thrust Factors](#) | [Engineering Seal Speed](#) | [Engineering Bearing Attributes](#) | [Engineering Internal Radial Clearance](#)

Specifications

Engineering Group	Mounted Bearing
Bearing Number	22212
Shaft Size	55.000 mm
Shaft Size Type	Metric
Full Timken Part Number	QVVSN12V055SB QVVSN12V055SC QVVSN12V055SEB QVVSN12V055SEC QVVSN12V055SEM QVVSN12V055SEN QVVSN12V055SEO QVVSN12V055SET QVVSN12V055SM QVVSN12V055SN QVVSN12V055SO QVVSN12V055ST



Locking Style	Double V-Lock
Housing Construction	Two-Bolt Pillow Block
UPC Code	0883450087742 0883450099011 0883450099622 0883450108034 0883450108225 0883450114882 0883450115018 0883450130394 0883450130523 0883450138468 0883450138772 0883450358088

Dimensions

Dimension A	2.76 in 70 mm
Dimension B	5.55 in 141 mm
Dimension C	3.15 in 80 mm
Dimension D Min	7.2 in 183 mm
Dimension D Max	8.5 in 216 mm
Dimension F	10 in 254 mm
Dimension G	2.68 in 68 mm
Dimension H	1 in 25 mm

Dimension J (Bolt Size)	0.625 in 16 mm
Dimension L	3.35 in 85 mm
Dimension RVV	0.67 in 17 mm
Dimension SVV	4.02 in 102 mm

Radial and Thrust Factors

C0 - Static Load	39000 lbf 174000 N
C - Dynamic Load (Basic)	38100 lbf 169000 N
e - Geometry Factor	0.24
Y1 - Geometry Factor	2.84
Y2 - Geometry Factor	4.23

Engineering Seal Speed

Oil Lubrication - M/N Seal	2000 rpm
Oil Lubrication - T Seal	3500 rpm
Oil Lubrication - B/C/O Seal	1650 rpm
Grease Lubrication - M/N Seal	2000 rpm
Grease Lubrication - T Seal	3000 rpm
Grease Lubrication - B/C/O Seal	1550 rpm

Engineering Bearing Attributes

Float	0.050 in 1.270 mm
Shaft Tolerance	0.0015 in 0.038 mm

Engineering Internal Radial Clearance

Eng Internal Radial Clearance - Min	0.0030
Eng Internal Radial Clearance - Max	0.0037
Pre Install Clearance Min	0.0030 in 0.075 mm
Pre Install Clearance Max	0.0037 in 0.094 mm

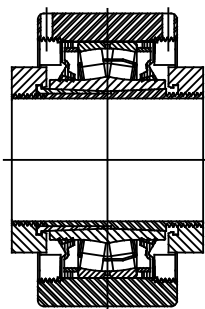
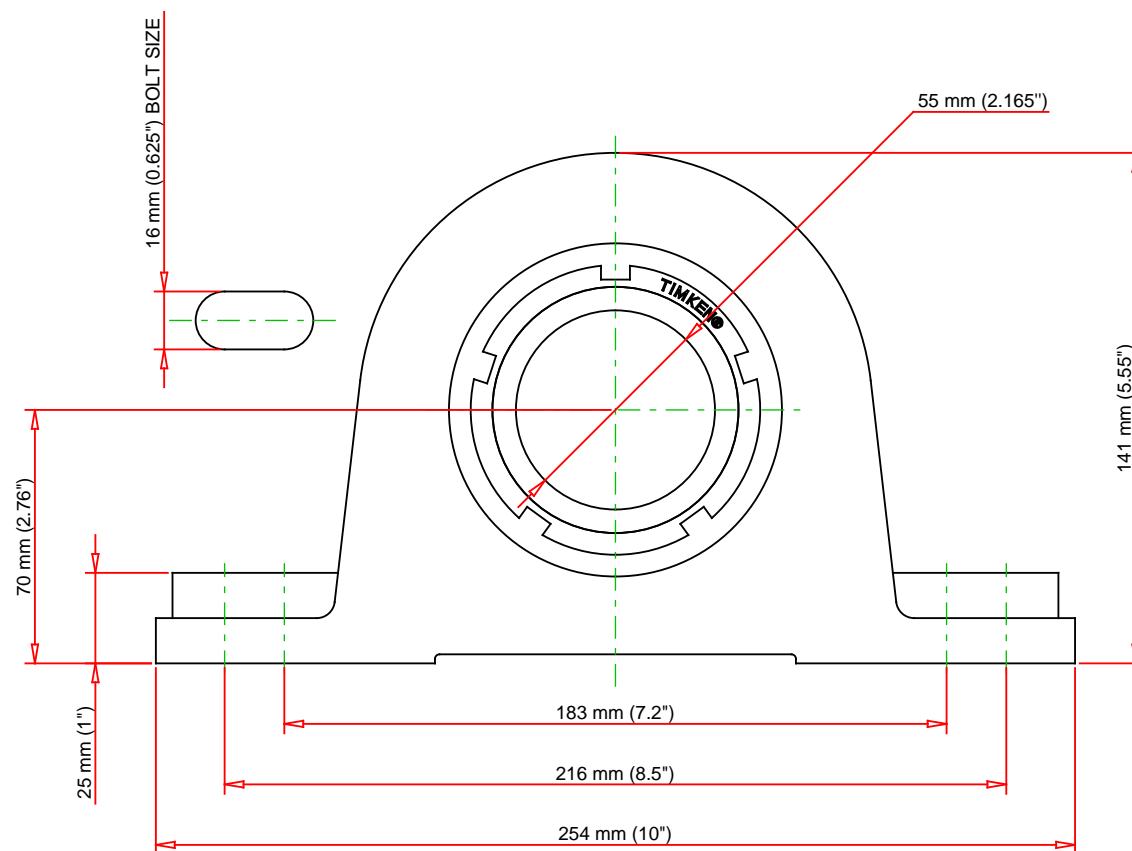
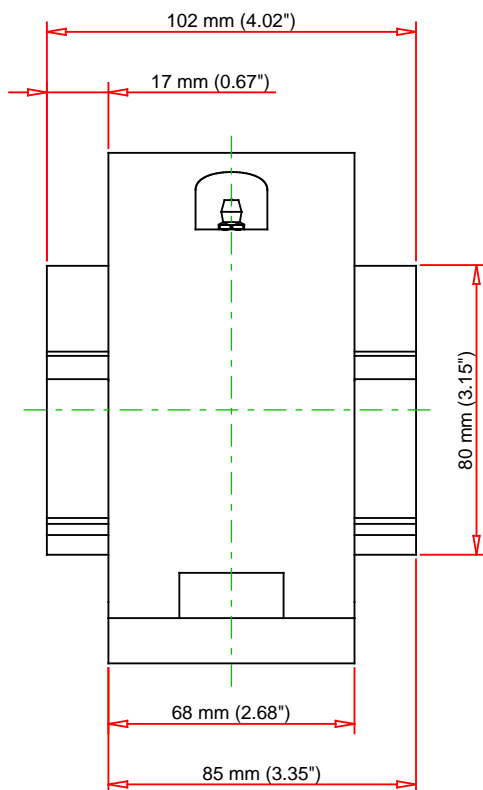

Note: Section View not to Scale

C - Dynamic Load	38100	lbf	169000	N
C0 - Static Load	39000	lbf	174000	N
Weight	29	lb	13.2	kg
Max. Speed T-Seals & Grease	3000	rpm		
Rad. Clearance - Max.	0.0037			

TIMKEN

THE TIMKEN COMPANY
NORTH CANTON, OHIO USA

QVVSN12V055S
Double V-Lock Two-Bolt Pillow Block

Every reasonable effort has been made to ensure the accuracy of the information contained in this writing, but no liability is accepted for errors, omissions or for any other reason.

FOR DISCUSSION ONLY