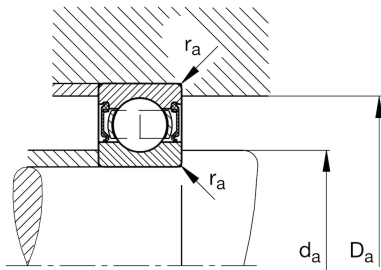
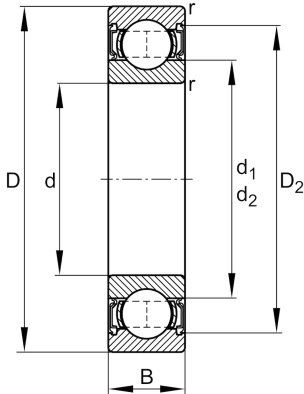

**FAG****61902-2RSR**

Deep groove ball bearing

Deep groove ball bearing 619..-2RSR, single row, seals, steel sheet metal cage

Technical information

**Main Dimensions & Performance Data**

d	15 mm	Bore diameter
D	28 mm	Outside diameter
B	7 mm	Width
C_r	4,330 N	Basic dynamic load rating, radial
C_{0r}	2,250 N	Basic static load rating, radial
C_{ur}	132 N	Fatigue load limit, radial
n_G	14,200 1/min	Limiting speed
$\approx m$	0.016 kg	Weight

Mounting dimensions

$d_{a \min}$	17 mm	Minimum diameter shaft shoulder
$D_{a \max}$	26 mm	Maximum diameter of housing shoulder
$r_{a \max}$	0.3 mm	Maximum fillet radius

Dimensions

r_{\min}	0.3 mm	Minimum chamfer dimension
D_2	25.3 mm	Caliber diameter outer ring
d_1	18.8 mm	Shoulder diameter inner ring

Temperature range

T_{\min}	-30 °C	Operating temperature min.
T_{\max}	100 °C	Operating temperature max.

Calculation factors

f_0	14.3	Calculation factor
-------	------	--------------------