



The Timken Company

4500 Mt Pleasant St. NW

N. Canton, OH 44720

Phone: (234) 262-3000

E-Mail: CustomerCAD@timken.com • **Web site:** www.timken.com

Bearing Unit - Adapter Sleeve UKFC210 - HE2310, UKFC 200 Piloted Round Flanged Mounted Bearings - Adapter Sleeve Locking

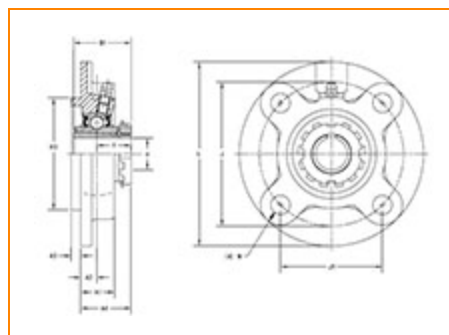

[Specifications](#) | [Dimensions](#) | [Basic Load Ratings](#)

Specifications

Bearing Unit - Adapter Sleeve	UK210 - HE2310
Shaft Size d	1 3/4 in
Adapter Sleeve Number¹	HE2310
Locking Style	Adapter Sleeve Locking
Housing Construction	Round Flange

Dimensions

Total Height L	165.000 mm 6.496 in
-----------------------	------------------------



Pilot Outside Diameter H3 110 mm

Bolt Circle Diameter J 138 mm
5.433 in

Bolt Hole Spacing J1 97.6 mm
3.843 in

Bolt Hole Size N 16 mm
0.63 in

Flange Width A1 28 mm
1.102 in

Center of Bearing from Housing End A2 10 mm
0.394 in

Pilot Width A3 12 mm

Center of Bearing from Bearing End Y 30 mm
1.181 in

Dimension A4 40 mm
1.563 in

Dimension B1 55 mm
2.165 in

Basic Load Ratings

Static Load Rating 23300 N
5238 lbf

Dynamic Load Rating 35100 N
7891 lbf

¹ Purchase the Adapter Sleeve separately

