



The Timken Company

4500 Mt Pleasant St. NW

N. Canton, OH 44720

Phone: (234) 262-3000

E-Mail: CustomerCAD@timken.com • **Web site:** www.timken.com

Bearing Unit - Adapter Sleeve UKFC209 - H2309, UKFC 200 Piloted Round Flanged Mounted Bearings - Adapter Sleeve Locking

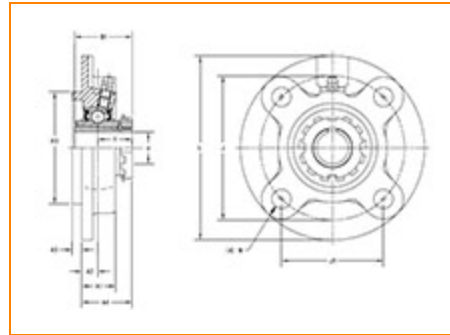

[Specifications](#) | [Dimensions](#) | [Basic Load Ratings](#)

Specifications

Bearing Unit - Adapter Sleeve	UK209 - H2309
Shaft Size d	40 mm
Adapter Sleeve Number¹	H2309
Locking Style	Adapter Sleeve Locking
Housing Construction	Round Flange

Dimensions

Total Height L	160.000 mm 6.2990 in
-----------------------	-------------------------



Pilot Outside Diameter H3 105 mm

Bolt Circle Diameter J 132 mm
5.197 in

Bolt Hole Spacing J1 97.6 mm
3.843 in

Bolt Hole Size N 16 mm
0.63 in

Flange Width A1 26 mm
1.024 in

Center of Bearing from Housing End A2 10 mm
0.394 in

Pilot Width A3 12 mm

Center of Bearing from Bearing End Y 29 mm
1.142 in

Dimension A4 39 mm
1.531 in

Dimension B1 50 mm
1.969 in

Basic Load Ratings

Static Load Rating 21300 N
4788 lbf

Dynamic Load Rating 34100 N
7666 lbf

¹ Purchase the Adapter Sleeve separately

