

KWVE20-B-V1-G3

Recirculating ball bearing carriage

Schaeffler ID:
0124487610240

Carriages KWVE...-B, standard carriage,
four-row, full complement ball set

Technical information

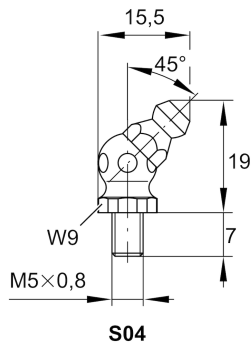

Main Dimensions & Performance Data

H	30 mm	height system
B	63 mm	width carriage
L	71.4 mm	overall length carriage
C	13,100 N	dynamic load rating
C ₀	27,000 N	dynamic load rating
M _{0x}	332 Nm	static moment rating about X axis
M _{0y}	240 Nm	static moment rating about Y axis
M _{0z}	240 Nm	static moment rating about Z axis
	0.465 kg	Weight

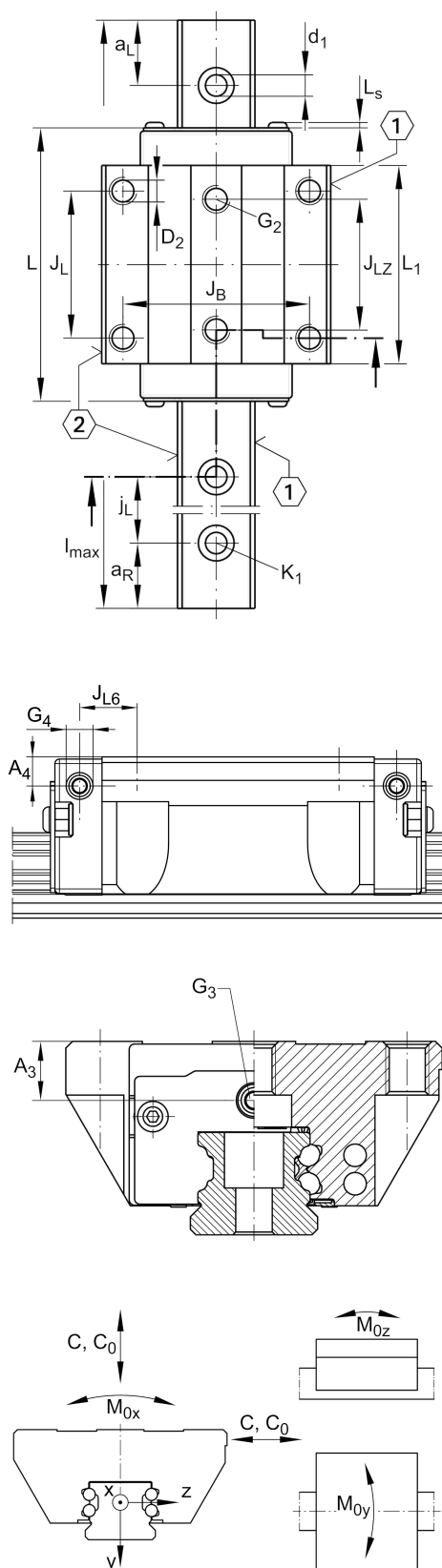

Mounting dimensions

A ₁	21.5 mm	
J _B	53 mm	
b	20 mm	width rail
A ₂	5 mm	
L ₁	50.4 mm	
L _S	1.3 mm	
J _L	40 mm	
J _{LZ}	35 mm	
H ₁	4.5 mm	
H ₄	11 mm	
H ₅	5.25 mm	
T ₅	10 mm	
T ₆	7.5 mm	
G ₂	M6	fixing screws below (DIN ISO 4762-12.9)
G2 M _A	10 Nm	maximum tightening torque
K ₃	M5	fixing screws below (DIN ISO 4762-12.9)
K3 M _A	10 Nm	maximum tightening torque
K ₆	M5	fixing screws below (DIN ISO4762-12.9)
K6 M _A	10 Nm	maximum tightening torque
D ₂	5.5 mm	
A ₃	7.7 mm	position lubrication connector
G ₃	M5	lubrication connector
t G ₃	7 mm	maximum permissible screw depth for lubrication connectors
A ₄	4.6 mm	position lubrication connector
G ₄	M5 mm	lubrication connector
t G ₄	5.5 mm	maximum permissible screw depth for lubrication connectors
J _{L6}	9.4 mm	position lubrication connector

The datasheet is only an overview of dimensions and basic load ratings of the selected product. Please always observe all further information and guidelines for this product. For further information you can use the contact form on our website.

