

Jubilee®

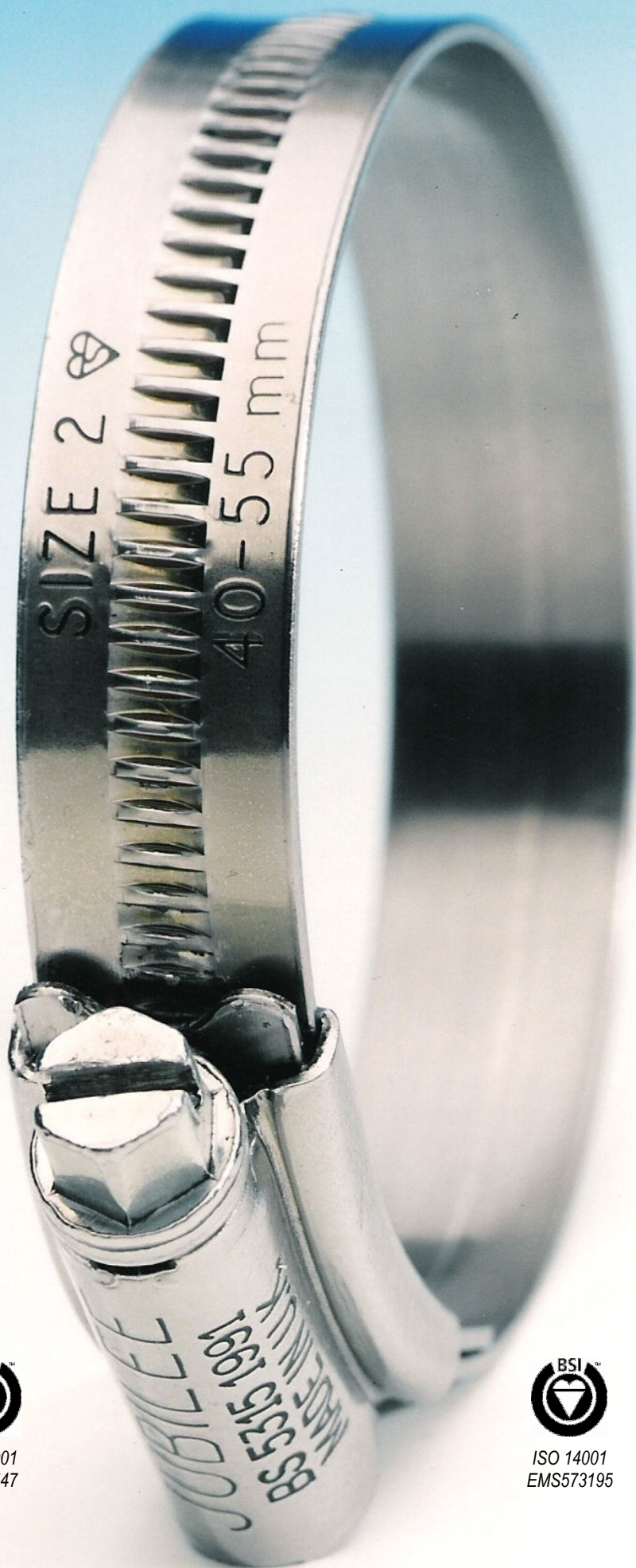

BS 5315
KM06246



ISO 9001
FM00547



ISO 14001
EMS573195





The comprehensive range of products enables users everywhere to be confident that Jubilee® has a clip to suit their application.

Jubilee® the original – beware of imitations!

All Jubilee® products conform to the latest EU Directives; furthermore we aim to work in a socially, ethically and environmentally responsible way ensuring that our manufacturing processes conform to environmental legislations. We continue to decrease the effect that our manufacturing output has on the environment and improve our packaging waste year on year, recycling as much as is possible.



Test Performance

Ultimate Breaking Torque Graph

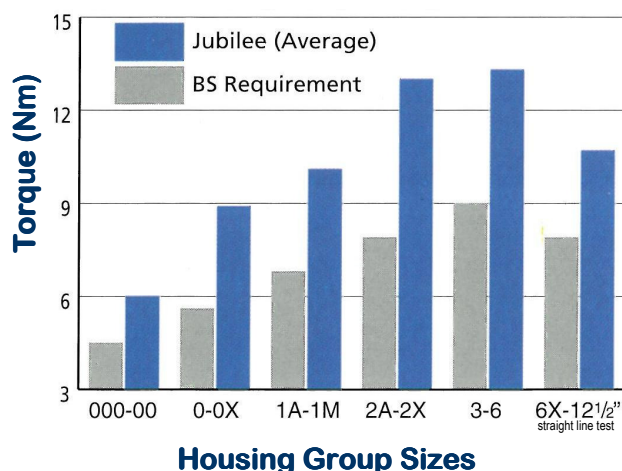

Maximum Pressure Graph

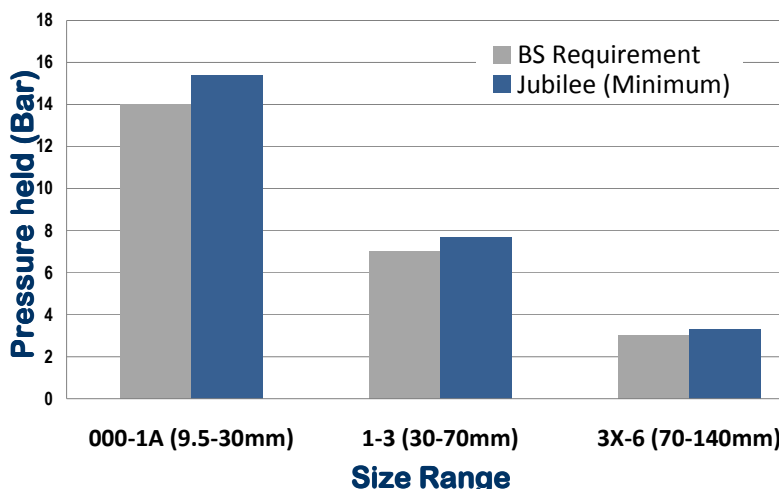

The performance of hose clips is determined by the hose type, spigot, tightening torque and hose working pressures – phone for technical advice.

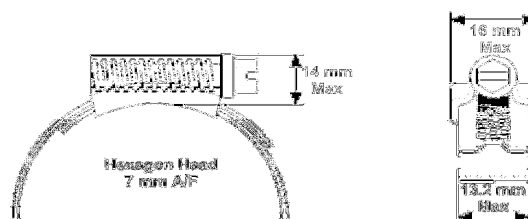



Mild Steel Zinc Protected & Stainless Steel Clips



JUBILEE® RANGE

Size Ref.	BS No.	Adjustment		Band Width (mm)	Band Thickness (mm)	Carton Qty.	Pack Qty.	Weights Per 100 (kgs)	Size Ref.
		mm	Inches						
000	12	9.5- 12	3/8- 1/2	9.9	0.762	10	100	1.2	000
M00	16	11- 16	1/2-5/8	9.9	0.762	10	100	1.3	M00
00	20	13- 20	1/2-3/4	9.9	0.762	10	100	1.3	00
0	22	16- 22	5/8- 7/8	13	0.914	10	100	2.2	0
0X	25	18- 25	3/4- 1	13	0.914	10	100	2.3	0X
1A	30	22- 30	7/8- 1 1/8	13	0.914	10	100	2.8	1A
1	35	25- 35	1- 1 3/8	13	0.914	10	100	3.0	1
1X	40	30- 40	1 1/8- 1 5/8	13	0.914	10	100	3.1	1X
1M	45	32- 45	1 1/4- 1 3/4	13	0.914	10	100	3.2	1M
2A	50	35- 50	1 3/8- 2	13	0.914	10	100	3.9	2A
2	55	40- 55	1 5/8- 2 1/8	13	0.914	10	100	4.0	2
2X	60	45- 60	1 3/4- 2 3/8	13	0.914	10	100	4.2	2X
3	70	55- 70	2 1/8- 2 3/4	13	0.914	10	50	4.5	3
3X	80	60- 80	2 3/8- 3 1/8	13	0.914		150	4.8	3X
4	90	70- 90	2 3/4- 3 1/2	13	0.914		125	5.1	4
4X	100	85- 100	3 1/4- 4	13	0.914		100	5.4	4X
5	120	90- 120	3 1/2- 4 3/4	13	0.914		100	6.0	5
6	140	110- 140	4 3/8- 5 1/2	13	0.914		75	6.9	6
6X	150	120- 150	4 3/4- 5 7/8	13	0.914		50	7.1	6X
7	165	135- 165	5 1/4- 6 1/2	13	0.914		50	7.6	7
7 1/2	190	158- 190	6 1/4- 7 1/2	13	0.914		50	8.5	7 1/2
8 1/2	216	184- 216	7 1/4- 8 1/2	13	0.914		50	9.1	8 1/2
9 1/2	242	210- 242	8 1/4- 9 1/2	13	0.914		50	9.9	9 1/2
10 1/2	267	235- 267	9 1/4- 10 1/2	13	0.914		50	10.5	10 1/2
11 1/2	292	260- 292	10 1/4- 11 1/2	13	0.914		50	11.3	11 1/2
12 1/2	318	286- 318	11 1/4- 12 1/2	13	0.914		50	12.2	12 1/2

MATERIAL SPECIFICATION

Material	Mild Steel	304 Stainless Steel	316 Stainless Steel
Band:	BS 1449 Pt. 1	All components	All components
Housing:	BS 1449 Pt. 1	Type 304 (A2)	Type 316 (A4)
Screw:	BS 3111	BS 1449 Pt. 2	BS 1449 Pt. 2
Zinc Finish:	Meets BS 7479 48 hrs NSS	DIN 1.4301	DIN 1.4401

For larger sizes please contact us.





Driver Selection

[Top: Jubilee Flexidriver® Middle: 160mm Jubilee Clipdriver® Bottom: 95mm Jubilee Clipdriver®]



Jubilee Flexidriver® - flexible shaft tool for efficient and rapid adjustment of Jubilee clips

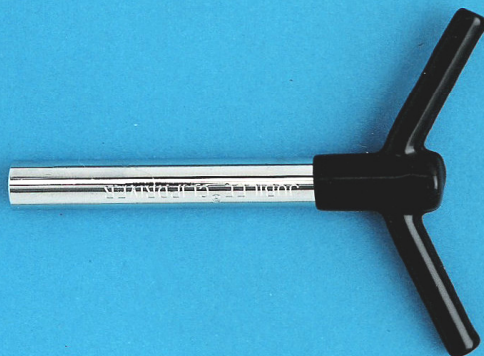

Jubilee Clipdriver® - rigid shaft tool for easy adjustment of Jubilee clips.

Available in 95mm & 160mm lengths.

High precision tools specifically designed for efficient, rapid and easy adjustment of Jubilee clips to their optimum torque. The invaluable Flexidriver with flexible shaft has been designed to reach all those awkward places while the Clipdriver has a rigid shaft and is available in two lengths (95mm & 160mm).

The 'drivers' are high quality precision tools incorporating a 7mm A/F socket head specially designed for Jubilee® hose clips.

Suitable for most workshops, maintenance and DIY applications.

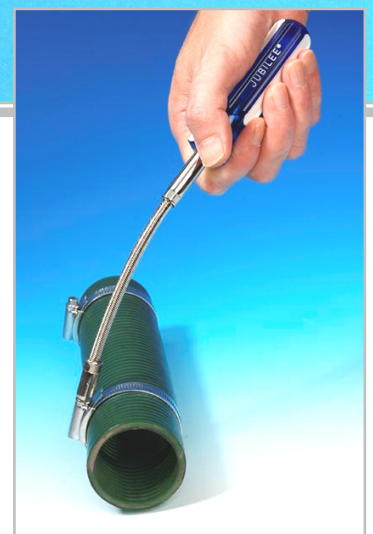



Superclamps

Heavy Duty Bolt Clamps

for use on heavy duty hoses



Used for demanding applications, the Jubilee Superclamp is easily adjusted by a single nut and bolt.

Available in:-

- Mild steel zinc plated
- 304 (A2) (W4) stainless steel
- 316 (A4) (W5) stainless steel



Mild steel zinc plated product specification:-

Part No.	Min-Max Dia. mm	Screw DIN 933 [A]	Band Width mm [B]	Band Thickness mm [C]	Tightening Torque Nm	Screw Head A/F mm [D]	Qty. Per Box	Weight Per Box Kgs
JSC019	17-19	M5	18	0.6	6	8	100	2.8
JSC022	20-22						100	2.9
JSC025	23-25						100	3.1
JSC028	26-28						100	3.2
JSC031	29-31						100	3.3
JSC035	32-35	M6	20	1	8	10	100	7.3
JSC039	36-39						90	6.7
JSC043	40-43						75	5.7
JSC047	44-47						75	5.8
JSC051	48-51						70	6.0
JSC055	52-55						60	5.0
JSC059	56-59						50	4.4
JSC063	60-63	M8	25	1.5	25	13	40	3.6
JSC067	64-67						60	11.8
JSC073	68-73						52	10.9
JSC079	74-79						48	10.7
JSC085	80-85						44	9.1
JSC091	86-91						36	7.2
JSC097	92-97						32	7.3
JSC103	98-103						24	5.6
JSC112	104-112						24	5.9
JSC121	113-121						20	5.0
JSC130	122-130	M8	25	1.8	25	13	16	4.3
JSC139	131-139						16	4.4
JSC148	140-148						12	3.8
JSC161	149-161						8	2.5
JSC174	162-174						42	14.2
JSC187	175-187						28	10.2
JSC200	188-200						28	10.2
JSC213	201-213						28	10.5
JSC226	214-226						14	6.0
JSC239	227-239						14	6.0
JSC252	240-252						14	6.3
JSC265	253-265						14	6.3

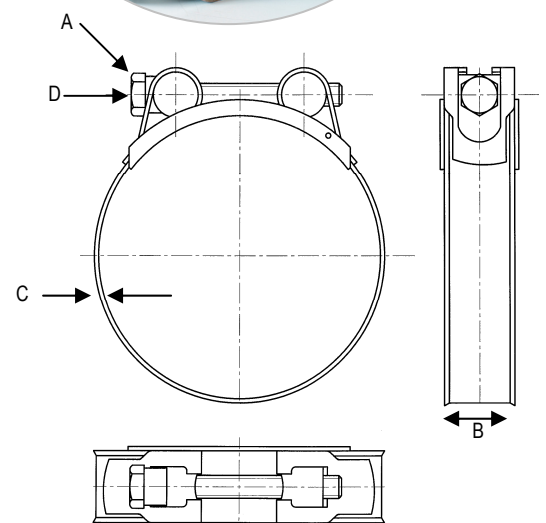

Jubilee® is a registered trade mark of L Robinson & Co (Gillingham) Limited.

304 & 316 S/S Clamps – Please contact us for the full product specification





High Torque

For applications requiring extra high levels of tightening torque

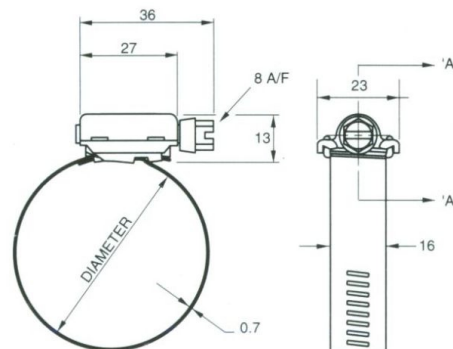

All dimensions in mm

SECTION 'A-A'

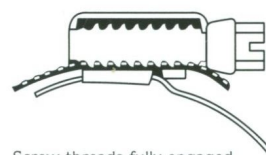

Screw threads fully engaged

- Twice the tightening torque of standard worm drive hose clips which creates more than twice the band tension for those stubborn leakage and high vibration applications.
- All stainless steel construction.
- Breaking torque of Jubilee high torque is 17 Nm comparable to conventional 'T' bolt clamp of equal size.
- Recommended tightening torque 11.9 Nm (106 lb in).
- Jubilee High Torque clips for applications that require extra high levels of tightening torque.
- They can be used on hose applications such as spiral wound wire reinforced suction hose.
- High Torque clips are appropriate in those heavy duty situations where the general British Standard product is not suitable.

Ask our Sales Department for further information.

MATERIAL SPECIFICATION

Stainless Steel

Band:	BS/AISI 304 A2
Housing:	BS/AISI 304 A2
Screw:	BS/AISI 410

Size No.	Working Diameter		Box Quantities
	mm	Inches	
HT035	20- 35	3/4 - 1 3/8	50
HT040	25- 40	1 - 1 5/8	50
HT045	25- 45	1 - 1 3/4	50
HT050	30- 50	1 1/4 - 2	50
HT070	40- 70	1 5/8 - 2 3/4	50
HT080	60- 80	2 3/8 - 3 1/8	50
HT095	70- 95	2 3/4 - 3 3/4	50
HT100	80-100	3 1/8 - 4	50
HT120	90-120	3 1/2 - 4 3/4	50
HT140	110-140	4 3/8 - 5 1/2	50
HT160	130-160	5 1/8 - 6 1/4	50
HT180	150-180	5 7/8 - 7	50
HT200	170-200	6 3/4 - 7 7/8	25
HT220	190-220	7 1/2 - 8 5/8	25
HT240	210-240	8 1/4 - 9 1/2	25
HT260	230-260	9 - 10 1/4	25
HT280	250-280	9 7/8 - 11	25
HT300	270-300	10 5/8 - 11 3/4	25
HT320	290-320	11 3/8 - 12 1/2	25
HT340	310-340	12 1/4 - 13 3/8	25
HT360	330-360	13 - 14 1/8	25
HT380	350-380	13 3/4 - 15	25
HT400	370-400	14 1/2 - 15 3/4	25
HT420	390-420	15 3/8 - 16 1/2	25
HT440	410-440	16 1/8 - 17 1/4	25
HT460	430-460	17 - 18 1/8	25
HT480	450-480	17 3/4 - 18 7/8	25
HT500	470-500	18 1/2 - 19 5/8	25





Multiband

“SNIP THE CLIP”

Don't get caught out in an emergency.....

- Choose Jubilee® Multiband to make a clip to any size
- Quick, versatile and handy
- Simply cut to length, add a housing, insert a screw and tighten to size

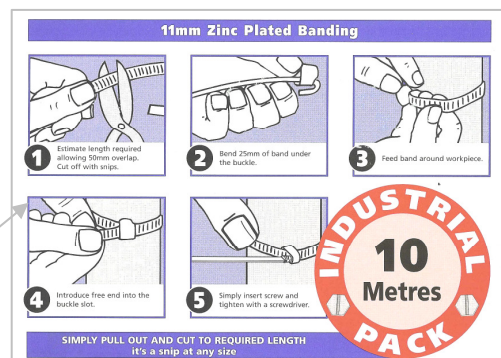

Did you know?..... The Jubilee® Multiband range is available in:-

11MM ZINC PLATED MILD STEEL:-

- MB1701 Banding in dispensers containing 10 metres
- MB1702 Banding in dispensers containing 30 metres
- MB1703 Housings/screws in boxes containing 100 sets
- MB1704 Housings/screws in boxes containing 25 sets
- MB1705 Housings/Allen socket screws in boxes containing 100 sets
- MB1706 Captive screws in boxes containing 100
- MB1708 Handy Pack (10 metres of band with 25 housings/screws)

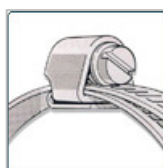

Slotted Screw
11mm zinc plated mild steel or stainless steel.

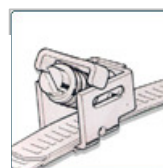

Captive Screw
11mm zinc plated mild steel or stainless steel.

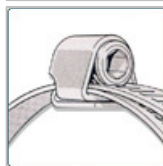

Allen Screw
11mm zinc plated mild steel or stainless steel. (3/16")

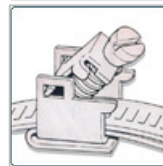

Flip/Lock Screw
7mm all stainless steel.

11MM STAINLESS STEEL (304):-

- MB1802 Banding in dispensers containing 30 metres
- MB1803 Housings/screws in boxes containing 100 sets
- MB1804 Housings/Allen socket screws in boxes containing 100 sets
- MB1805 Captive screws in boxes containing 100
- MB1806 Handy Pack (10 metres of band with 25 housings/screws)

7MM SLIMLINE STAINLESS STEEL (304):-

- MB1601 Banding in dispensers containing 25 metres
- MB1602 Banding in dispensers containing 50 metres
- MB1603 Flip/Lock housings/screws in boxes containing 25 sets
- MB1604 Flip/Lock housings/screws in boxes containing 100 sets

Every toolbox should have a versatile Multiband handy pack containing all you need to make your own fastener





'O' Clips

2-Ear Clamps from Tube



2-Ear clamp widely used for maintenance and OEM applications. Mainly used on air, fluid, gas and steam lines, also suitable for low pressure hydraulic applications.

Ideal for where the requirement is for a neat finish with no bulky housing to catch on obstructions.

Pincers are used to crimp the ears of the clamps and affect a proper seal.

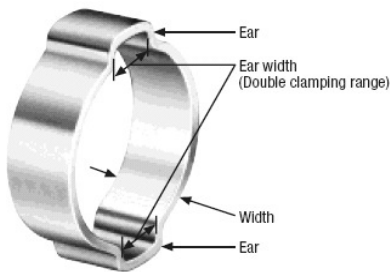

Available in:

- Mild steel zinc plated, clear passivated
- Stainless steel 304 (special order)

Pincers:



Normal Closing (Part No. 1098)
Side Closing* (Part No. 1099)

*For use when access to ear is difficult

Part No.	Theoretical Clamping Range mm	Width mm	Thickness mm	Inner Width of Ear mm	Polybag Pack Qty.
OC0041	3.1-4.1	3.5	0.5	1.5	50
OC0045	3.5-4.5	3.5	0.6	1.5	50
OC0305	3.0-5.0	5.0	0.7	2.5	50
OC0507	5.0-7.0	6.0	0.7	3.0	50
OC0709	7.0-9.0	7.0	1.0	3.2	50
OC0811	8.0-11.0	7.0	1.0	4.5	50
OC0911	9.0-11.0	7.0	1.0	3.5	50
OC1113	11.0-13.0	7.0	1.0	3.5	50
OC1315	13.0-15.0	7.5	1.0	4.0	50
OC1517	15.0-17.0	8.0	1.2	5.0	50
OC1518	15.0-18.0	8.0	1.2	5.0	50
OC1619	16.0-19.0	8.0	1.2	5.0	50
OC1720	17.0-20.0	8.5	1.2	6.0	50
OC1922	19.0-22.0	9.0	1.5	6.5	50
OC2023	20.0-23.0	9.0	1.5	6.5	50
OC2225	22.0-25.0	10.0	1.5	6.5	25
OC2327	23.0-27.0	10.0	1.5	7.0	25
OC2528	25.0-28.0	10.0	1.5	6.5	25
OC2731	27.0-31.0	10.0	1.5	7.5	25
OC2831	28.0-31.0	10.0	1.5	6.5	25
OC3134	31.0-34.0	10.0	1.5	7.5	25
OC3437	34.0-37.0	10.0	1.5	8.0	25
OC3740	37.0-40.0	10.0	1.5	8.0	25
OC4043	40.0-43.0	10.0	1.5	8.5	25
OC4346	43.0-46.0	10.0	1.5	8.5	25





INSTALLATION

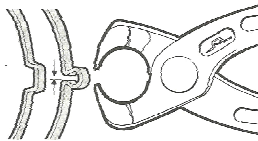

When installing 'O' clips, please note that each ear must be crimped as recommended to obtain a proper seal.

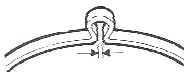

An incorrectly made installation may impair the best connection. If a clamp ear can be closed all the way, the clip size selected is probably too big and the next smaller size should be ordered.

HOW TO APPLY:

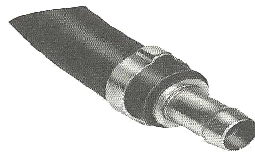

Position clip on hose as illustrated.

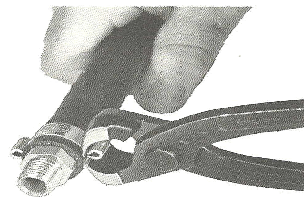

Give each ear a firm squeeze with your pincers.

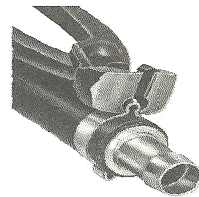

Where access to ear is difficult, use side closing pincers

HOW TO REMOVE:



Grip the outer edge of ear firmly and cut through it with either pincers.



Cut the ear by taking several small bites at its base with either pincers.



Then grip ear firmly and twist it off.

While both ears must be closed all the way to effect a proper seal, 2-ear clamps are best installed with one ear closed all the way first. The second ear is then closed so that the first ear opens slightly (gap to be approximately 1.5mm). This builds a resilient strength into the clamp in a spring-like action to hold against pressure, vibration and hose shrinkage due to temperature changes or ageing.

Rubber hose, plastic tubing, coaxial, rope and electrical cable are all easily clamped with this product.

The one piece design offers a positive, tamper-proof seal without damage to the hose.

Jubilee 'O' clips assure adequate closure and will compensate for tolerance variations in hose sizes.

'O' Clips Kit from Jubilee

The 'O' clip kit is a versatile and convenient dispenser for the most popular sizes of double ear clips.

The kit comes complete with/without normal closing pincer and is ideal for the user who needs to have a selection of different size clips available when on the move.

Total contents: 175 'O' clips +/- normal closing pincer

CONTENTS

Quantity	Part No.	Clamping Range	Nominal Size
20	OC0507	5- 7mm	1/4"
20	OC0709	7- 9mm	5/16"
20	OC0811	8-11mm	3/8"
20	OC0911	9-11mm	7/16"
20	OC1113	11-13mm	1/2"
15	OC1315	13-15mm	9/16"
20	OC1517	15-17mm	19/32"
20	OC1518	15-18mm	5/8"
20	OC1720	17-20mm	3/4"

Material: Mild steel zinc plated and clear passivated

Available: With pincer (OKP175MS) / without normal closing pincer (OK175MS)

Dimensions mm: 40 [H] x 270 [W] x 175 [D]





Juniors

(Nut & Bolt Clips)

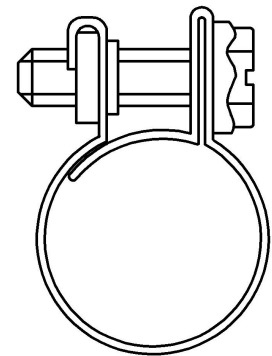

SPECIFICATION

Part No.	Adjustment	
NB0709	07-09mm	Tightening Torque: Maximum 1.2 Nm
NB0810	08-10mm	
NB0911	09-11mm	Screw: 7mm A/F
NB1012	10-12mm	
NB1113	11-13mm	Material: Zinc finished mild steel 304 Stainless steel*
NB1214	12-14mm	
NB1315	13-15mm	
NB1416	14-16mm	
NB1517	15-17mm	
NB1618	16-18mm	
NB1820	18-20mm	

Jubilee Juniors are ideal for use on petrol pipes and small bore hoses.

Small nut and bolt clips used mainly in the motor trade for securing petrol pipes, heater hoses and small bore applications etc. Manufactured in both zinc plated mild steel and 304 stainless steel with a standard 7mm hexagon headed screw.

Available in:-

- Zinc Finished Mild Steel
- 304 Stainless Steel

* Stainless steel available in sizes 0709 to 1416 only.





CV Clip Kit

Constant Velocity Boot Clip

Part No. CVK015SS



The new CV boot kit from Jubilee contains two sizes of clip which secure the rubber bellows to the CV joint and protect it from dirt and water as well as preventing lubricants from leaking.

Easy installation by interlocking the clip hooks on the outside of the band and crimping the ear to secure. The clip must be shaped prior to assembly.

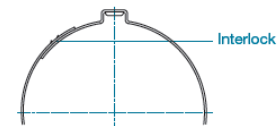

Both clip sizes have a choice of engagement positions to easily adjust to different diameters.

Assembly Instructions:-



Pre-shape clip.



Determine the required clamp length.

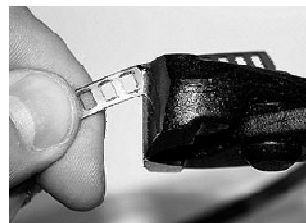

Cut to size and remove excess material. To avoid cuts smooth rough edges.



Fit clip over application. Engage interlocking hooks in tightest available position. Firmly crimp the ear with pincers.

Essential for MOT legislation.

CLIP / PACK GUIDE

Size Range (mm)	Width x Thickness (mm)	Quantity in Pack
25- 50	7 x 0.8	5
40-110	7 x 0.8	10

Manufactured in 304 (A2) (W4) grade stainless steel

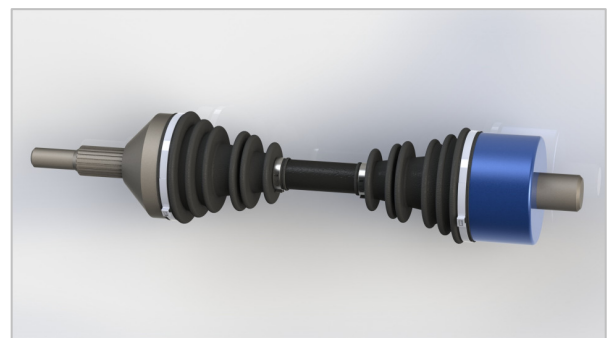



Wingspade®



This product range is manufactured to DIN Standard and has a plastic spade for ease of use.

Wingspades are typically used on garden hoses and domestic applications where there is a requirement for frequent tightening/loosening on low torque applications; mainly for the hardware market.

The range starts from 9.5mm and extends through to 70mm. Mild steel zinc protected clips only.

SIZE / PACK GUIDE

Size No.	Working Diameter (mm)	Polybag Qty.
WS012	9.5-12	20
WS016	11-16	20
WS020	13-20	20
WS025	16-25	20
WS032	20-32	20
WS040	25-40	20
WS050	32-50	20
WS060	40-60	20
WS070	50-70	20

Mild steel clips with their own spade for easy hand tightening

Material Specification

Band/Screw/Housing:	Mild Steel Zinc Protected
Wingspade:	Acetal Plastic
Colour:	Blue (For colours other than blue, minimum order quantity 10000 per size)





Clip Dispenser

Part No. CD100

The Indispensable Dispenser



The essential Jubilee Clip Dispenser not only holds individual Jubilee clips, but also the superb Jubilee Flexidriver tool (for correct adjustment of Jubilee clips).

The strong wire frame is easily re-stockable and the unit can be wall mounted or left free standing.

Eye catching and functional, watch your stock turn significantly increase with the Jubilee CD100.

Gain the upper hand with the CD100 – easy to see, easy to sell.

Available in:-

- Mild Steel Zinc Protected (CD100MS)
- 304 Stainless Steel (CD100SS)

DISPENSER CONTENTS

Size	Adjustment		Quantity
	mm	Inches	
000	9.5-12	3/8-1/2	10
M00	11-16	1/2-5/8	10
00	13-20	1/2-3/4	10
0	16-22	5/8-7/8	10
0X	18-25	3/4-1	10
1A	22-30	7/8-1 1/8	10
1	25-35	1-1 3/8	10
1X	30-40	1 1/8-1 5/8	10
1M	32-45	1 1/4-1 3/4	10
2A	35-50	1 3/8-2	10
Jubilee Flexidriver tool			1

100 Jubilee worm drive hose clips + 1 Jubilee Flexidriver
 Dimensions (mm): 340 [H] x 330 [W] x 180 [D]
 Total weight when full: 3.875 Kgs

90 years of engineering excellence in one clip





Handy Pack

Part No. HP100

Buy the top ten – in one hit!



The most popular sizes of premium brand Jubilee® hose clips individually boxed and handily packed in their own outer display carton.

100 clips in the ultimate point of sale package.



BS 5315
KM06246

Available in:

- Mild Steel Zinc Protected (HP100MS)
- 304 Stainless Steel (HP100SS)

PACK CONTENTS			
Size	Adjustment		Quantity
	mm	Inches	
000	9.5-12	3/8-1/2	10
M00	11-16	1/2-5/8	10
00	13-20	1/2-3/4	10
0	16-22	5/8-7/8	10
0X	18-25	3/4-1	10
1A	22-30	7/8-1 1/8	10
1	25-35	1-1 3/8	10
1X	30-40	1 1/8-1 5/8	10
1M	32-45	1 1/4-1 3/4	10
2A	35-50	1 3/8-2	10

100 Jubilee worm drive hose clips
Dimensions mm: 270 [H] x 310 [W] x 262 [D] (85 [H] when closed)
Total weight when full: 2.75 Kgs



The Handy Pack has a multitude of uses and can be used as a point of sale dispenser, stores assortment pack or mobile stock pack.

Order now and receive your outer display carton free.

Hoses demand Jubilee!





Workshop Pack

(Part no. HCP143)

The Ultimate Container



Versatile, re-usable container with eight separate compartments holding 143 assorted Jubilee worm drive hose clips (size 9.5 to 40mm).



BS 5315
KM06246

Available in:-

- **Mild Steel Zinc Protected** (HCP143MS)
- **304 Stainless Steel** (HCP143SS)

Premium brand Jubilee® clips are made from the finest quality materials and are recognised for proven reliability and ultimate performance.

Hoses demand 

PACK CONTENTS

Size	Adjustment	Quantity
000	9.5-12mm	24
M00	11-16mm	32
00	13-20mm	28
0	16-22mm	13
0X	18-25mm	14
1A	22-30mm	12
1	25-35mm	13
1X	30-40mm	7

143 Jubilee worm drive hose clips
Dimensions mm: 55 [H] x 330 [W] x 250 [D]
Total weight when full: 3.6 Kgs





Smart Dispenser

Part No. SD540

The Intelligent Selection

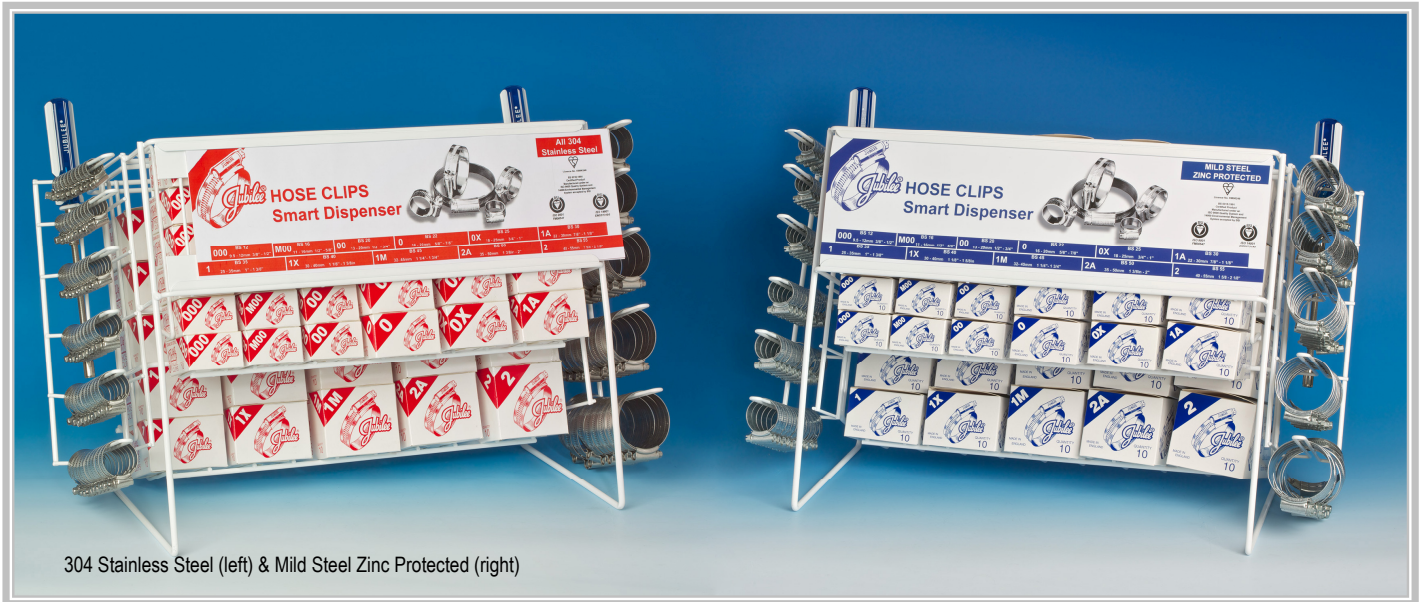

304 Stainless Steel (left) & Mild Steel Zinc Protected (right)

This versatile and convenient dispenser from Jubilee is stylish and unique by design. It dispenses Jubilee clips in boxes of ten and singly and also carries the much prized Flexidriver tool for easy adjustment of Jubilee clips.

- Increase your sales of Jubilee clips with this smart visible display
- Continually working to sell more Jubilee clips
- Keeps your stock tidy and ready for sale.



BS 5315
KM06246

Be sure to take advantage of every opportunity to make a sale - order a Smart Dispenser now for your trade counter or for use as a stock dispenser.

Available in:-

- Mild steel zinc protected (SD540MS)
- 304 Stainless steel (SD540SS)



CONTENTS			
Quantity	Size Ref.	BS No.	Adjustment mm
60	000	12	9.5-12
60	M00	16	11-16
60	00	20	13-20
50	0	22	16-22
50	0X	25	18-25
40	1A	30	22-30
50	1	35	25-35
50	1X	40	30-40
40	1M	45	32-45
40	2A	50	35-50
40	2	55	40-55
2	Jubilee Flexidrivers		
540 Jubilee worm drive hose clips + 2 Flexidrivers			
Total weight when full: 16.3 Kgs			
Dimensions (mm): 380 [H] x 580 [W] x 250 [D]			

Innovation in everyday use



Junior Assortment

The Essential Fastener Pack
for Small Bore Hoses

Part No. JA165



BOX CONTENTS

Part No.	Adjustment	Quantity
0709	07-09mm	25
0810	08-10mm	25
0911	09-11mm	25
1012	10-12mm	30
1113	11-13mm	30
1214	12-14mm	30

165 Assorted Jubilee Juniors (Nut & Bolt Clips)
Dimensions (mm): 40 [H] x 270 [W] x 175 [D]
Total weight when full: 1.35 Kgs

165 assorted nut and bolt clips (size 07 to 14mm) in a multipurpose, re-usable box divided into 9 compartments.

For use on petrol pipes and small bore hoses.

Available in:-

- Zinc Finished Mild Steel (JA165MS)
- 304 Stainless Steel (JA165SS)





Pocket Pack

Small in Size, **BIG** in Value

(Part no. PPAUTO)

Never again be caught out without that essential Jubilee clip to complete the job. This brand new compact container holds a useful selection of Jubilee clips for all those necessary hose joining applications as well as holding nut and bolt clips for joining small bore hoses and petrol pipes.

This small, plastic reusable container has 6 separate compartments and holds a selection of 16 assorted Jubilee worm drive hose clips (size 13 to 40mm) and 8 nut and bolt clips (size 7 to 13mm).



Sold in packs of 10

POCKET PACK CONTENTS

Qty.	Size Ref.	Adjustment mm	Inches
Jubilee® Worm Drive Hose Clips:-			
4	00	13-20	1/2-3/4
4	0	16-22	5/8-7/8
4	0X	18-25	3/4-1
2	1	25-35	1-13/8
2	1X	30-40	1 1/8-1 5/8
Nut & Bolt Clips:-			
4	NB0709	7-9	
4	NB1113	11-13	
Material Spec: Mild Steel Zinc Protected			
Part No: PPAUTO			
Dimensions [mm]: 39 [H] x 180 [W] x 150 [D]			
Total Weight when Full: .475 Kgs			





(Part no. PPIND)



Industrial Version

Sold in packs of 10



Stainless Steel Version

POCKET PACK CONTENTS			
Qty.	Size Ref.	Adjustment	
		mm	Inches
Jubilee® Worm Drive Hose Clips:-			
4	00	13-20	1/2-3/4
4	0	16-22	5/8-7/8
4	0X	18-25	3/4-1
2	1	25-35	1-13/8
2	1X	30-40	1 1/8-1 5/8
Material Spec: Mild Steel Zinc Protected			
Part No: PPIND			
Dimensions [mm]: 39 [H] x 180 [W] x 150 [D]			
Total Weight when Full: .450 Kgs			



BS 5315
KM06246

(Part no. PPSS)

POCKET PACK CONTENTS			
Qty.	Size Ref.	Adjustment	
		mm	Inches
Jubilee® Worm Drive Hose Clips:-			
4	000	9.5-12	3/8-1/2
2	0	16-22	5/8-7/8
2	0X	18-25	3/4-1
4	1	25-35	1-13/8
2	2	40-55	15/8-21/8
Material Spec: All 304 Stainless Steel			
Part No: PPSS			
Dimensions [mm]: 39 [H] x 180 [W] x 150 [D]			
Total Weight when Full: .450 Kgs			

Sold in packs of 10





Jubilee® Tools



Jubilee® Sales Support



beware of imitations!

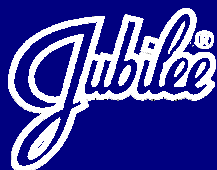

L Robinson & Co. (Gillingham) Limited
Owens Way, Gads Hill, Gillingham, Kent, ME7 2RS, England.

Tel: +44 (0)1634 281200
Fax: +44 (0)1634 280101
Email: sales@jubileeclips.co.uk
Website: www.jubileeclips.co.uk



We reserve the right, without prior notice, to alter the materials used to accord with new and/or improved specifications.

Jubilee®, Jubilee Flexidriver®, Jubilee Clipdriver®, Jubilee Wingspade® & Jubilee L-R® are registered trademarks of L Robinson & Co (Gillingham) Limited.