



**The Timken Company**

4500 Mt Pleasant St. NW

N. Canton, OH 44720

**Phone:** (234) 262-3000

**E-Mail:** [CustomerCAD@timken.com](mailto:CustomerCAD@timken.com) • **Web site:** [www.timken.com](http://www.timken.com)

## Part Number UCP322, UCP 300 Pillow Block Mounted Bearings - Set Screw Locking

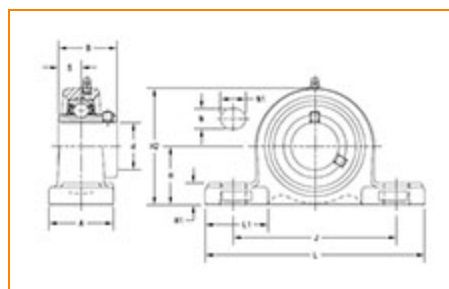

[Specifications](#) | [Dimensions](#) | [Basic Load Ratings](#)

### Specifications

<b>Bearing Number</b>	UC322
<b>Shaft Size d</b>	110 mm
<b>Locking Style</b>	Set Screw Locking
<b>Housing Construction</b>	Two-Bolt Pillow Block

### Dimensions

<b>Base to Center Height H</b>	150 mm 5.906 in
<b>Total Length L</b>	520 mm 20.472 in
<b>Housing Width A</b>	140.000 mm 5.512 in
<b>Bolt Hole Spacing J</b>	400 mm 15.748 in



<b>Bolt Hole Size N</b>	40 mm 1.575 in
<b>Bolt Hole Length N1</b>	55 mm 2.165 in
<b>Foot Height H1</b>	50 mm
<b>Total Height H2</b>	296 mm 11.654 in
<b>Dimension L1</b>	150 mm 5.906 in
<b>Inner Ring Width B</b>	117 mm 4.606 in
<b>Center of Bearing from End S</b>	46 mm 1.811 in

Basic Load Ratings

<b>Static Load Rating</b>	180000 N 40466 lbf
<b>Dynamic Load Rating</b>	205000 N 46086 lbf

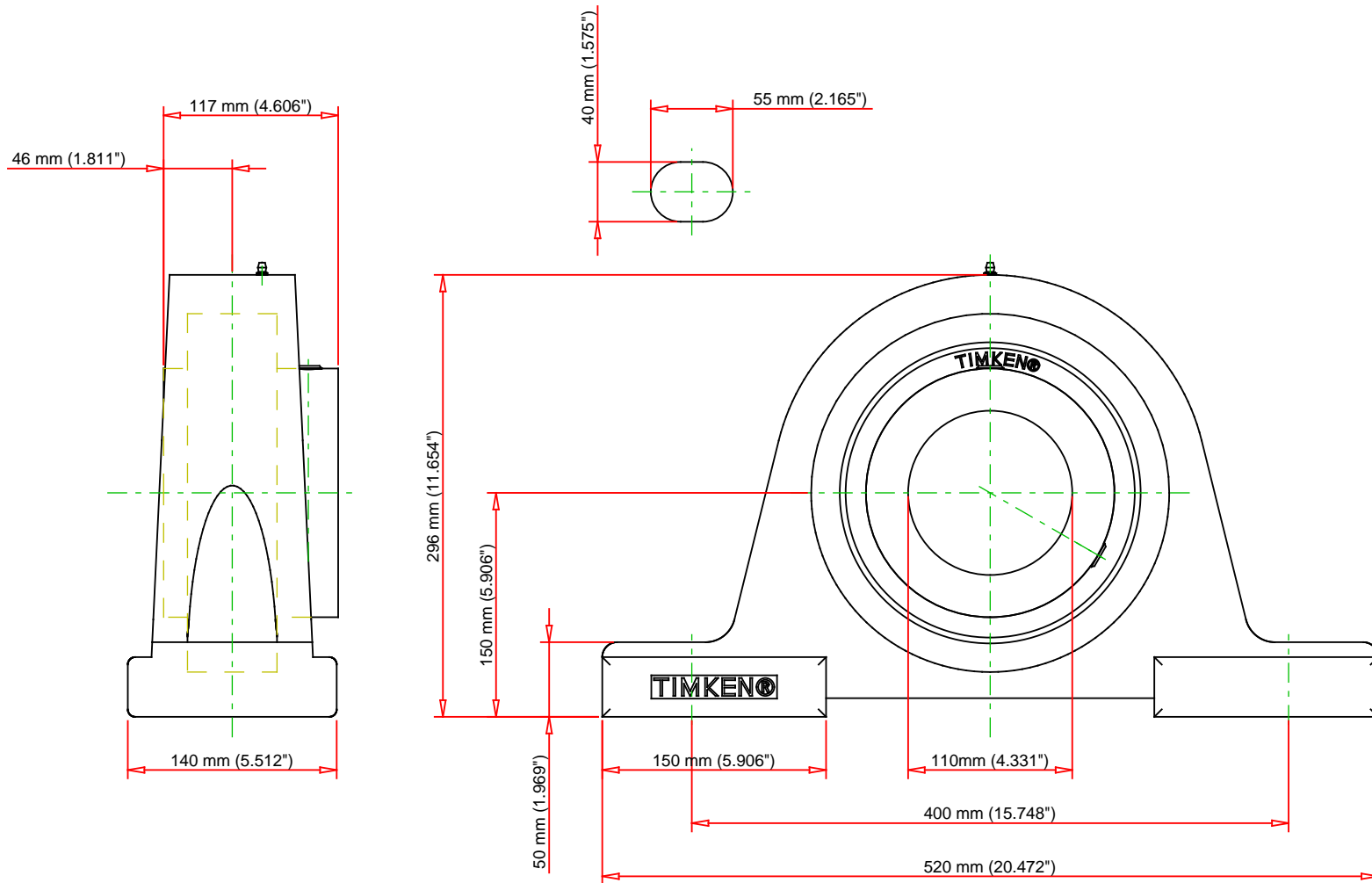

Bearing Number	UC322			
Load Ratings - C <sub>r</sub>	46086	lbf	205000	N
Load Ratings - C <sub>0r</sub>	40466	lbf	180000	N
Weight	97	lb	44	kg
Bolt Size	N/A			

**TIMKEN**

THE TIMKEN COMPANY  
NORTH CANTON, OHIO USA

**UCP322**

UCP 300 Pillow Block Mounted Bearings -  
Set Screw Locking

Every reasonable effort has been made to ensure the accuracy of the information contained in this writing, but no liability is accepted for errors, omissions or for any other reason.

**FOR DISCUSSION ONLY**