



The Timken Company

4500 Mt Pleasant St. NW

N. Canton, OH 44720

Phone: (234) 262-3000

E-Mail: CustomerCAD@timken.com • **Web site:** www.timken.com

Bearing Unit - Adapter Sleeve UKFC207 - H2307, UKFC 200 Piloted Round Flanged Mounted Bearings - Adapter Sleeve Locking

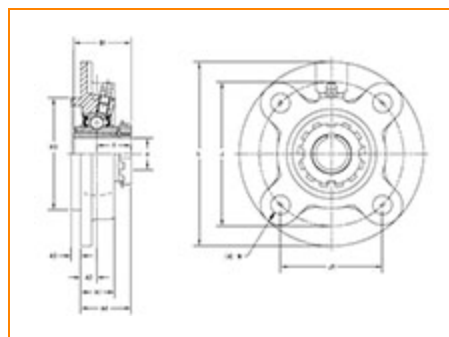

[Specifications](#) | [Dimensions](#) | [Basic Load Ratings](#)

Specifications

Bearing Unit - Adapter Sleeve	UK207 - H2307
Shaft Size d	30 mm
Adapter Sleeve Number¹	H2307
Locking Style	Adapter Sleeve Locking
Housing Construction	Round Flange

Dimensions

Total Height L	135 mm 5.315 in
-----------------------	--------------------

**Pilot Outside Diameter H3**

90 mm

Bolt Circle Diameter J110 mm
4.331 in**Bolt Hole Spacing J1**77.8 mm
3.063 in**Bolt Hole Size N**14 mm
0.551 in**Flange Width A1**26 mm
1.024 in**Center of Bearing from Housing
End A2**11 mm
0.433 in**Pilot Width A3**

8 mm

**Center of Bearing from Bearing
End Y**24 mm
0.945 in**Dimension A4**35 mm
1.375 in**Dimension B1**43 mm
1.693 in**Basic Load Ratings****Static Load Rating**15400 N
3462 lbf**Dynamic Load Rating**25700 N
5778 lbf¹ Purchase the Adapter Sleeve separately

