



The Timken Company

4500 Mt Pleasant St. NW

N. Canton, OH 44720

Phone: (234) 262-3000

E-Mail: CustomerCAD@timken.com • **Web site:** www.timken.com

Bearing Unit - Adapter Sleeve UKFC206 - H2306, UKFC 200 Piloted Round Flanged Mounted Bearings - Adapter Sleeve Locking

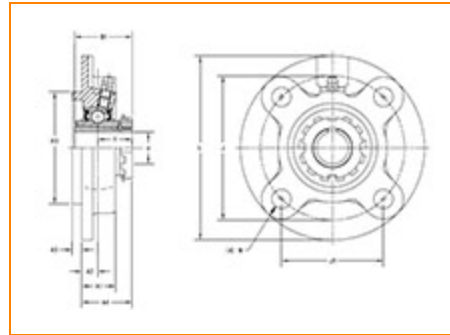

[Specifications](#) | [Dimensions](#) | [Basic Load Ratings](#)

Specifications

Bearing Unit - Adapter Sleeve	UK206 - H2306
Shaft Size d	25 mm
Adapter Sleeve Number¹	H2306
Locking Style	Adapter Sleeve Locking
Housing Construction	Round Flange

Dimensions

Total Height L	125 mm 4.921 in
-----------------------	--------------------

**Pilot Outside Diameter H3**

80 mm

Bolt Circle Diameter J100 mm
3.937 in**Bolt Hole Spacing J1**70.7 mm
2.783 in**Bolt Hole Size N**12 mm
0.472 in**Flange Width A1**23 mm
0.906 in**Center of Bearing from Housing
End A2**10 mm
0.394 in**Pilot Width A3**

8 mm

**Center of Bearing from Bearing
End Y**21.5 mm
0.846 in**Dimension A4**31.5 mm
1.25 in**Dimension B1**38 mm
1.496 in**Basic Load Ratings****Static Load Rating**11300 N
2540 lbf**Dynamic Load Rating**19500 N
4384 lbf¹ Purchase the Adapter Sleeve separately

