



The Timken Company

4500 Mt Pleasant St. NW

N. Canton, OH 44720

Phone: (234) 262-3000

E-Mail: CustomerCAD@timken.com • **Web site:** www.timken.com

Part Number UC328, UC 300 Wide Inner Ring Ball Bearings - Set Screw Locking

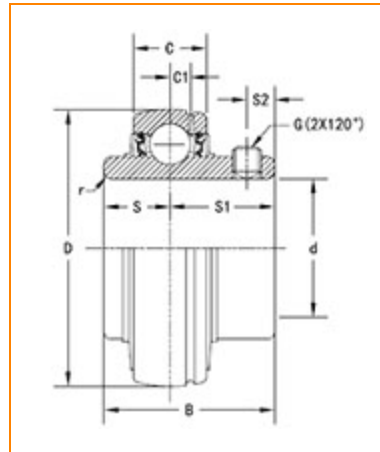

[Specifications](#) | [Dimensions](#) | [Basic Load Ratings](#)

Specifications

Bore Type	Cylindrical bore
Bearing Type	Ball Bearing
Shaft Size d	140 mm
Material	Bearing Steel
Locking Device	Set Screw Locking

Dimensions

Outside Diameter D	300 mm
Outside Ring Width C	72 mm
Radius r	4.0 mm
Groove Position C1	23 mm



Center of Bearing from End S	59 mm
Dimension S1	86 mm
Set Screw Distance S2	20 mm
Set Screw Size	M20×1.5
Number of Set Screws	2
Angle between Set Screws	120 °

Basic Load Ratings

Static Load Rating	246000 N
Dynamic Load Rating	253000 N

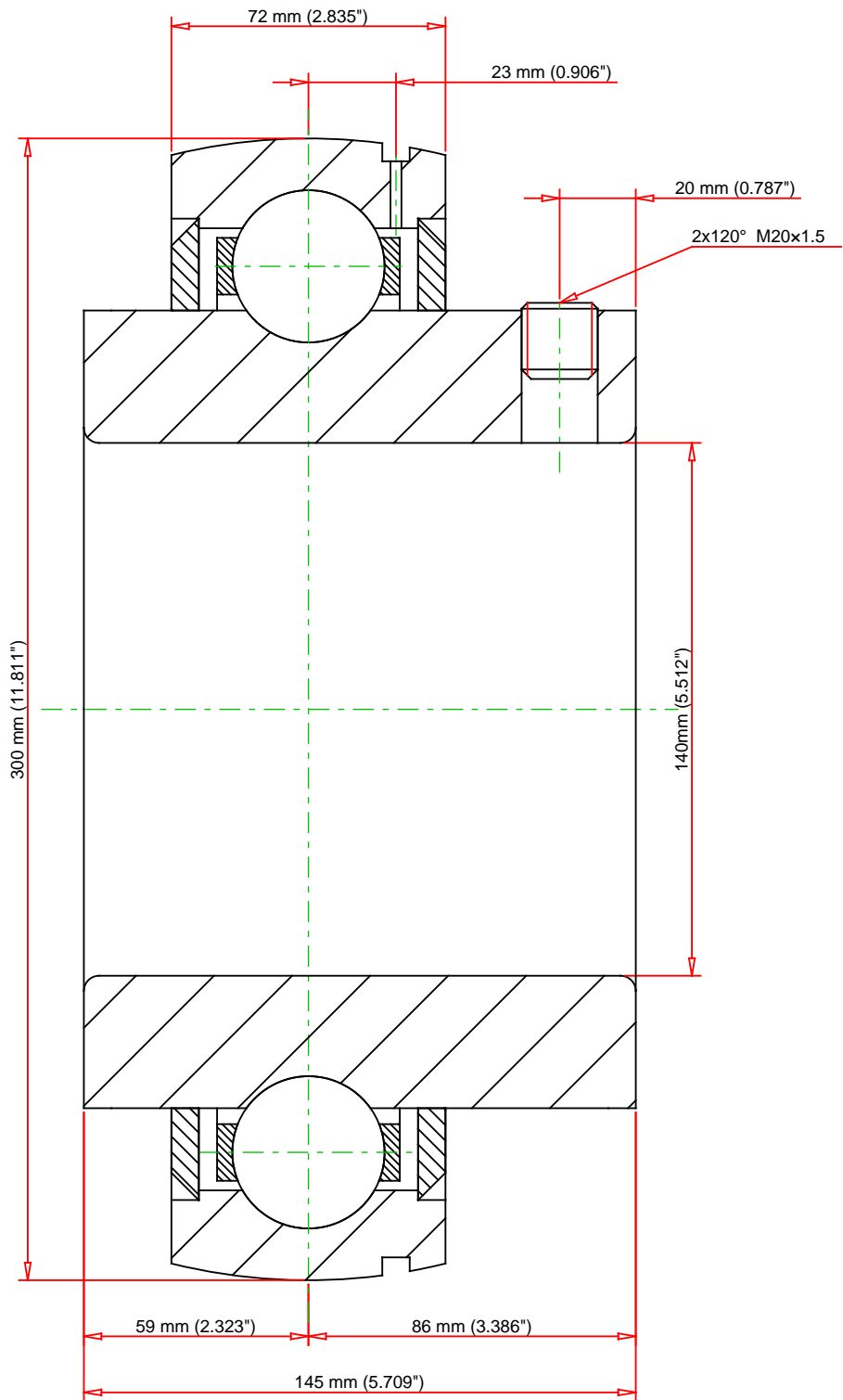

Weight	29.4 lb	13.3 kg		UC328 UC 300 Wide Inner Ring Ball Bearings - Set Screw Locking	
					THE TIMKEN COMPANY NORTH CANTON, OHIO USA
			Basic Load Ratings - C _r	56877 lbf	
			Load Ratings - C _{0r}	55304 lbf	246000 N
Every reasonable effort has been made to ensure the accuracy of the information contained in this writing, but no liability is accepted for errors, omissions or for any other reason.				FOR DISCUSSION ONLY	