



The Timken Company

4500 Mt Pleasant St. NW

N. Canton, OH 44720

Phone: (234) 262-3000

E-Mail: CustomerCAD@timken.com • **Web site:** www.timken.com

Bearing Unit - Adapter Sleeve UKFC205 - H2305, UKFC 200 Piloted Round Flanged Mounted Bearings - Adapter Sleeve Locking

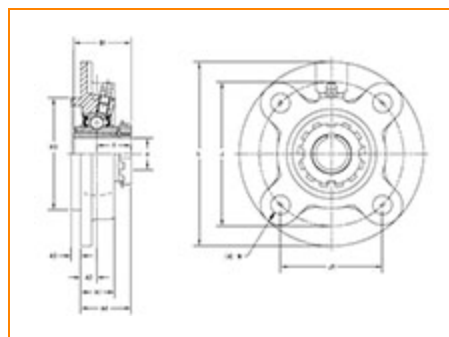

[Specifications](#) | [Dimensions](#) | [Basic Load Ratings](#)

Specifications

Bearing Unit - Adapter Sleeve	UK205 - H2305
Shaft Size d	20 mm
Adapter Sleeve Number¹	H2305
Locking Style	Adapter Sleeve Locking
Housing Construction	Round Flange

Dimensions

Total Height L	115.000 mm 4.528 in
-----------------------	------------------------

**Pilot Outside Diameter H3**

70 mm

Bolt Circle Diameter J90 mm
3.543 in**Bolt Hole Spacing J1**63.6 mm
2.504 in**Bolt Hole Size N**12 mm
0.472 in**Flange Width A1**21 mm
0.827 in**Center of Bearing from Housing
End A2**10 mm
0.394 in**Pilot Width A3**

6 mm

**Center of Bearing from Bearing
End Y**20 mm
0.787 in**Dimension A4**30 mm
1.188 in**Dimension B1**35 mm
1.3780 in**Basic Load Ratings****Static Load Rating**7900 N
1765 lbf**Dynamic Load Rating**14000 N
3147 lbf¹ Purchase the Adapter Sleeve separately

