



The Timken Company

4500 Mt Pleasant St. NW

N. Canton, OH 44720

Phone: (234) 262-3000

E-Mail: CustomerCAD@timken.com • **Web site:** www.timken.com

Part Number UC326, UC 300 Wide Inner Ring Ball Bearings - Set Screw Locking

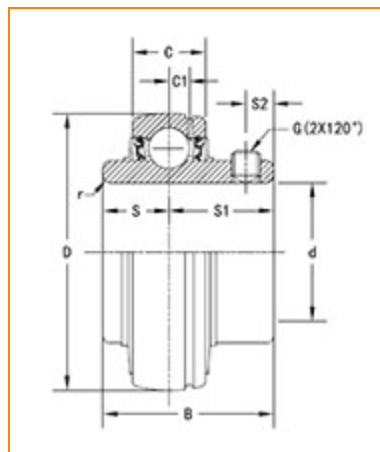

[Specifications](#) | [Dimensions](#) | [Basic Load Ratings](#)

Specifications

Bore Type	Cylindrical bore
Bearing Type	Ball Bearing
Shaft Size d	130 mm
Material	Bearing Steel
Locking Device	Set Screw Locking

Dimensions

Outside Diameter D	280 mm
Outside Ring Width C	68 mm
Radius r	4.0 mm
Groove Position C1	22 mm



Center of Bearing from End S	54 mm
Dimension S1	81 mm
Set Screw Distance S2	20 mm
Set Screw Size	M20×1.5
Number of Set Screws	2
Angle between Set Screws	120 °

Basic Load Ratings

Static Load Rating	214000 N
Dynamic Load Rating	229000 N

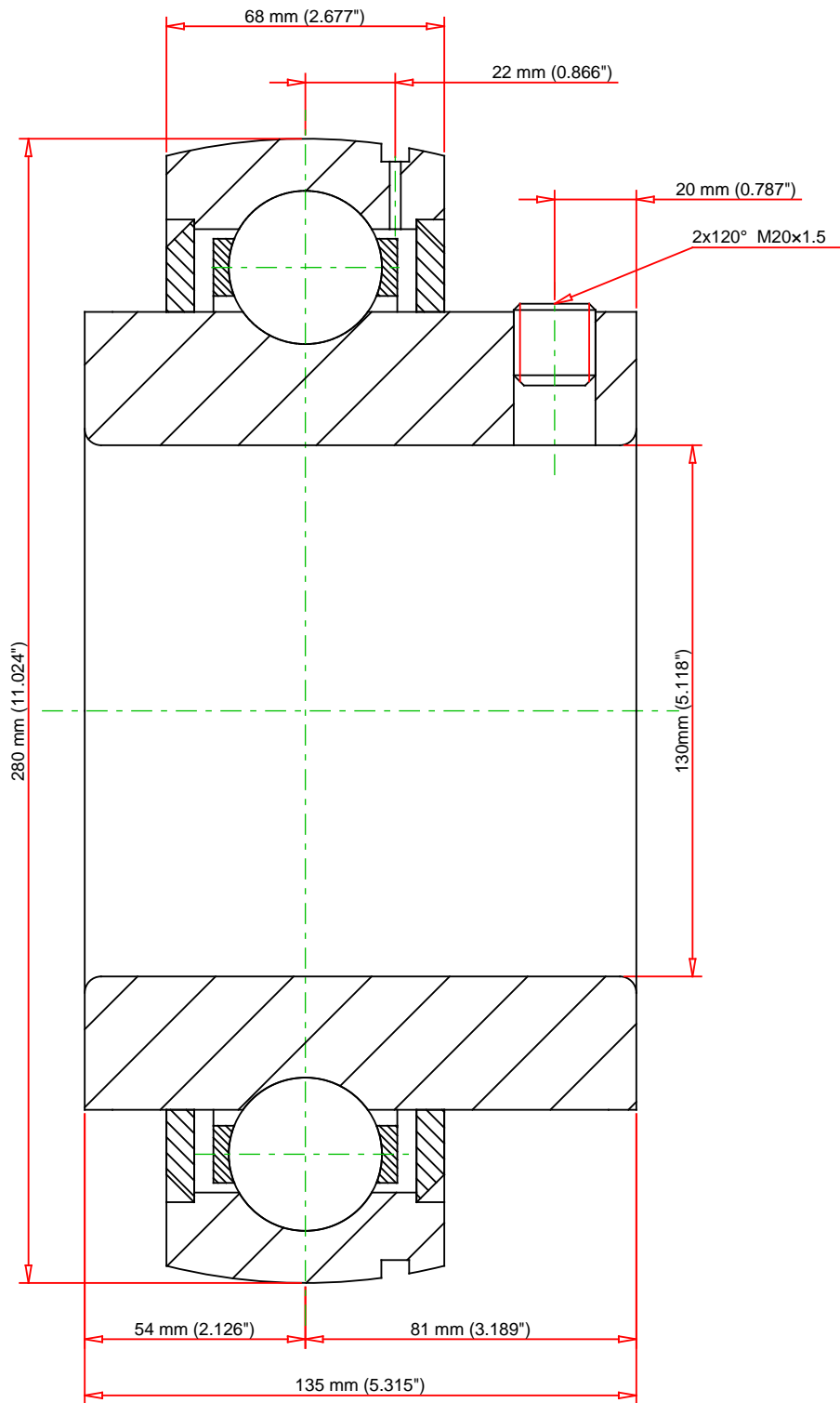

Weight	23.6 lb	10.7 kg		<div>UC326</div> <div>UC 300 Wide Inner Ring Ball Bearings - Set Screw Locking</div>
			<div>Load Ratings - C_{0r}</div> <div>48110 lbf</div> <div>214000 N</div>	
<div>Every reasonable effort has been made to ensure the accuracy of the information contained in this writing, but no liability is accepted for errors, omissions or for any other reason.</div>				<div>FOR DISCUSSION ONLY</div>