

# Series RHC

Construction:  $\phi 20$  to  $\phi 40$

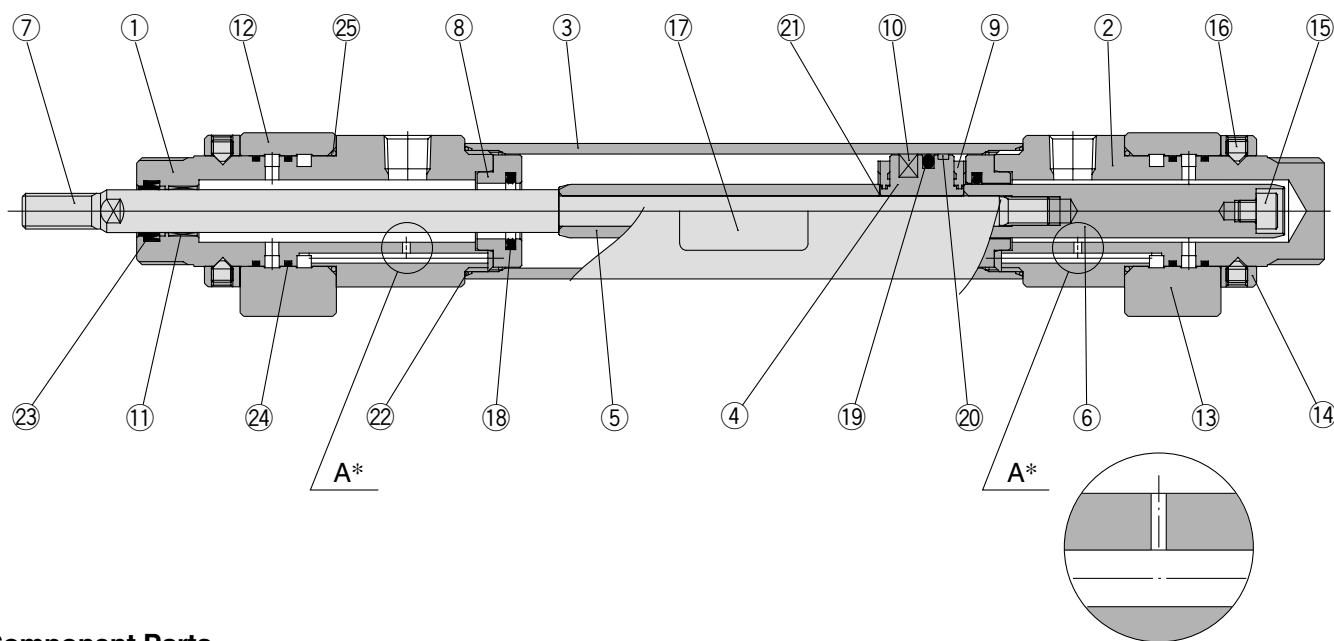

Enlarged view of "A"

## Component Parts

No.	Description	Material	Note
1	Rod cover	Aluminum alloy	Clear anodized
2	Head cover	Aluminum alloy	Clear anodized
3	Cylinder tube	Aluminum alloy	Hard anodized
4	Piston	Aluminum alloy	Chromated
5	Cushion ring A	Carbon steel	Hard chrome plated
6	Cushion ring B	Carbon steel	Hard chrome plated
7	Piston rod	Carbon steel *	Hard chrome plated
8	Cushion spacer	Stainless steel	
9	Bumper	Urethane	
10	Magnet	—	
11	Bushing	Copper oil-impregnated sintered alloy	
12	Relief valve assembly (Rod side)	—	
13	Relief valve assembly (Head side)	—	
14	Relief valve body holder	Aluminum alloy	Clear anodized
15	Hexagon socket head cap screw	Carbon steel	$\phi 20$ : M5 x 0.8 x 6 $\phi 25$ , $\phi 32$ : M6 x 1 x 6 $\phi 40$ : M8 x 1.25 x 8 Nickel plated
16	Hexagon socket head set screw	Carbon steel	$\phi 20$ , $\phi 25$ : M5 x 0.8 x 6 $\phi 32$ , $\phi 40$ : M6 x 1 x 8 Nickel plated
17	Plate	—	
18	Cushion seal	Special resin	
19	Piston seal	NBR	
20	Wear ring	Resin	
21	Piston gasket	NBR	
22	Cylinder tube gasket	NBR	
23	Rod seal	NBR	
24	O-ring	NBR	
25	O-ring	NBR	

\* Stainless steel for  $\phi 20$  and  $\phi 25$

## Replacement Parts/Seal Kit

Bore size (mm)	Kit no.	Contents
20	RHC20-PS	Set of nos. left 18, 19, 20, 22, 23, 24, 25
25	RHC25-PS	
32	RHC32-PS	
40	RHC40-PS	

\* Seal kit includes a grease pack (10 g).

Order with the following part number when only the grease pack is needed.

Grease pack part no.: GR-S-010 (10 g)

## Caution

When disassembling cylinders with bore sizes of  $\phi 20$  through  $\phi 40$ , grip the double flat part of either the rod cover or the head cover with a vise and loosen the other side with a wrench or an adjustable angle wrench, and then remove the cover. When re-tightening, tighten approximately 2 degrees more than the original position.