



The Timken Company

4500 Mt Pleasant St. NW

N. Canton, OH 44720

Phone: (234) 262-3000

E-Mail: CustomerCAD@timken.com • **Web site:** www.timken.com

Part Number UC324, UC 300 Wide Inner Ring Ball Bearings - Set Screw Locking

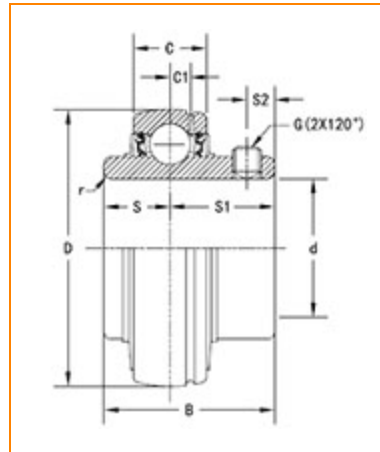

[Specifications](#) | [Dimensions](#) | [Basic Load Ratings](#)

Specifications

Bore Type	Cylindrical bore
Bearing Type	Ball Bearing
Shaft Size d	120 mm
Material	Bearing Steel
Locking Device	Set Screw Locking

Dimensions

Outside Diameter D	260 mm
Outside Ring Width C	64 mm
Radius r	3 mm
Groove Position C1	21 mm



Center of Bearing from End S	51 mm
Dimension S1	75 mm
Set Screw Distance S2	20 mm
Set Screw Size	M18×1.5
Number of Set Screws	2
Angle between Set Screws	120 °

Basic Load Ratings

Static Load Rating	185000 N
Dynamic Load Rating	207000 N

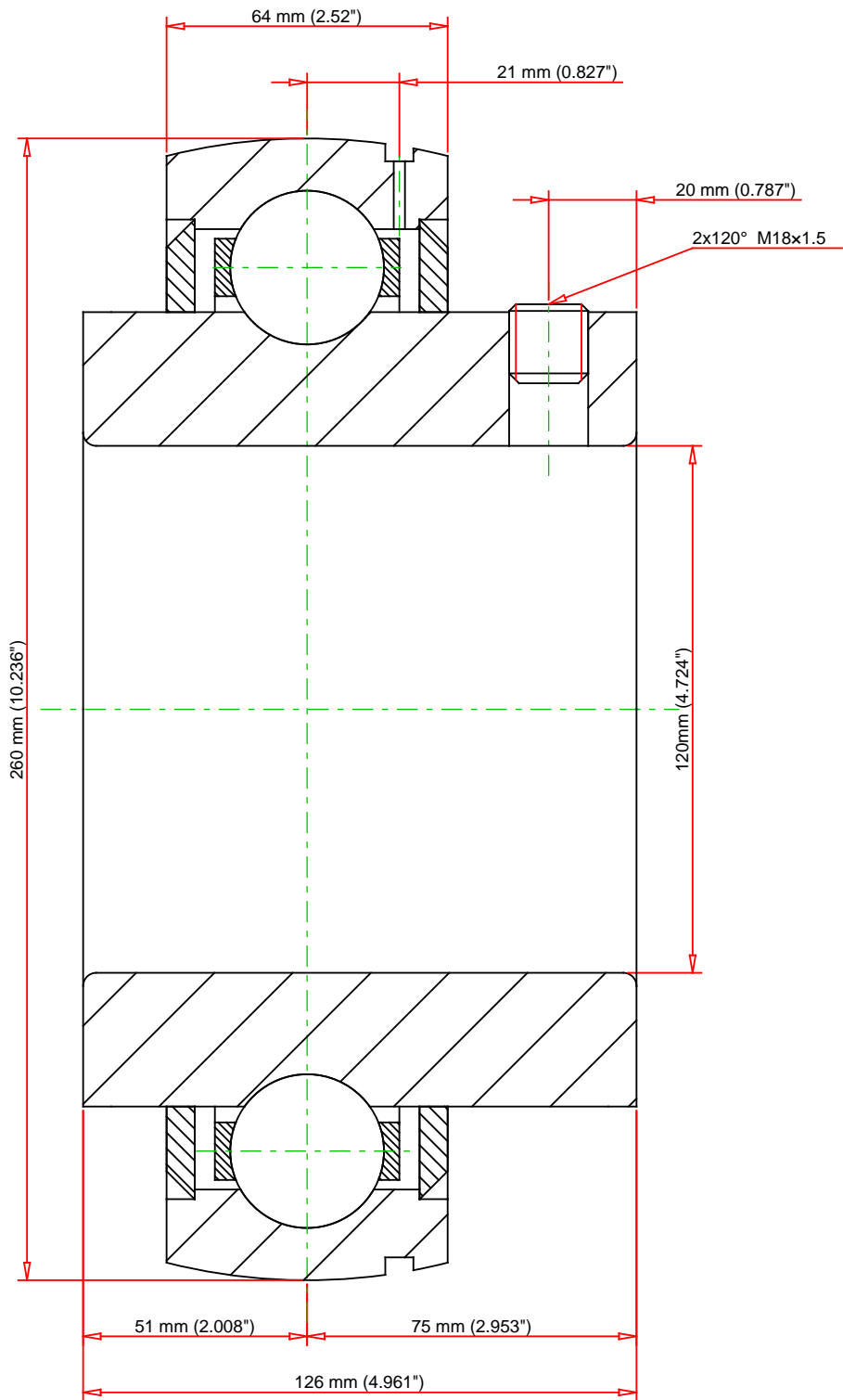

Weight	19 lb	8.6 kg		UC324 UC 300 Wide Inner Ring Ball Bearings - Set Screw Locking		
			THE TIMKEN COMPANY NORTH CANTON, OHIO USA	Basic Load Ratings - C _r	46536 lbf	207000 N
				Load Ratings - C _{0r}	41590 lbf	185000 N
Every reasonable effort has been made to ensure the accuracy of the information contained in this writing, but no liability is accepted for errors, omissions or for any other reason.				FOR DISCUSSION ONLY		