

3.2 Hook wrenches LOCKNUT-HOOK

The hook wrenches LOCKNUT-HOOK in accordance with DIN 1810-A are suitable for the tightening and loosening of locknuts KM on shafts, adapter sleeves and withdrawal sleeves, if no tightening torque is specified.

The hook wrenches are suitable for locknuts KM0 to KM40. Special sizes are available by agreement.

Hook wrenches can be used to mount rolling bearings on tapered shaft seats, on adapter sleeves and on withdrawal sleeves. Withdrawal sleeves can also be dismounted using hook wrenches together with the extraction nuts.

Special sizes are available by agreement.

8 Hook wrench set LOCKNUT-HOOK-KM0-16-SET

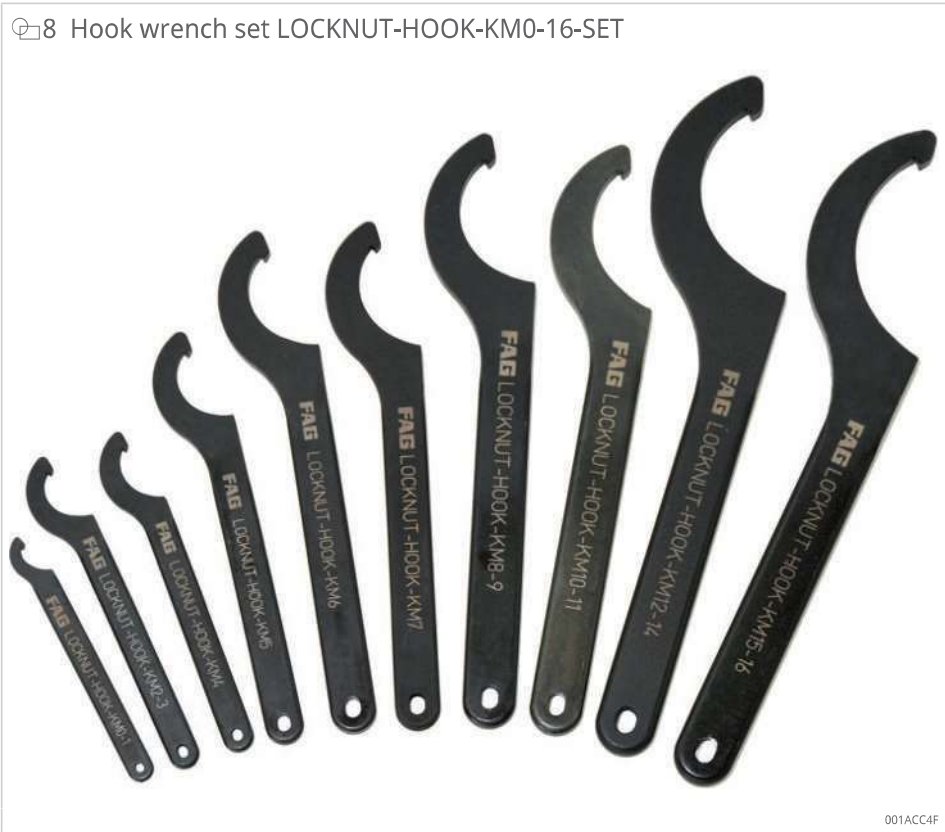

5 Hook wrench set LOCKNUT-HOOK-KM0-16-SET

Designation	Article number	Locknuts
LOCKNUT-HOOK-KM0-16-SET	076201767-0000-10	KM0...KM17

The set LOCKNUT-HOOK-KM0-16-SET contains hook wrenches for locknuts up to KM16. Hook wrenches can also be ordered as individual items.

9 LOCKNUT-HOOK dimensions

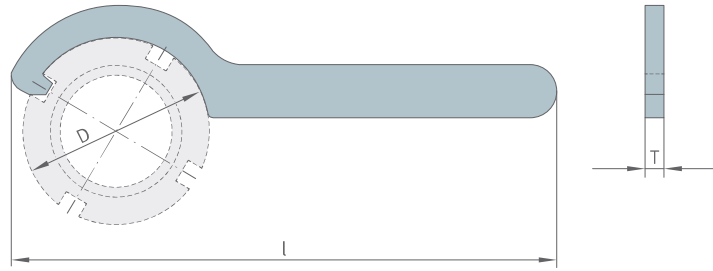

001AE274

3

6 LOCKNUT-HOOK designs

Designation	Article number	D <sub>min</sub>	D <sub>max</sub>	l	T	m	Locknuts
		mm	mm	mm	mm	kg	
LOCKNUT-HOOK-KM0-1	039056660-0000-10	16	20	110	3	0,03	KM0, KM1
LOCKNUT-HOOK-KM2-3	039056678-0000-10	25	28	136	4	0,05	KM2, KM3
LOCKNUT-HOOK-KM4	039056686-0000-02	30	32	136	4	0,05	KM4
LOCKNUT-HOOK-KM5	039056694-0000-10	34	36	170	5	0,09	KM5
LOCKNUT-HOOK-KM6	039056708-0000-10	45	50	206	6	0,16	KM6
LOCKNUT-HOOK-KM7	039056716-0000-10	52	55	206	6	0,16	KM7
LOCKNUT-HOOK-KM8-9	039056724-0000-10	58	62	240	7	0,26	KM8, KM9
LOCKNUT-HOOK-KM10-11	039056732-0000-10	68	75	240	7	0,26	KM10, KM11
LOCKNUT-HOOK-KM12-14	039056740-0000-10	80	90	280	8	0,41	KM12, KM13, KM14
LOCKNUT-HOOK-KM15-16	039056759-0000-10	95	100	280	8	0,41	KM15, KM16
LOCKNUT-HOOK-KM17	039056767-0000-10	110	115	335	10	0,75	KM17
LOCKNUT-HOOK-KM18-20	039056775-0000-10	120	130	335	10	0,72	KM18, KM19, KM20
LOCKNUT-HOOK-KM21-23	039056791-0000-10	135	145	385	10	1	KM21, KM22, KM23
LOCKNUT-HOOK-KM24-27	039056805-0000-10	155	165	385	10	0,97	KM24, KM25, KM26, KM27
LOCKNUT-HOOK-KM28-30	039056813-0000-10	180	195	470	10	1,5	KM28, KM29, KM30
LOCKNUT-HOOK-KM31-34	039056821-0000-10	205	220	470	10	1,58	KM31, KM32, KM33, KM34
LOCKNUT-HOOK-KM36-40	039056848-0000-10	230	245	568	10	2,25	KM36, KM38, KM40