



The Timken Company

4500 Mt Pleasant St. NW

N. Canton, OH 44720

Phone: (234) 262-3000

E-Mail: CustomerCAD@timken.com • **Web site:** www.timken.com

Part Number UC322, UC 300 Wide Inner Ring Ball Bearings - Set Screw Locking

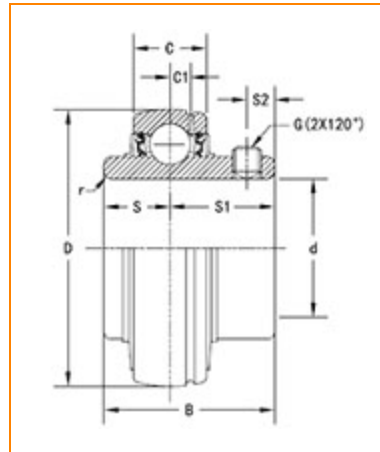

[Specifications](#) | [Dimensions](#) | [Basic Load Ratings](#)

Specifications

Bore Type	Cylindrical bore
Bearing Type	Ball Bearing
Shaft Size d	110 mm
Material	Bearing Steel
Locking Device	Set Screw Locking

Dimensions

Outside Diameter D	240 mm
Outside Ring Width C	60 mm
Radius r	3 mm
Groove Position C1	20 mm





Center of Bearing from End S	46 mm
Dimension S1	71 mm
Set Screw Distance S2	20 mm
Set Screw Size	M18×1.5
Number of Set Screws	2
Angle between Set Screws	120 °

Basic Load Ratings

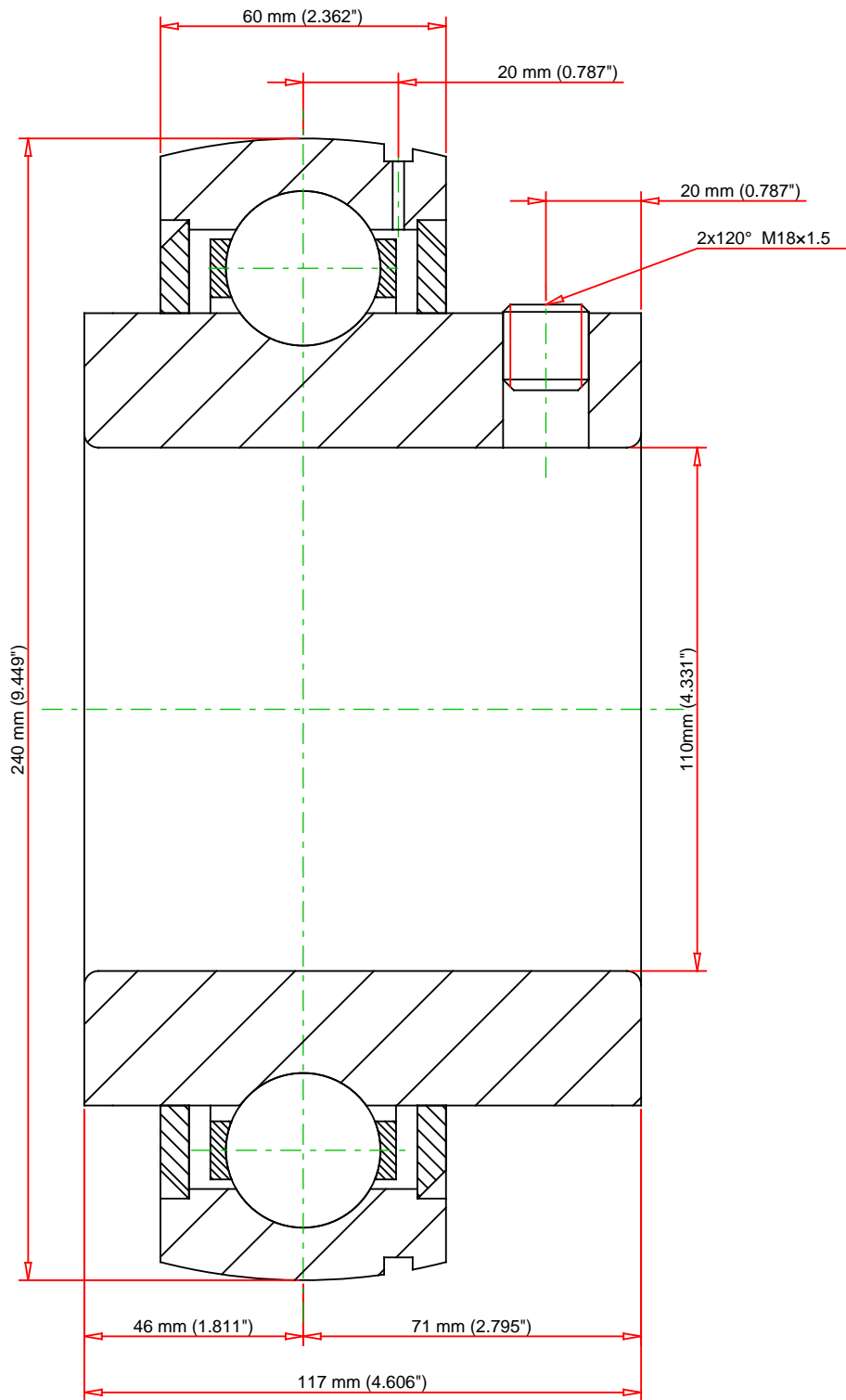
Static Load Rating	180000 N
Dynamic Load Rating	205000 N



Weight	15.1 lb	6.8 kg		UC322 UC 300 Wide Inner Ring Ball Bearings - Set Screw Locking	
					
			Basic Load Ratings - C _r	46086 lbf	
			Load Ratings - C _{0r}	40466 lbf	180000 N
Every reasonable effort has been made to ensure the accuracy of the information contained in this writing, but no liability is accepted for errors, omissions or for any other reason.				FOR DISCUSSION ONLY	