



The Timken Company

4500 Mt Pleasant St. NW

N. Canton, OH 44720

Phone: (234) 262-3000

E-Mail: CustomerCAD@timken.com • **Web site:** www.timken.com

Part Number UCP316, UCP 300 Pillow Block Mounted Bearings - Set Screw Locking

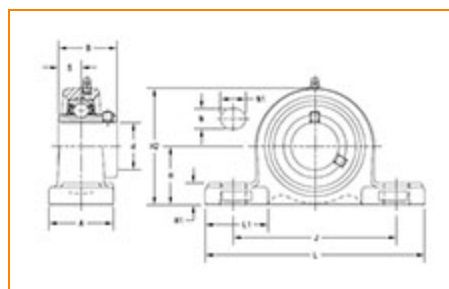

[Specifications](#) | [Dimensions](#) | [Basic Load Ratings](#)

Specifications

Bearing Number	UC316
Shaft Size d	80 mm
Locking Style	Set Screw Locking
Housing Construction	Two-Bolt Pillow Block

Dimensions

Base to Center Height H	106 mm 4.173 in
Total Length L	400 mm 15.748 in
Housing Width A	110 mm 4.331 in
Bolt Hole Spacing J	320 mm 12.598 in



Bolt Hole Size N	27 mm 1.063 in
Bolt Hole Length N1	40 mm 1.575 in
Foot Height H1	35 mm
Total Height H2	209 mm 8.228 in
Dimension L1	120 mm 4.724 in
Inner Ring Width B	86 mm 3.386 in
Center of Bearing from End S	34 mm 1.339 in

Basic Load Ratings

Static Load Rating	86700 N 19491 lbf
Dynamic Load Rating	123000 N 27652 lbf

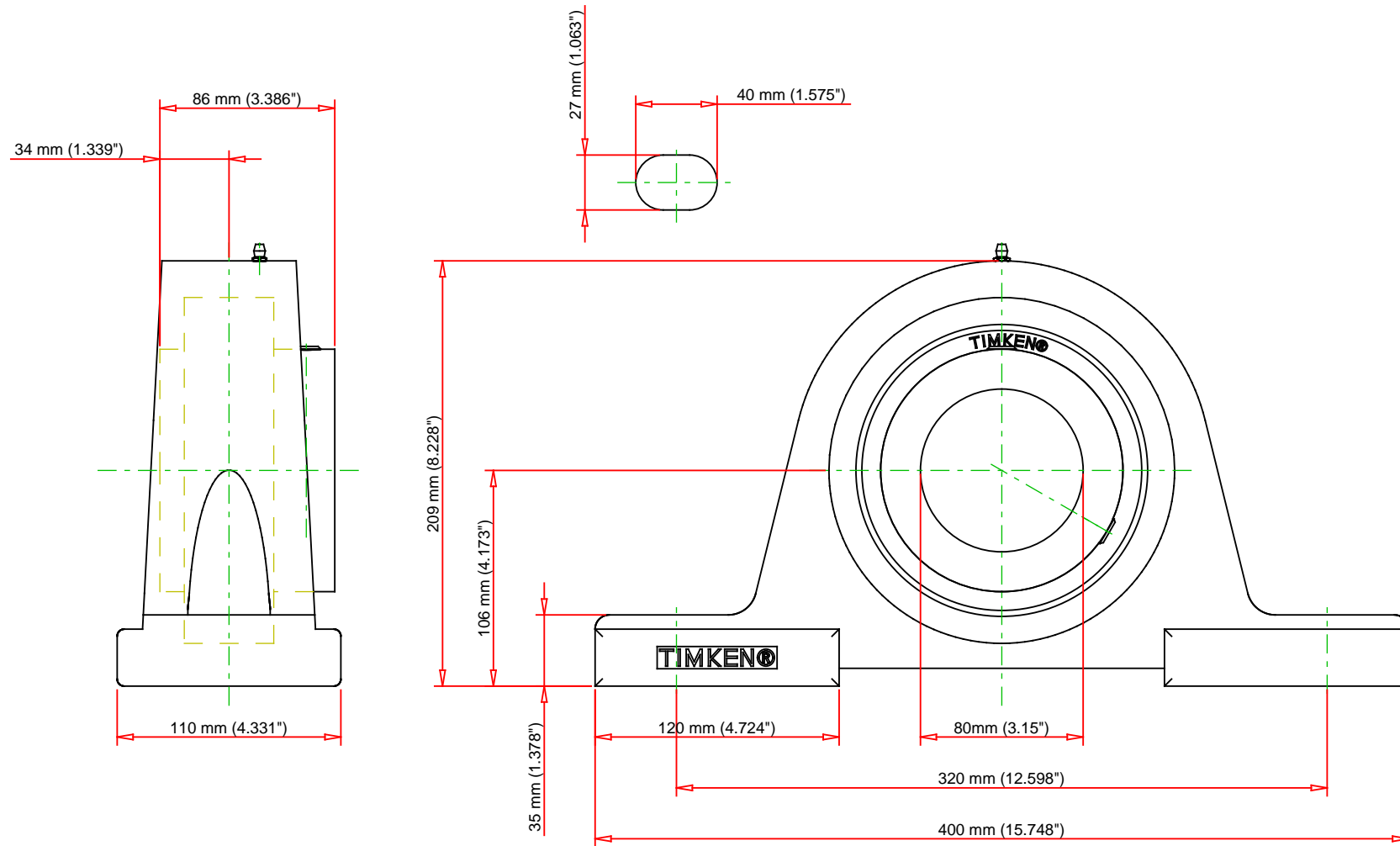

Bearing Number	UC316			
Load Ratings - C _r	27652	lbf	123000	N
Load Ratings - C _{0r}	19491	lbf	86700	N
Weight	40.8	lb	18.5	kg
Bolt Size	M20			

TIMKEN

THE TIMKEN COMPANY
NORTH CANTON, OHIO USA

UCP316

UCP 300 Pillow Block Mounted Bearings -
Set Screw Locking

Every reasonable effort has been made to ensure the accuracy of the information contained in this writing, but no liability is accepted for errors, omissions or for any other reason.

FOR DISCUSSION ONLY