



The Timken Company

4500 Mt Pleasant St. NW

N. Canton, OH 44720

Phone: (234) 262-3000

E-Mail: CustomerCAD@timken.com • **Web site:** www.timken.com

Bearing Unit - Adapter Sleeve UKF216 - H2316, UKF 200 Four-Bolt Flanged Mounted Bearings - Adapter Sleeve Locking

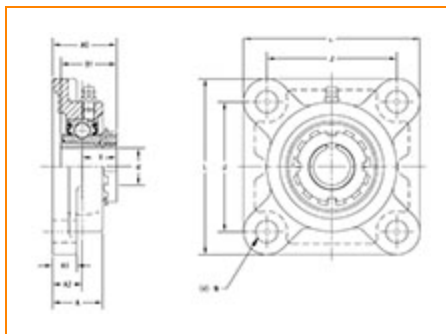

[Specifications](#) | [Dimensions](#) | [Basic Load Ratings](#)

Specifications

Bearing Unit - Adapter Sleeve	UK216 - H2316
Shaft Size d	70 mm
Adapter Sleeve Number¹	H2316
Locking Style	Adapter Sleeve Locking
Housing Construction	Four-Bolt Square Flange

Dimensions

Total Length L	208 mm 8.189 in
 Housing Width A	58 mm 2.283 in

Bolt Hole Spacing J	165 mm 6.496 in
Bolt Hole Size N	23 mm 0.906 in
Flange Thickness A1	22 mm 0.866 in
Center of Bearing from Housing End A2	34 mm 1.339 in
Center of Bearing from Bearing End Y	44.5 mm 1.752 in
Dimension B1	78 mm 3.071 in
Dimension A0	78.5 mm 2.938 in
Grease Nipple Size	A-R1/8

Basic Load Ratings

Static Load Rating	53000 N 11915 lbf
Dynamic Load Rating	72700 N 16344 lbf

¹ Purchase the Adapter Sleeve separately

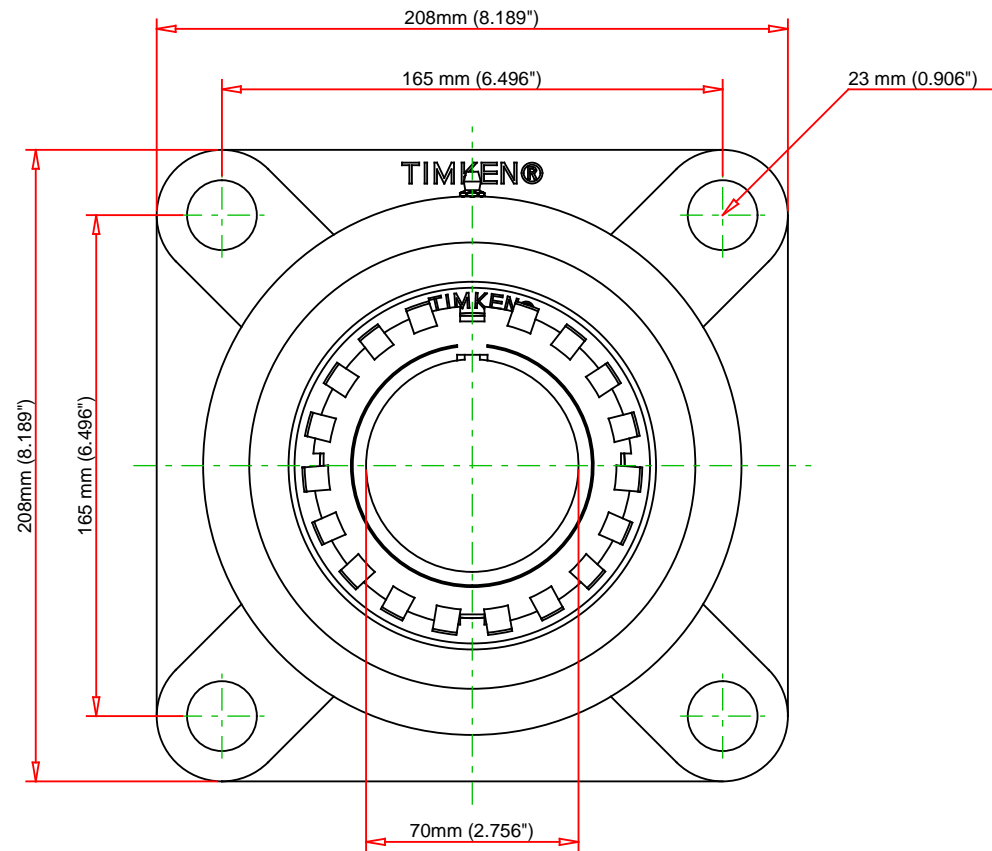

Note: Adapter sold separately

Bearing Number	UK216 - H2316			
Load Ratings - C _r	16344	lbf	72700	
Load Ratings - C _{0r}	11915	lbf	53000	N
Weight	16.8	lb	7.6	kg
				THE TIMKEN COMPANY NORTH CANTON, OHIO USA

UKF216 - H2316

UKF 200 Four-Bolt Flanged Mounted Bearings - Adapter Sleeve Locking

Every reasonable effort has been made to ensure the accuracy of the information contained in this writing, but no liability is accepted for errors, omissions or for any other reason.

FOR DISCUSSION ONLY