

# Improved features and related benefits

**FEATURE:** Improved auto-switch mounting:

- Number of required elements reduced from four to three elements.
- Fine adjustment of the auto-switch position can be done by just loosening one screw.
- Transparent bracket improves visibility of the auto-switch status.

**CUSTOMER BENEFIT:** Reduced assembly and maintenance costs.

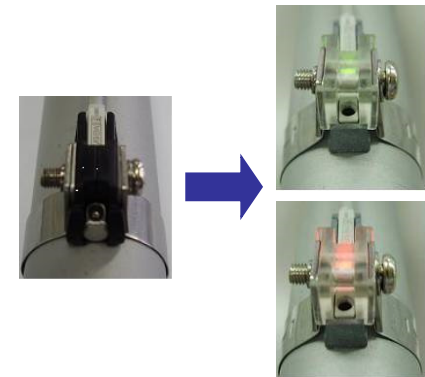
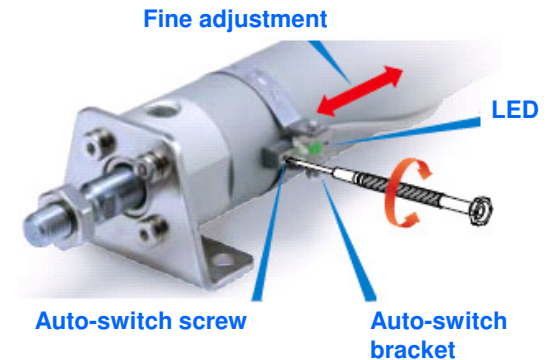
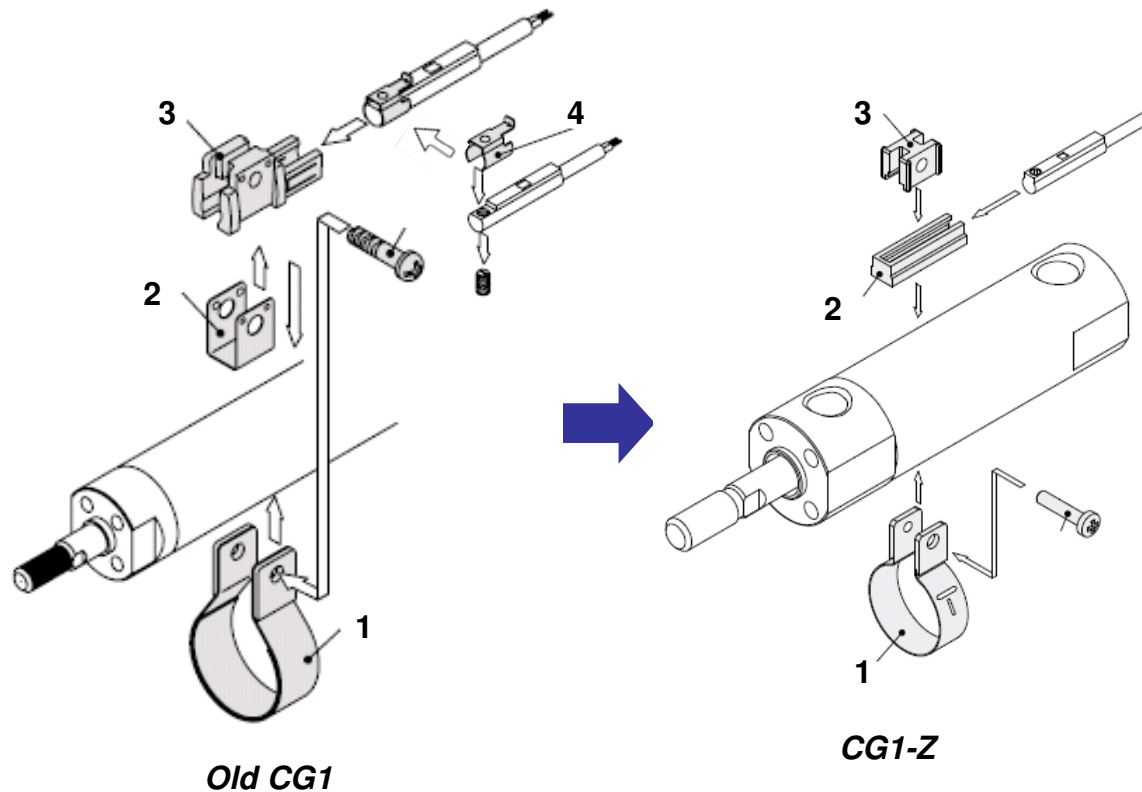

# Improved features and related benefits

**FEATURE:** Improved design of the cushion valve that is now embedded into the cylinder covers to eliminate protrusions.

**CUSTOMER BENEFIT:** Cleaner cylinder profile and elimination of interference with protruding elements

**FEATURE:** New option “without trunnion mounting holes” on cylinder covers (option “Z”) provides a cleaner profile.

**CUSTOMER BENEFIT:** No accumulation of dust and improved cylinder appearance.

No trunnion mounting holes (option “Z”)



**FEATURE:** Female rod end thread is now available as standard.

**CUSTOMER BENEFIT:** Easier order process and shorter delivery time.



*Female rod end thread*



*Male rod end thread*

# Technical details

## ▪ Spare parts and accessories

Seals kit (not interchangeable)

Bore size	Model	Old CG1	CG1-Z
20	CG1N	CG1N20-PS	CG1N20Z-PS
	CG1A	CG1A20-PS	
25	CG1N	CG1N25-PS	CG1N25Z-PS
	CG1A	CG1A25-PS	
32	CG1N	CG1N32-PS	CG1N32Z-PS
	CG1A	CG1A32-PS	
40	CG1N	CG1N40-PS	CG1N40Z-PS
	CG1A	CG1A40-PS	

## Mounting accessories for D-M9/D-A9 auto-switches

D-A9# / D-M9# / D-M9W# <small>Note 1)</small>			D-M9A# <small>Note 2)</small>		
Bore size	Old CG1	CG1-Z	Bore size	Old CG1	CG1-Z
20	BMA2-020 BJ3-1	BMA3-020	20	BMA2-020AS BJ3-1	BMA3-020S
25	BMA2-025 BJ3-1	BMA3-025	25	BMA2-025AS BJ3-1	BMA3-025S
32	BMA2-032 BJ3-1	BMA3-032	32	BMA2-032AS BJ3-1	BMA3-032S
40	BMA2-040 BJ3-1	BMA3-040	40	BMA2-040AS BJ3-1	BMA3-040S
50	BMA2-050 BJ3-1	BMA3-050	50	BMA2-050AS BJ3-1	BMA3-050S
63	BMA2-063 BJ3-1	BMA3-063	63	BMA2-063AS BJ3-1	BMA3-063S
80	-	-	80	-	-
100	-	-	100	-	-

Note1)

BMA3-### includes mounting band BMA2-###A and holder kit BJ5-1 (transparent bracket).

Note2)

BMA3-###S includes stainless mounting band BMA2-###AS and holder kit BJ4-1 (white bracket)