



The Timken Company

4500 Mt Pleasant St. NW

N. Canton, OH 44720

Phone: (234) 262-3000

E-Mail: CustomerCAD@timken.com • **Web site:** www.timken.com

Bearing Unit - Adapter Sleeve UKF215 - H2315, UKF 200 Four-Bolt Flanged Mounted

Bearings - Adapter Sleeve Locking

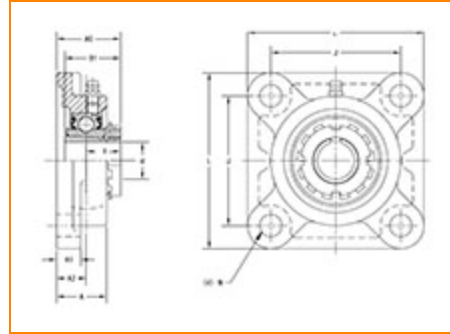

[Specifications](#) | [Dimensions](#) | [Basic Load Ratings](#)

Specifications

Bearing Unit - Adapter Sleeve	UK215 - H2315
Shaft Size d	65 mm
Adapter Sleeve Number¹	H2315
Locking Style	Adapter Sleeve Locking
Housing Construction	Four-Bolt Square Flange

Dimensions

Total Length L	200 mm 7.874 in
 Housing Width A	56 mm 2.205 in

Bolt Hole Spacing J	159 mm 6.26 in
Bolt Hole Size N	19 mm 0.748 in
Flange Thickness A1	22 mm 0.866 in
Center of Bearing from Housing End A2	34 mm 1.339 in
Center of Bearing from Bearing End Y	40.5 mm 1.594 in
Dimension B1	73 mm 2.874 in
Dimension A0	74.5 mm 2.938 in
Grease Nipple Size	A-R1/8

Basic Load Ratings

Static Load Rating	48300 N 10858 lbf
Dynamic Load Rating	67400 N 15152 lbf

¹ Purchase the Adapter Sleeve separately

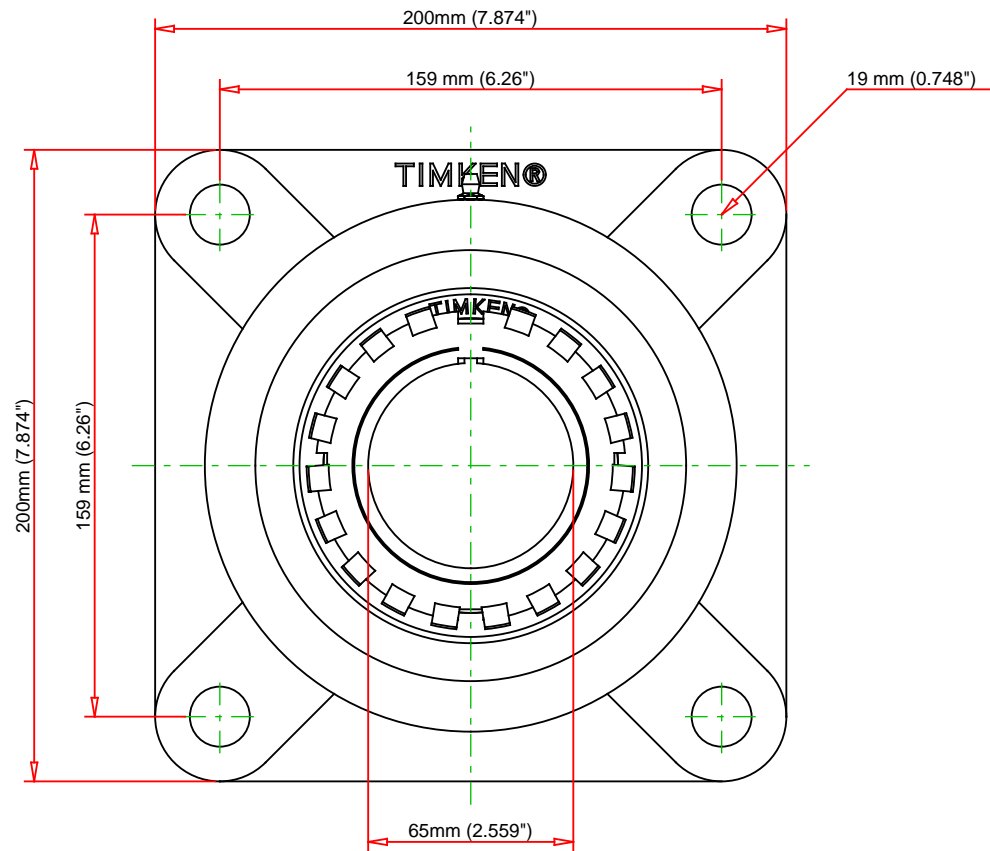

Note: Adapter sold separately

Bearing Number	UK215 - H2315			
Load Ratings - C _r	15152	lbf	67400 N	
Load Ratings - C _{0r}	10858	lbf	48300 N	
Weight	14.3	lb	6.5 kg	
				THE TIMKEN COMPANY NORTH CANTON, OHIO USA

UKF215 - H2315

UKF 200 Four-Bolt Flanged Mounted Bearings - Adapter Sleeve Locking

Every reasonable effort has been made to ensure the accuracy of the information contained in this writing, but no liability is accepted for errors, omissions or for any other reason.

FOR DISCUSSION ONLY