



The Timken Company

4500 Mt Pleasant St. NW

N. Canton, OH 44720

Phone: (234) 262-3000

E-Mail: CustomerCAD@timken.com • **Web site:** www.timken.com

Part Number UC320, UC 300 Wide Inner Ring Ball Bearings - Set Screw Locking

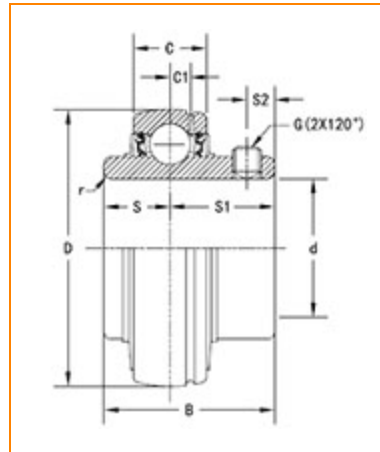

[Specifications](#) | [Dimensions](#) | [Basic Load Ratings](#)

Specifications

| | |
|-----------------------|-------------------|
| Bore Type | Cylindrical bore |
| Bearing Type | Ball Bearing |
| Shaft Size d | 100 mm |
| Material | Bearing Steel |
| Locking Device | Set Screw Locking |

Dimensions

| | |
|-----------------------------|--------|
| Outside Diameter D | 215 mm |
| Outside Ring Width C | 54 mm |
| Radius r | 3 mm |
| Groove Position C1 | 18 mm |



| | |
|-------------------------------------|---------|
| Center of Bearing from End S | 42 mm |
| Dimension S1 | 66 mm |
| Set Screw Distance S2 | 20 mm |
| Set Screw Size | M18×1.5 |
| Number of Set Screws | 2 |
| Angle between Set Screws | 120 ° |

Basic Load Ratings

| | |
|----------------------------|----------|
| Static Load Rating | 141000 N |
| Dynamic Load Rating | 173000 N |

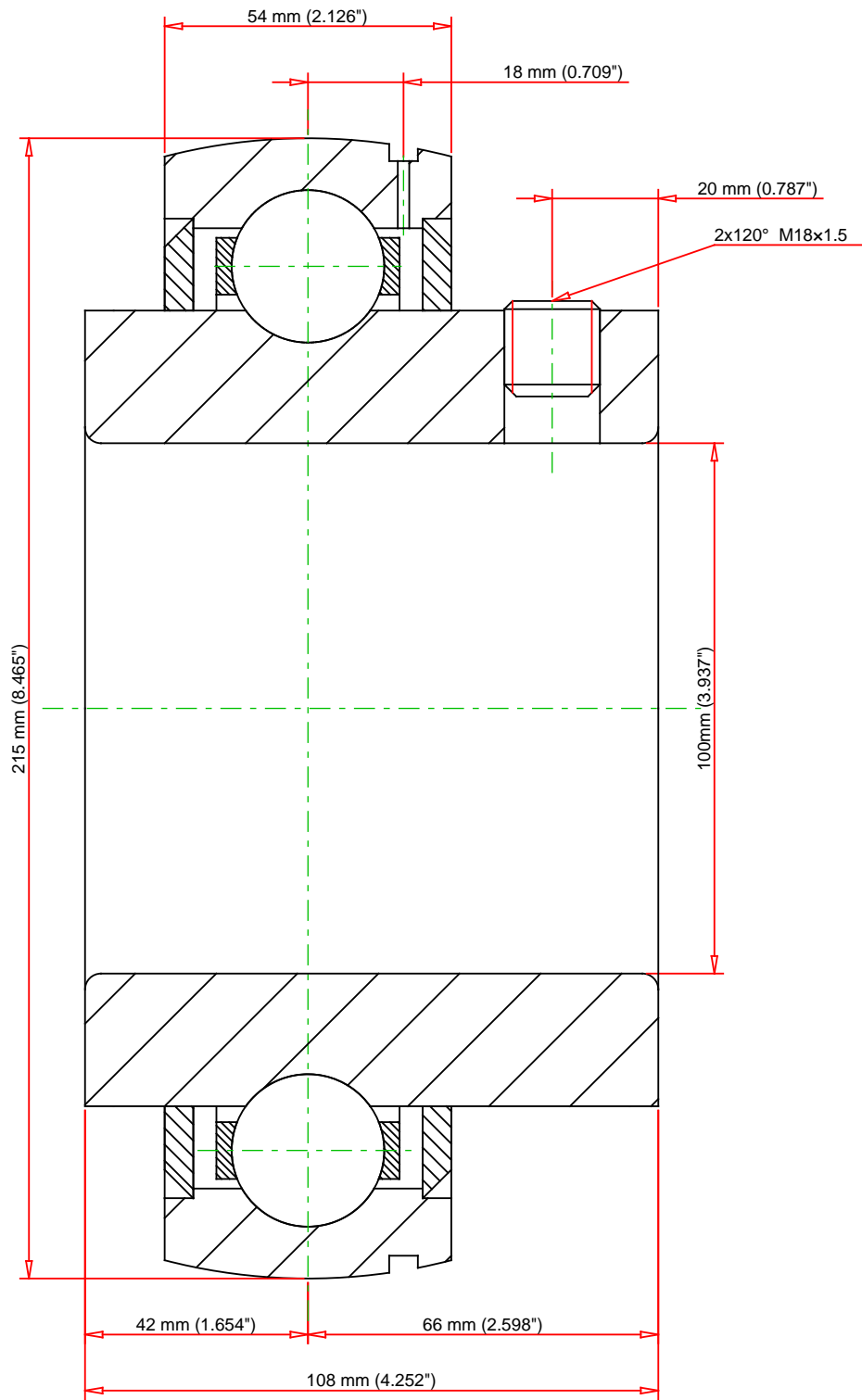

| | | | | | | |
|--|---------|--------------------------------|--|--|-----------|----------|
| Weight | 11.2 lb | 5.1 kg |  | <div>UC320</div> <div>UC 300 Wide Inner Ring Ball Bearings - Set Screw Locking</div> | | |
| | | | | | | |
| | | | Basic Load Ratings - C _r | | 38892 lbf | 173000 N |
| | | Load Ratings - C _{0r} | | 31698 lbf | 141000 N | |
| Every reasonable effort has been made to ensure the accuracy of the information contained in this writing, but no liability is accepted for errors, omissions or for any other reason. | | | | FOR DISCUSSION ONLY | | |