



The Timken Company

4500 Mt Pleasant St. NW

N. Canton, OH 44720

Phone: (234) 262-3000

E-Mail: CustomerCAD@timken.com • **Web site:** www.timken.com

Part Number 3525, Tapered Roller Bearings - Single Cups - Imperial

This is the most basic and most widely used type of tapered roller bearing. It consists of two main separable parts: the cone (inner ring) assembly and the cup (outer ring). It is typically mounted in opposing pairs on a shaft.

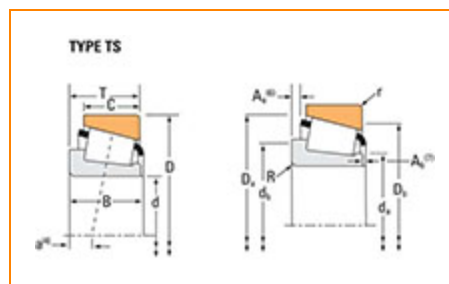

[Specifications](#) | [Dimensions](#) | [Abutment and Fillet Dimensions](#) | [Factors](#)

Specifications

| | |
|------------------------|----------|
| Series | 3500 |
| Cup Part Number | 3525 |
| Design Units | Imperial |

Dimensions

| | |
|-------------------------------|------------------------|
| D - Cup Outer Diameter | 3.4375 in 87.313 mm |
| C - Cup Width | 0.9375 in 23.813 mm |



Abutment and Fillet Dimensions

| | |
|---|---------------------|
| r - Cup Backface "To Clear" Radius¹ | 0.130 in 3.30 mm |
| Da - Cup Frontface Backing Diameter | 3.23 in 82.00 mm |
| Db - Cup Backface Backing Diameter | 2.95 in 74.93 mm |

Factors

| | |
|---|--------|
| e - ISO Factor² | 0.31 |
| Y - ISO Factor³ | 1.96 |
| Cg - Geometry Factor⁴ | 0.0808 |

¹ These maximum fillet radii will be cleared by the bearing corners.

² These factors apply for both inch and metric calculations. Consult your Timken representative for instruction on use.

³ These factors apply for both inch and metric calculations. Consult your Timken representative for instruction on use.

⁴ Geometry constant for Lubrication Life Adjustment Factor a3l.

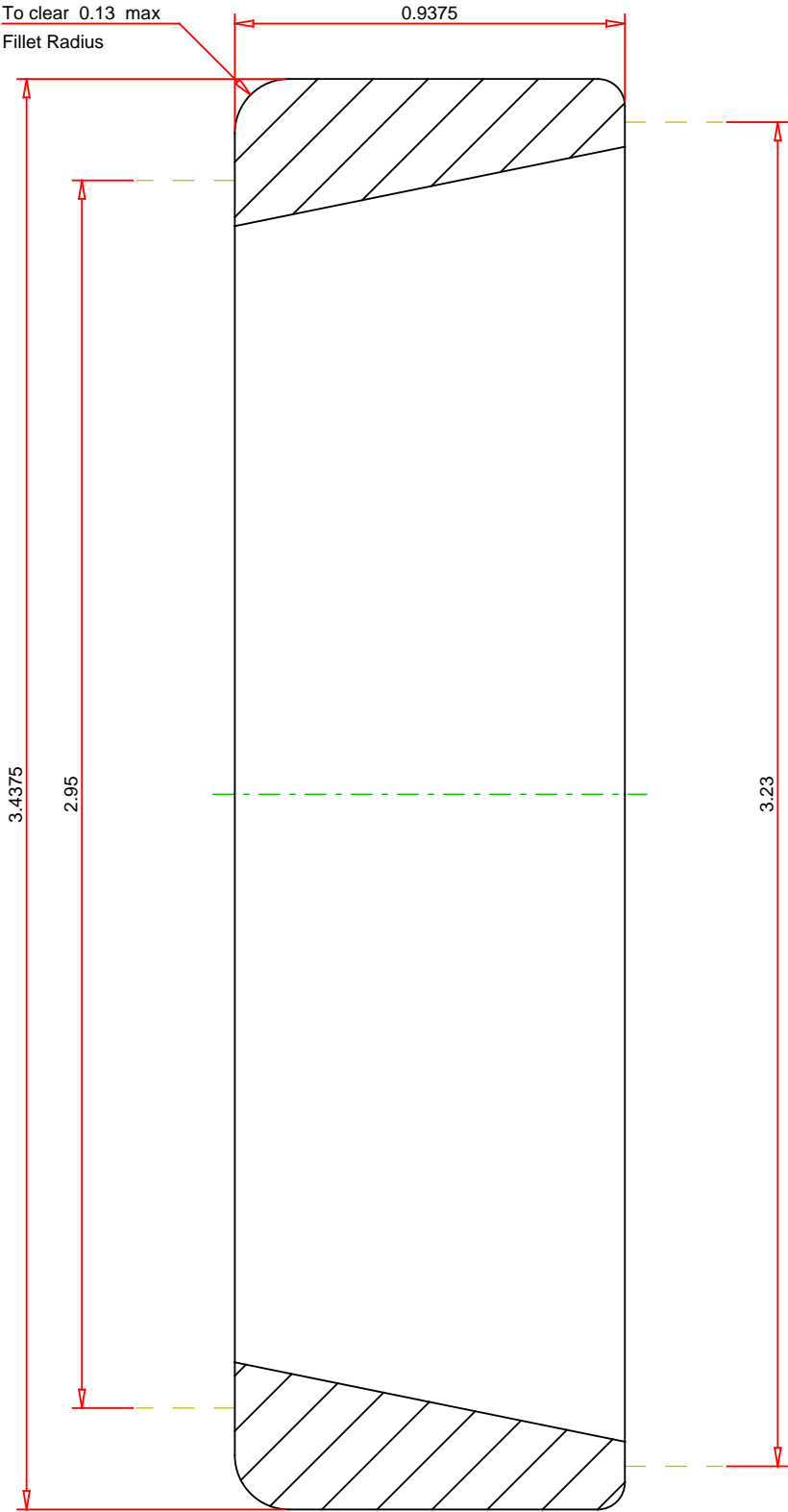

IMPERIAL UNITS

TIMKEN®

THE TIMKEN COMPANY
NORTH CANTON, OHIO USA

3525
Tapered Roller Bearings - Single Cups - Imperial