



The Timken Company

4500 Mt Pleasant St. NW

N. Canton, OH 44720

Phone: (234) 262-3000

E-Mail: CustomerCAD@timken.com • **Web site:** www.timken.com

Bearing Unit - Adapter Sleeve UKF212 - H2312, UKF 200 Four-Bolt Flanged Mounted Bearings - Adapter Sleeve Locking

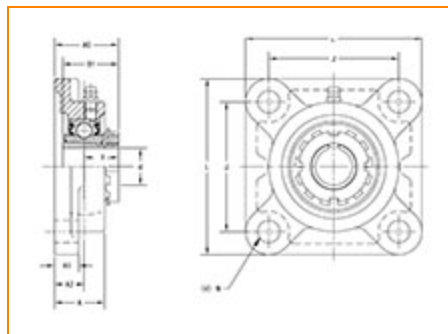

[Specifications](#) | [Dimensions](#) | [Basic Load Ratings](#)

Specifications

Bearing Unit - Adapter Sleeve	UK212 - H2312
Shaft Size d	55 mm
Adapter Sleeve Number¹	H2312
Locking Style	Adapter Sleeve Locking
Housing Construction	Four-Bolt Square Flange

Dimensions

Total Length L	175 mm 6.89 in
 Housing Width A	48 mm 1.89 in

Bolt Hole Spacing J	143 mm 5.63 in
Bolt Hole Size N	19 mm 0.748 in
Flange Thickness A1	18 mm 0.709 in
Center of Bearing from Housing End A2	29 mm 1.142 in
Center of Bearing from Bearing End Y	36.5 mm 1.437 in
Dimension B1	62 mm 2.441 in
Dimension A0	65.5 mm 2.594 in
Grease Nipple Size	A-R1/8

Basic Load Ratings

Static Load Rating	36200 N 8138 lbf
Dynamic Load Rating	52400 N 11780 lbf

¹ Purchase the Adapter Sleeve separately

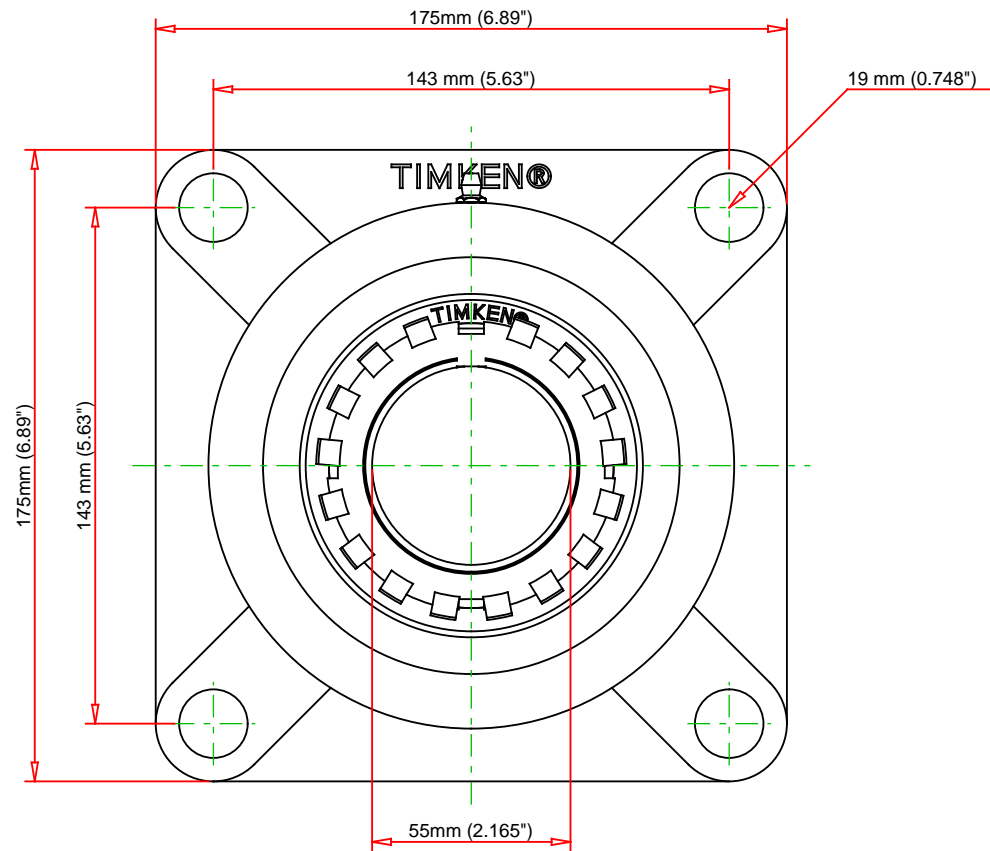

Note: Adapter sold separately

Bearing Number	UK212 - H2312		
Load Ratings - C _r	11780	lbf	52400
Load Ratings - C _{0r}	8138	lbf	36200
Weight	9	lb	4.1

TIMKEN®

THE TIMKEN COMPANY
NORTH CANTON, OHIO USA

UKF212 - H2312

UKF 200 Four-Bolt Flanged Mounted Bearings - Adapter Sleeve Locking

Every reasonable effort has been made to ensure the accuracy of the information contained in this writing, but no liability is accepted for errors, omissions or for any other reason.

FOR DISCUSSION ONLY