

Multi-connector with One-touch Fittings

Series *DMK*

No. of Connecting Tubes: 6, 12

Multi-connector with One-touch fittings provide quick and easy installation and removal of multiple tubing (nylon, soft nylon, and polyurethane) when connecting to a panel of a device.

A unique positioning mechanism allows accurate installation and removal of tubing with ease even in a hard-to-see locations, while preventing piping errors when reconnecting.

Built-in One-touch fittings

Applicable to nylon, soft nylon, and polyurethane tubes.

Saves installation time

Unlike the use of multiple bulkhead unions for panel, Series DMK with built-in One-touch fittings significantly reduces the piping time.

Secure tube connection

Tubes are easily and securely connected to the multi-connector with built-in One-touch fittings.

No. of connecting tubes:

2 types of multi-connectors are available: 6 tubes and 12 tubes.

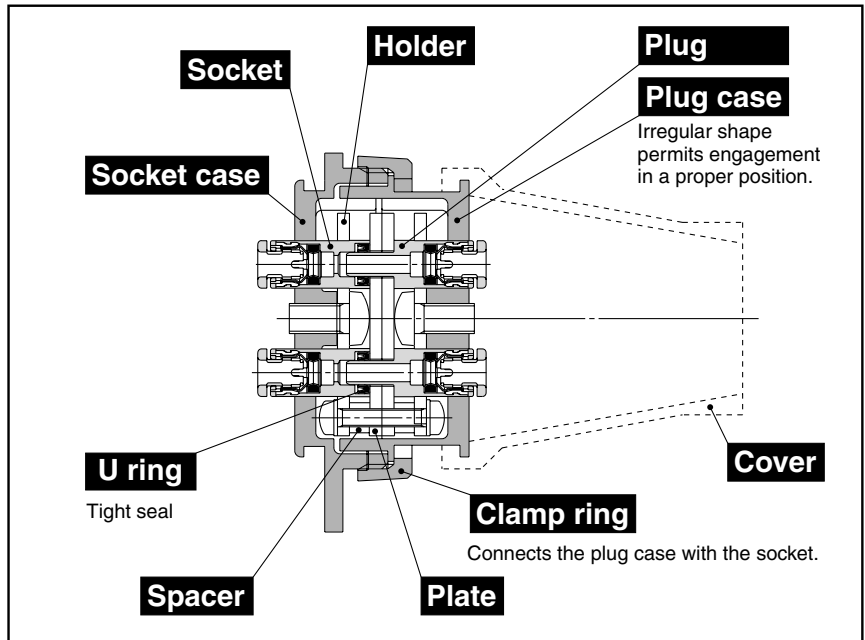

Model

No. of connecting tubes	Model			Cover part no. (Option)
	Multi-connector	Plug side only	Socket side only	
6	DMK6-23	DMK6P-23	DMK6S-23	DMK-C-6
	DMK6-04	DMK6P-04	DMK6S-04	
12	DMK12-23	DMK12P-23	DMK12S-23	DMK-C-12
	DMK12-04	DMK12P-04	DMK12S-04	

Specifications

Applicable tubing materials	Nylon, Soft nylon, Polyurethane
Applicable tubing O.D. (mm)	3.2, 4
Fluid	Air
Maximum operating pressure	1.0 MPa
Ambient and fluid temperature	-5 to 60°C (With no condensation)

Principal Parts Material

	DMK6	DMK12
Socket case	ADC12, White half-polished finish	
Plug case		
Clamp ring		
Plate	SPCC, Chromated	
Holder	SPCC, Zinc chromated	A5052, Hard anodized
Socket	C3604BD Electroless nickel plated, POM, Stainless steel 304	
Plug		
U ring	NBR	
Cover	Silicon rubber	
Round head phillips screw	SWRM, Nickel plated	
Round head phillips screw with flat washer	SWRM, Zinc chromated	
Spacer	SPC, Zinc chromated	

How to Order

DMK		6		04	
Number of connecting tubes		6	6		
		12	12		
Style		Nil	Multi-connector		
		P	Plug side only		
		S	Socket side only		
Accessory (Option)		Nil	None		
		C1	Cover single side 1 pc.		
		C2	Cover both sides 2 pcs.		
Tubing O.D.		23	3.2 mm		
		04	4 mm		

Dimensions

DMK6

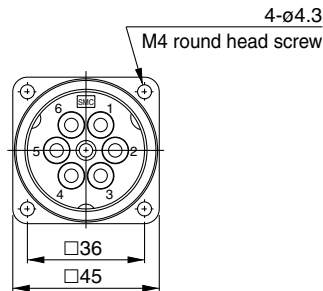
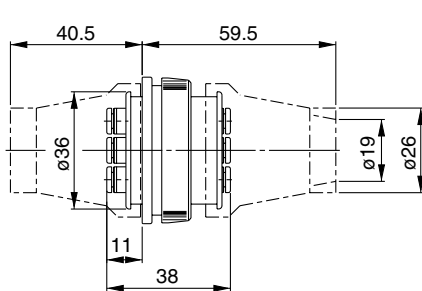
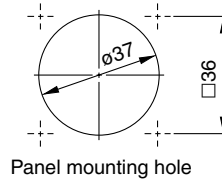
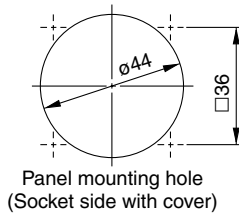

DMK12

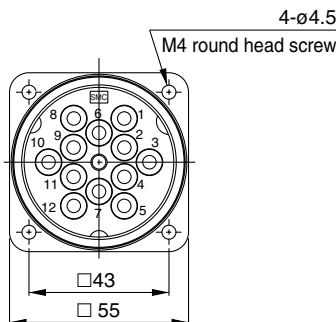
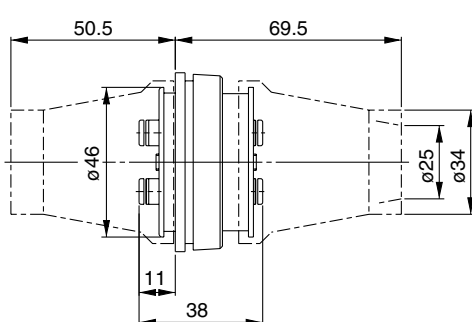
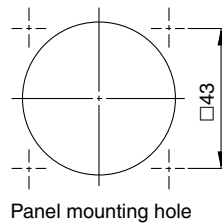
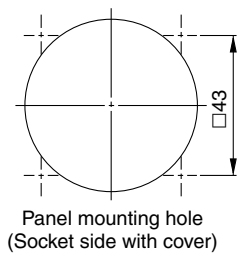

⚠ Precautions

Be sure to read before handling.
Please consult with SMC when the required specification is out of range.

How to Use

⚠ Caution

Disassembly

- (1) Loosen clamp ring (A) and disassemble the connector into the plug case and socket case.

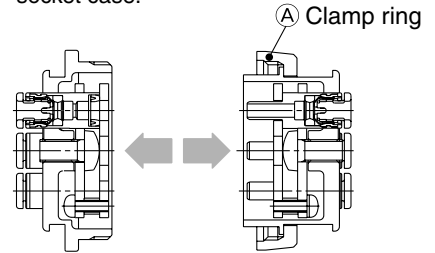

Connection

- (1) Turn the cases while pressing them against each other until the plug case slides into the socket case at a proper position.
- (2) Align at mark (B) of the plug and socket cases and turn them against each other to connect the two cases.
- (3) Screw in the clamp ring to complete the connection.

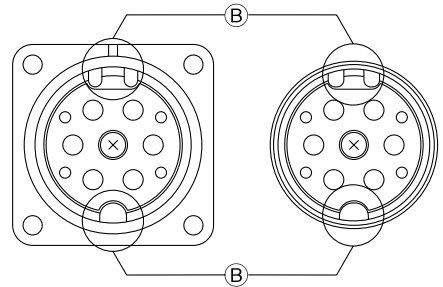

Installation of cover

- (1) The cover can be installed on both the plug case or socket case.
- (2) Stretch the cover to install on the cover installation latch.

