



The Timken Company

4500 Mt Pleasant St. NW

N. Canton, OH 44720

Phone: (234) 262-3000

E-Mail: CustomerCAD@timken.com • **Web site:** www.timken.com

Bearing Unit - Adapter Sleeve UKF211 - H2311, UKF 200 Four-Bolt Flanged Mounted Bearings - Adapter Sleeve Locking

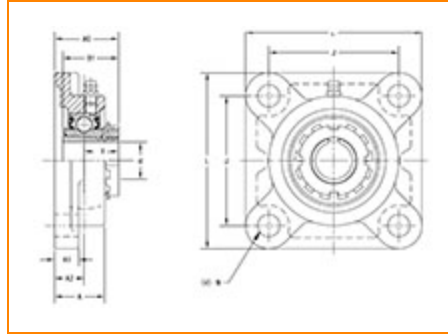

[Specifications](#) | [Dimensions](#) | [Basic Load Ratings](#)

Specifications

Bearing Unit - Adapter Sleeve	UK211 - H2311
Shaft Size d	50 mm
Adapter Sleeve Number¹	H2311
Locking Style	Adapter Sleeve Locking
Housing Construction	Four-Bolt Square Flange

Dimensions

Total Length L	162 mm 6.378 in
 Housing Width A	43 mm 1.693 in

Bolt Hole Spacing J	130 mm 5.118 in
Bolt Hole Size N	19 mm 0.748 in
Flange Thickness A1	18 mm 0.709 in
Center of Bearing from Housing End A2	25 mm 0.984 in
Center of Bearing from Bearing End Y	32 mm 1.260 in
Dimension B1	59 mm 2.323 in
Dimension A0	57.5 mm 2.25 in
Grease Nipple Size	A-R1/8

Basic Load Ratings

Static Load Rating	29400 N 6609 lbf
Dynamic Load Rating	43400 N 9757 lbf

¹ Purchase the Adapter Sleeve separately

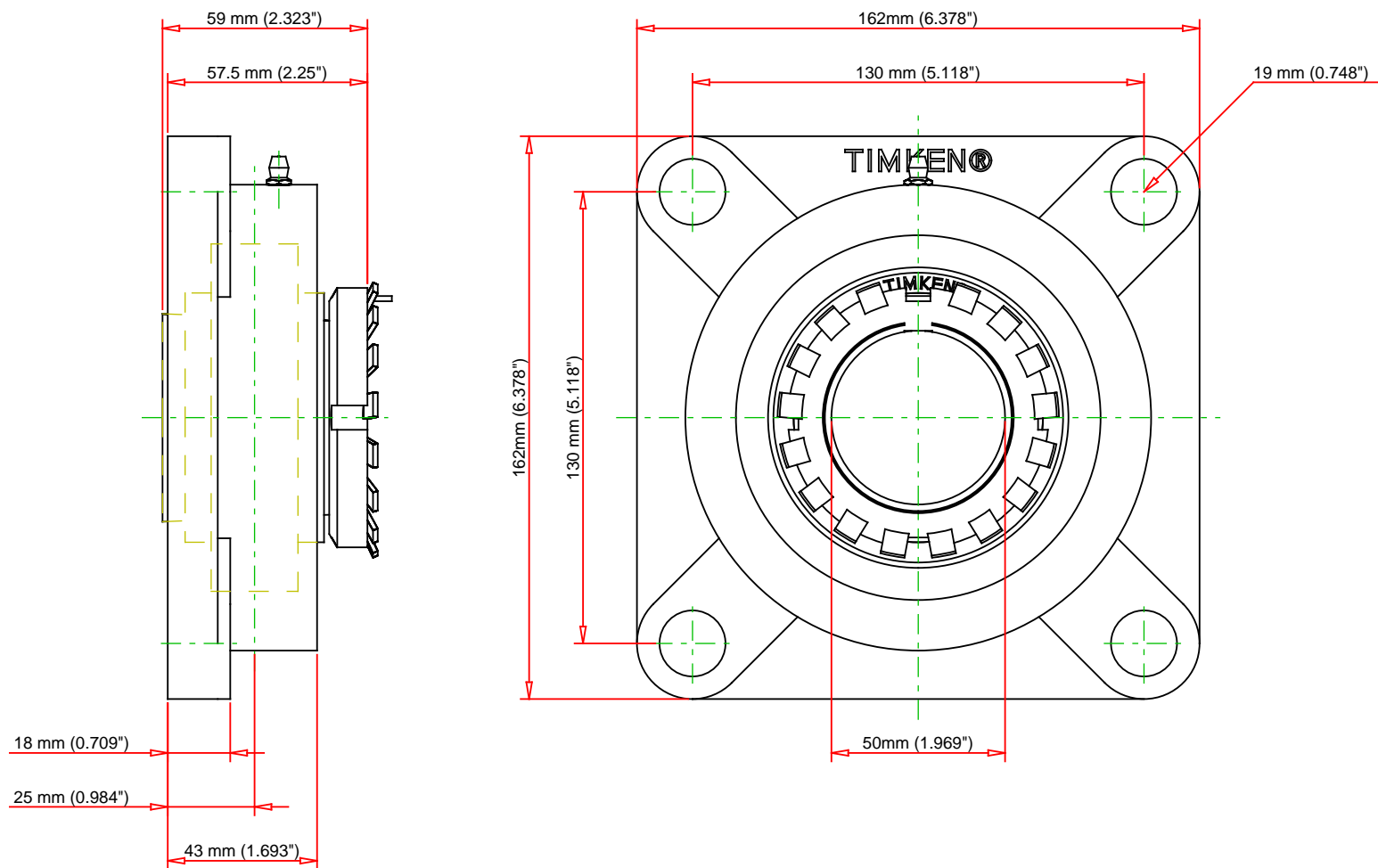

Note: Adapter sold separately

	Bearing Number	UK211 - H2311				UKF211 - H2311 UKF 200 Four-Bolt Flanged Mounted Bearings - Adapter Sleeve Locking	
	Load Ratings - C _r	9757	lbf	43400			N
	Load Ratings - C _{0r}	6609	lbf	29400			N
	Weight	7.7	lb	3.5	kg	THE TIMKEN COMPANY NORTH CANTON, OHIO USA	
Every reasonable effort has been made to ensure the accuracy of the information contained in this writing, but no liability is accepted for errors, omissions or for any other reason.						FOR DISCUSSION ONLY	