

- > Particularly suited for use in high levels of vibration
- > Switch with plug
- > LED indicator as standard



Technical features

Operation:

PNP open collector output with LED (yellow)

Switching voltage (Ub):

10 ... 30 V d.c.

Switching voltage output:

Ub - 2 V

Induced voltage:

2 V

Switching current (see graph):

200 mA max.

Switching power:

6 W max.

Response time:

0,2 ms

Operating frequency:

1 kHz

Protection rating (EN 60529):

IP 66

Operating temperature:

-20 ... +80°C (-4 ... +176°F)

Cable type:

PVC 3 x 0,5

Cable length:

2, 5 and 10 m

Electromagnetic compatibility according to:

EN 60947-5-2

Materials:

Body: plastic

Cable: see table below

Technical data

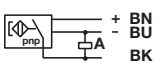
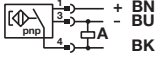
Symbol	Voltage (V d.c.)	Current max. (mA)	Function	Operating temperature (°C)	LED	Protection class	Features	Cable length (m)	Cable type	Weight (g)	Model
	10 ... 30	200	PNP	-20 ... +80	•	IP66	—	2, 5 or 10	PVC 3 x 0,5	102 (2 m)	QM/132/*
	10 ... 30	200	PNP	-20 ... +80	•	IP66	—	5	PUR 3 x 0,34		QM/132/5/PU
	10 ... 30	200	PNP	-20 ... +80	•	IP66	Plug M12 x 1			15	QM/132/P *1)

* Insert cable length

*1) Plug-in connector see page 2

Color code: BK = black, BN = brown, BU = blue

Options selector

QM/132/★★/★★

Cable length/plug	Substitute	Cable	Substitute
2 m	2	PVC	Without
5 m	5	PUR	PU
10 m	10		
M12 x 1	P		

Switching current and switching voltage

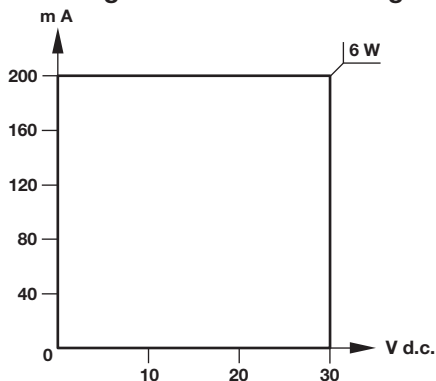

Temperature curve

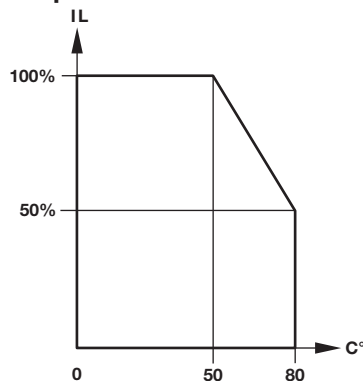

Mounting elements for magnetic switches

Cylinder with external tie rods
RA/8000/M, RA/28000/M



Cylinder with external tie rods
RM/900/M



Mounting elements

Mounting elements



Cylinder Ø (mm)	Model	Cylinder Ø (inch)	Model
32 ... 63	QM/31/032/22	1 1/4"	QM/31/032/22
80 ... 125	QM/31/080/22	1 3/4" + 2"	QM/31/080/22
160 + 200	QM/31/160/22	2 1/2" ... 4"	QM/31/2/22
250	QM/31/250/22		
320	QM/31/320/22		

Dimensions see relevant cylinder sheets.

Accessories

Plug-in connector cable with nut



Outer cover	Cable length	Weight (kg)	Connector	Model
PVC 3 x 0,34	5 m	0,182	M12 x 1	M/P34692/5
PUR 3 x 0,34	5 m	0,182	M12 x 1	M/P34594/5

Dimensions QM/132

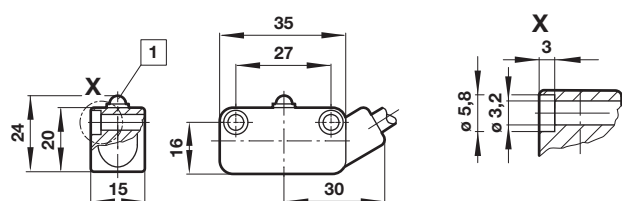

QM/132/P

Dimensions in mm
Projection/First angle

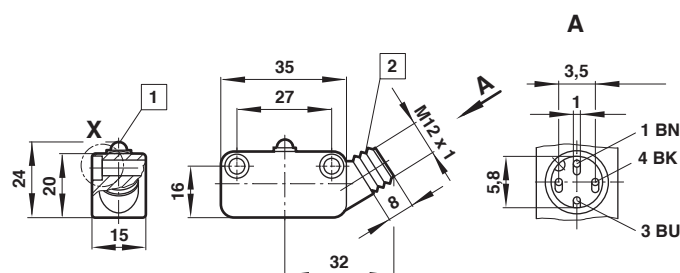

- 1 LED (yellow)
2 Plug M12 x 1
Color code: BK = black, BN = brown, BU = blue

Warning

These products are intended for use in industrial systems only. Do not use these products where values can exceed those listed under »Technical features/data«.

Before using these products with non-industrial applications, life-support systems, or other applications not within published specifications, consult NORGREN.

Through misuse, age, or malfunction, components used in fluid power systems can fail in various modes.

The system designer is warned to consider the failure modes of all component parts used in control systems and to provide adequate safeguards to prevent personal injury or damage to equipment in the event of such failure.

System designers must provide a warning to end users in the system instructional manual if protection against a failure mode cannot be adequately provided.

System designers and end users are cautioned to review specific warnings found in instruction sheets packed and shipped with these products.