**FAG****2218-TVH-C3** [🔗](#)

Self-aligning ball bearing

Self-aligning ball bearing 22...TVH, plastic cage

Technical information

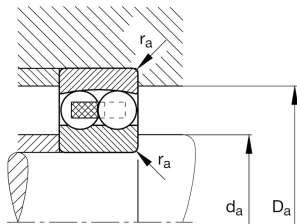
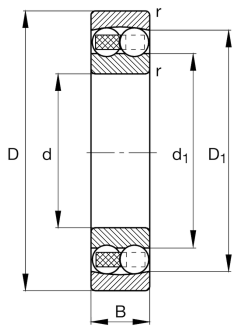

Your current product variant

Bore type	Z	Cylindrical
Sealing	Without	Not sealed
Cage	TVH	Solid cage made of glass-fiber reinforced polyamid PA66
Tolerance class	PN	Normal (PN)
Lubricant	Without	Bearing not greased
Radial internal clearance	C3 (Group 3)	Internal clearance larger than CN

Main Dimensions & Performance Data

d	90 mm	Bore diameter
D	160 mm	Outside diameter
B	40 mm	Width
C _r	71,000 N	Basic dynamic load rating, radial
C _{0r}	28,500 N	Basic static load rating, radial
C _{ur}	1,630 N	Fatigue load limit, radial
n _G	4,400 1/min	Limiting speed
n _{gr}	5,200 1/min	Reference speed
≈m	3.151 kg	Weight

Mounting dimensions

d _{a min}	101 mm	Minimum diameter shaft shoulder
D _{a max}	149 mm	Maximum diameter of housing shoulder
r _{a max}	2 mm	Maximum fillet radius



Dimensions

r_{min}	2 mm	Minimum chamfer dimension
D_1	139.35 mm	Shoulder diameter outer ring
d_1	111.5 mm	Shoulder diameter inner ring









Temperature range

T_{min}	-30 °C	Operating temperature min.
T_{max}	120 °C	Operating temperature max.

Calculation factors

e	0.27	Limiting value of F_a/F_r for the applicability of diff. Values of factors X and Y
Y_1	2.33	Dynamic axial load factor
Y_2	3.61	Dynamic axial load factor
Y_0	2.45	Static axial load factor

Characteristics

-  Radial load
-  Axial load in one direction
-  Axial load in two directions
-  Grease Lubrication
-  Oil Lubrication
-  Not sealed
-  Static angular error and misalignment
-  Dynamic angular error and misalignment